

NORTHRIDGE PLAZA

120-220 17TH AVE NE, WASECA, MN

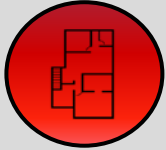

SPACE AVAILABLE



Multiple spaces available
- see site plan

SHOPPING CENTER



44,196 square foot
neighborhood
retail/service center

LOCATION



Located directly off State
Hwy 13 and across from
Waseca High School

TRAFFIC COUNT



9,700/VPD on State Hwy 13



	1 Mile	3 Miles	5 Miles
POPULATION	4,064	10,219	11,072
DAYTIME POP	2,856	9,966	10,385
HOUSEHOLDS	1,726	3,970	4,305
HOUSEHOLD INCOME	78,746	76,480	77,596



Retail Aerial

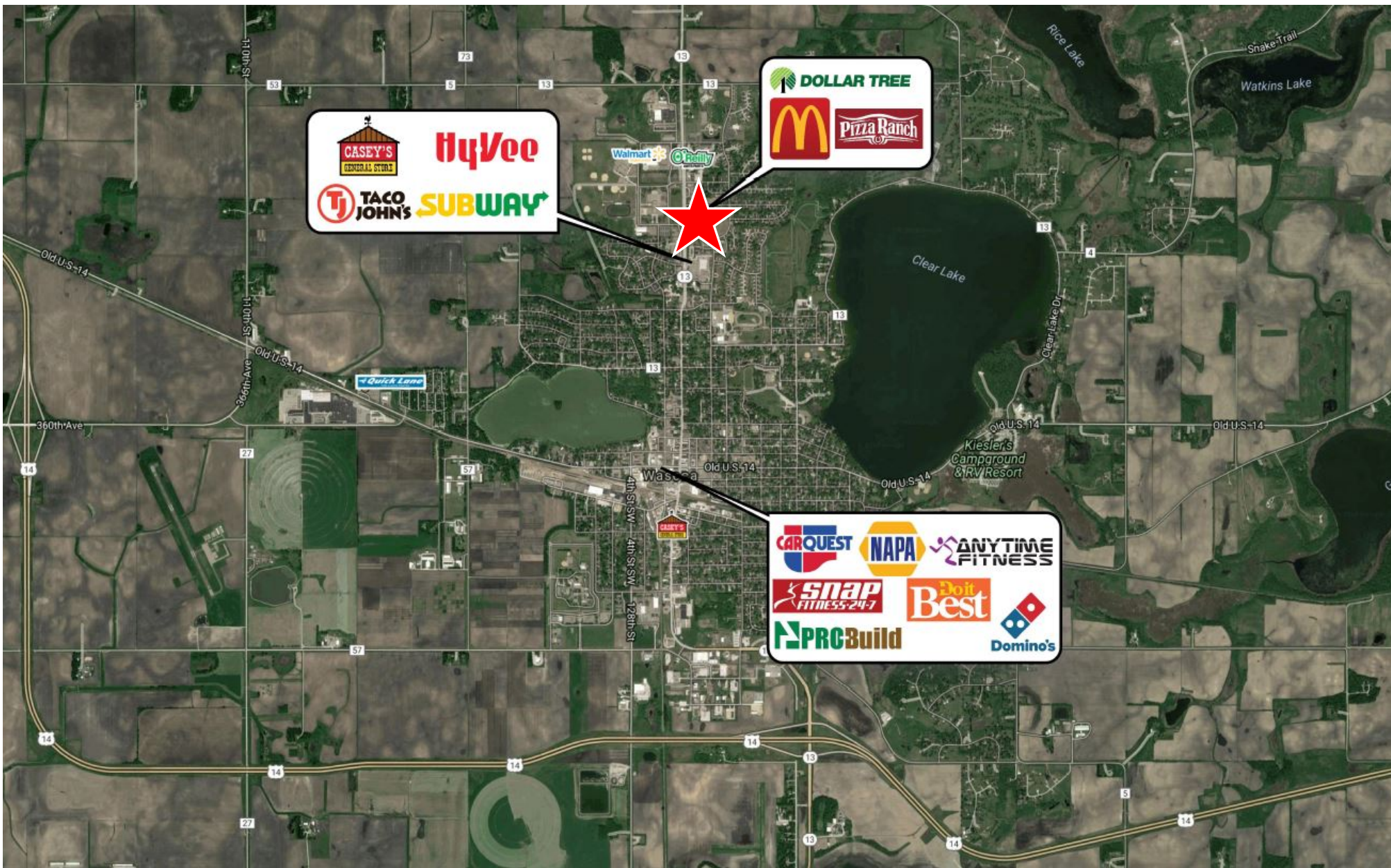

NORTHEDGE PLAZA
WASECA, MN





Aerial View



NORTHRIDGE PLAZA
WASECA, MN



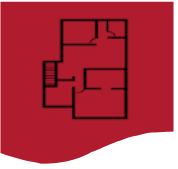

Site Plan

HIGHWAY 13 (9,400/vpd)

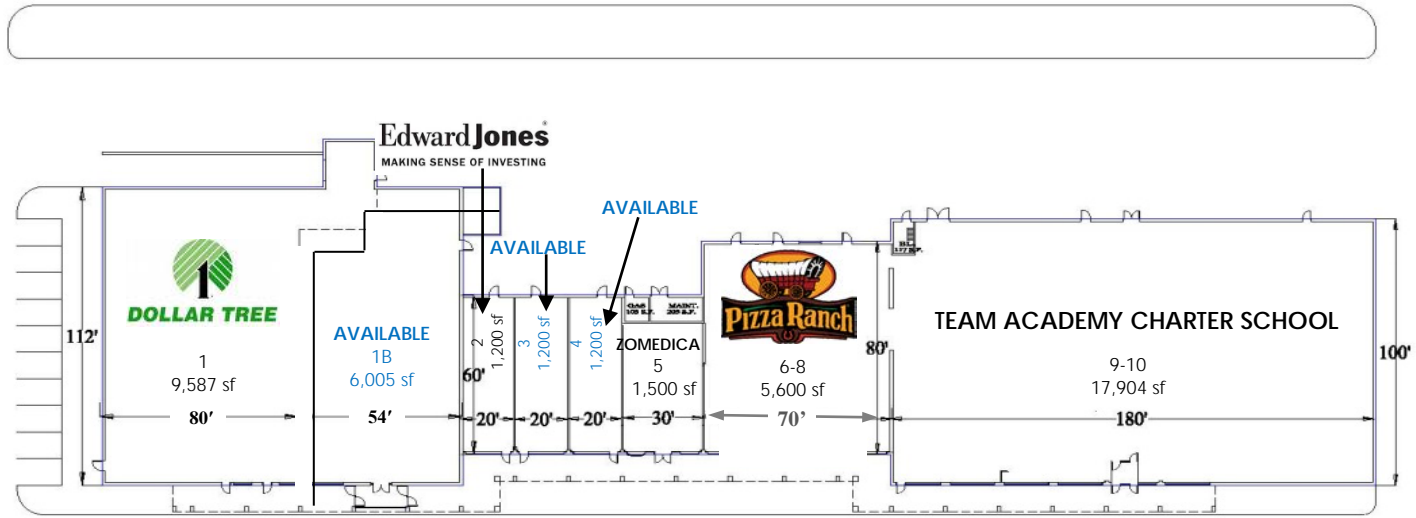

LAND TO BE DEVELOPED

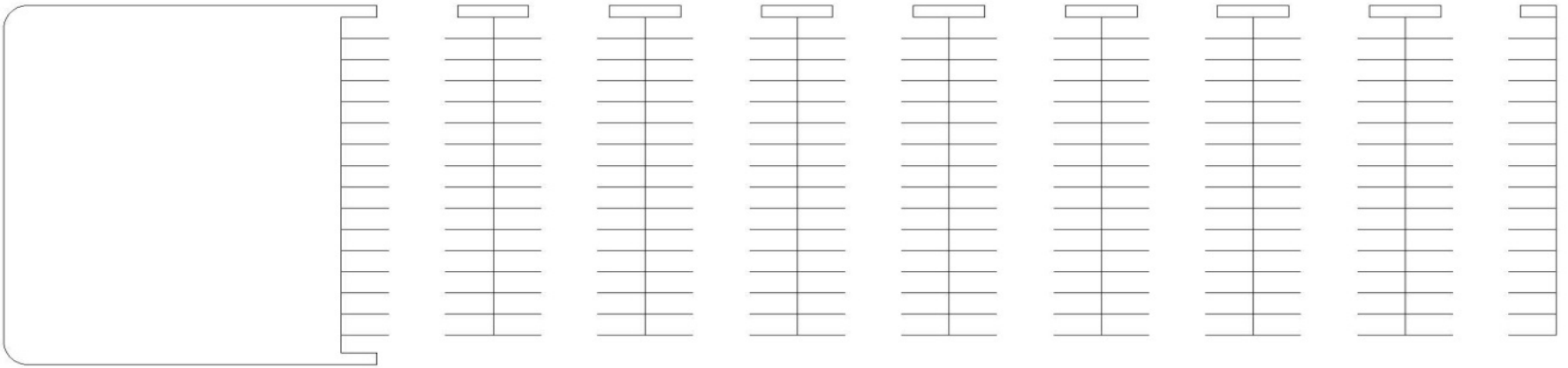

Northridge Plaza

Gross Site Area	413,820 SF
	9.5 Acres
Leaseable Area	44,196 SF
Building Area	44,196 SF
Parking Stalls	253

12/1/23



Contact

Kraus-Anderson

501 South Eighth Street
Minneapolis, MN 55404

www.krausanderson.com

Main 612-332-7281
Fax 952-881-8114



Dan Mossey

O: 612-255-2420

C: 763-438-4751



dan.mossey@krausanderson.com