

FOR LEASE

C100: 15,559 SF

WEST PARK CORPORATE CAMPUS

3402 W VALLEY HWY N | AUBURN, WA



DOCK HIGH WAREHOUSE/OFFICE SPACE

HIGHLIGHTS

- 15,559 SF Total
- 1,177 SF of office
- 2 Dock high doors (1 pit-leveler)
- 1 Grade level (oversized)
- 3-phase power
- 30' clear height
- Excellent office layout
- Sprinklered
- Excellent highway 167 frontage
- Class A image
- Excellent access and proximity to I-5, SR-18 and Hwy-167
- Built in 2000
- **Contact brokers for rates**

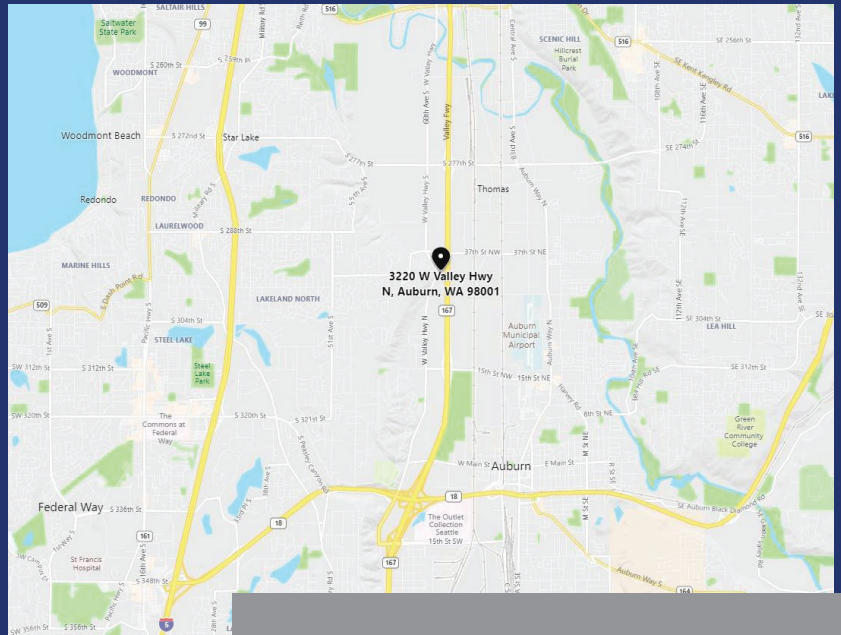

EXCLUSIVELY OFFERED BY:

Arne Svendsen

(206) 947-2885

asvendsen@andoverco.com

West Park Corporate Campus is owned and operated by:



FOR LEASE

C100: 15,559 SF

WEST PARK CORPORATE CAMPUS

3402 W VALLEY HWY N | AUBURN, WA



ADDRESSES

- Building A: 1220 37th St N
- Building B: 3500 W Valley Hwy
- Building C: 3402 W Valley Hwy
- Building D: 3320 W Valley Hwy N

EXCLUSIVELY OFFERED BY:

Arne Svendsen
(206) 947-2885

West Park Corporate Campus is owned and operated by:



FOR LEASE
C100: 15,559 SF

WEST PARK CORPORATE CAMPUS 3402
W VALLEY HWY N | AUBURN, WA

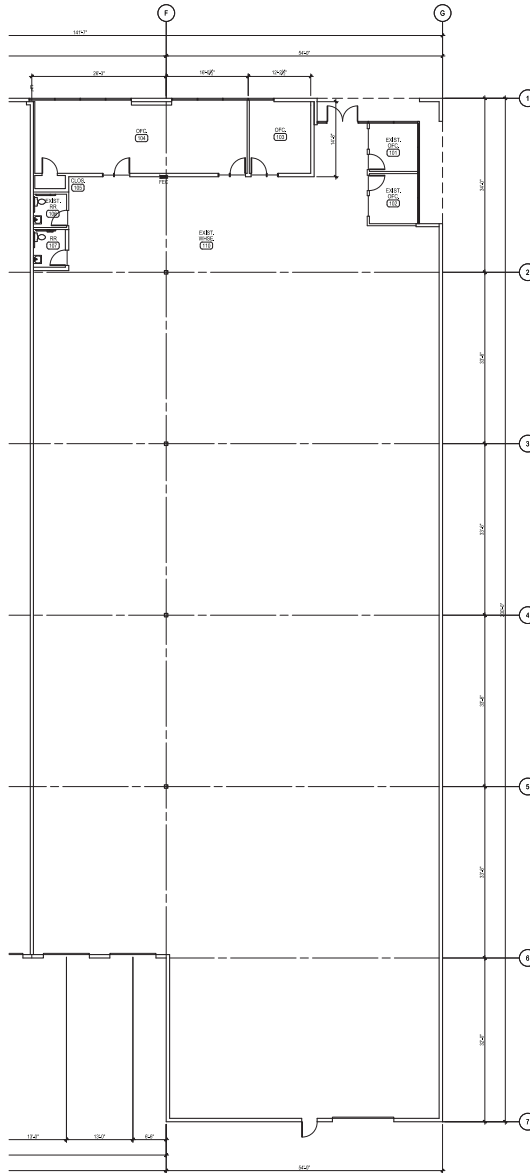

EXCLUSIVELY OFFERED BY:

Arne Svendsen
(206) 947-2885
asvendsen@andoverco.com

West Park Corporate Campus is owned and operated by:

