



Artists Rendering

155 E 55th Street

Located between Third Avenue and Lexington Avenue
Midtown East, NYC

Overview

- 3,000 sf ground floor
- 1,000 sf lower level
- \$19,500 / month
- 26' frontage
- Gas and venting in-place
- White-box condition

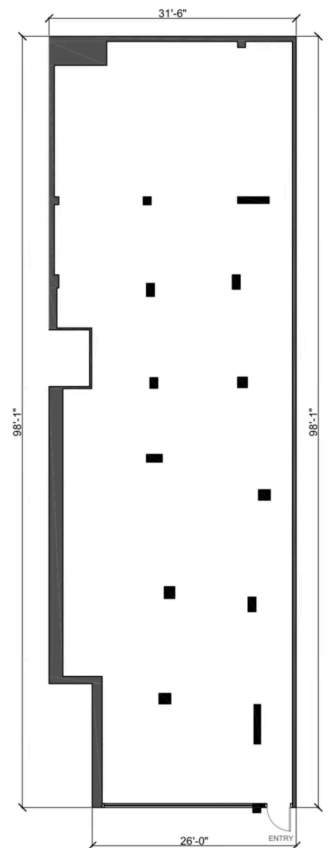

Mark Gindi

347.673.0305 | mark@gindirealtyadvisors.com

GINDI REALTY ADVISORS

All information is sourced from materials deemed reliable; however, no representation or warranty is made as to its accuracy or completeness. All information, including square footage, pricing, availability, and property details, is subject to errors, omissions, change, or withdrawal without notice. Prospective tenants should independently verify all information. Renderings, floor plans, and conceptual images are for illustrative purposes only and may not reflect actual conditions. Gindi Realty Advisors is the exclusive leasing agent for the premises, 230 Fifth Avenue, 11th Floor, New York, NY 10001.