



28,893 SF

HIGH-POWER AVAILABLE

FOR LEASE **AIRPORT TECHNOLOGY PARK**

NEWLY RENOVATED

R&D/MANUFACTURING

420 NORTH 2200 WEST / SALT LAKE CITY, UTAH

FOR MORE INFORMATION, CONTACT:

Jon Schreck

Director
801-303-5531
jon.schreck@cushwake.com

Phillip Eilers

Managing Director
801-303-5426
phillip.eilers@cushwake.com



**CUSHMAN &
WAKEFIELD**

AIRPORT TECHNOLOGY PARK R&D/MANUFACTURING FACILITY

Property Overview

Airport Technology Park, located in Salt Lake City, Utah, is a premier 9-building campus spanning 1.4 million square feet across 78.8 acres adjacent to the Salt Lake City International Airport. The property is primarily leased to L3Harris Technologies and Myriad Genetics for office and R&D use. Since 2012, four built-to-suit expansions have been completed, including a 379,000 sq. ft. addition in 2021 and a new R&D testing facility delivered in 2023. The campus features a highly resilient power infrastructure with dual-grid access, on-site substations, and supplemental generators, offering an estimated 25% cost savings and enhanced reliability.



SUPERIOR ACCESS TO
I-215 via
700 North
Immediate Freeway access
to I-215 and I-80



**NEARBY
TRANSPORTATION**
Trax stop
with direct access to
Salt Lake City
International Airport



Key Features

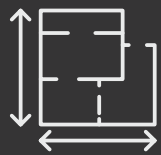

28,893 SF
available



M-1
light industrial zoning

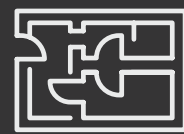

7,576
square foot office



**1600 Amp
480/277 Volt
Service**

- 40'x50' Column Spacing
- One (1) (10'x10') Ground Level Door
- 16' Clear Height
- Excellent access to I-215 and Salt Lake City International Airport
- Close Proximity to the New "Power District" Development

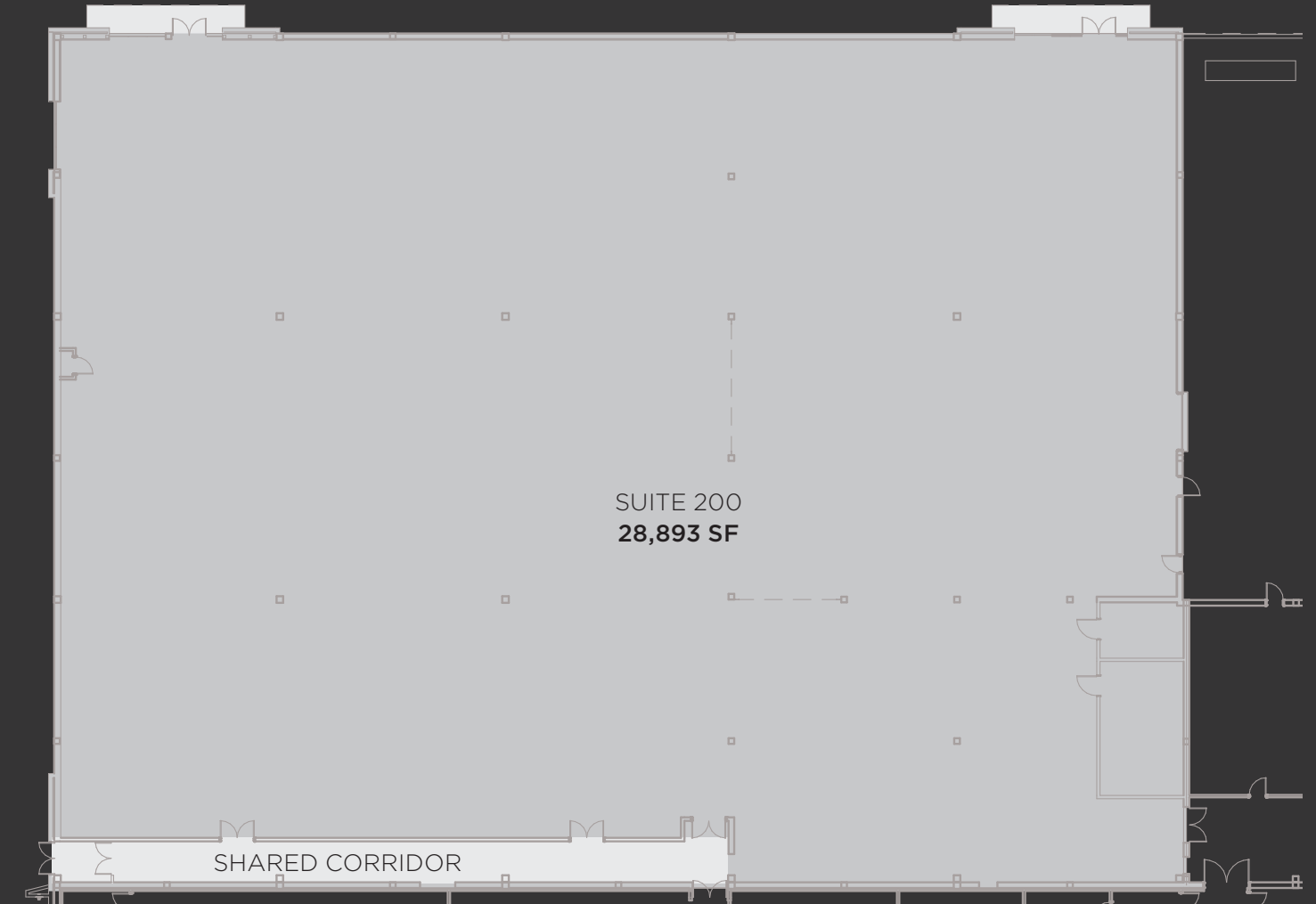

SUITE 200
28,893 SF

SHARED CORRIDOR

AIRPORT TECHNOLOGY PARK SALT LAKE CITY, UT



LONG-TERM, STABILIZED MISSION CRITICAL CORPORATE CAMPUS

- 1,413,235 sq. ft. on 80 acres
- Nine buildings, 1,413,235 square foot office/R&D business park located on 80 acres in Salt Lake City, Utah primarily leased to L3Harris Technologies (NYSE: LLL) and Myriad Genetics (NYSE:MYGN).
- Serves as the division headquarters for L3Harris Technologies, which utilizes the campus to design, manufacture and test the communication equipment for unmanned aircraft and other vehicles, rapidly expanding military and private sector product lines.
- Corporate Headquarters for Myriad Genetics.
- Abundant power with on-site electrical switch and substations that provide redundant power to the campus at an estimated 25% cost savings. The property is served by both the northern and southern power grid, which greatly reduces the risk of outages.



AIRPORT TECHNOLOGY PARK R&D/MANUFACTURING FACILITY



AIRPORT TECHNOLOGY PARK

AIRPORT TECHNOLOGY PARK PROXIMITY TO THE AIRPORT, I-80 & I-15, LITE RAIL, AND DOWNTOWN SALT LAKE CITY.





Drawbridge Realty is a privately held unlevered real estate investment firm partnered with **KKR/Global Atlantic**, specializing in the acquisition, development, and management of mission-critical properties leased to major corporate users. Drawbridge owns and manages a **7 million** square foot portfolio across high-growth, innovation-driven markets in the U.S., including single-tenant office, R&D, life science, and industrial assets leased long-term to creditworthy tenants. Our tenants include industry leaders such as: Anduril, Apple, Arrow Electronics, Aspida, Bank of America, Broadcom, Hewlett Packard, IQVIA, L3Harris Technologies, Merrick & Co., Meta, Myriad Genetics, Northrop Grumman, Onsemi, RBC, SAIC, Take-Two Interactive, Teradyne, Universal Music Group (UMG), Wells Fargo, Uber, and others.

Drawbridge takes an innovative, forward-thinking approach to creating value by offering lease flexibility and unlevered capital delivering real estate solutions for our tenants needs. Our dedicated asset and property management teams work closely with our tenants to support expansion, contraction, renovation, relocation, and sustainability objectives. This stable commitment to our tenants' success is what sets us apart and drives our continuous growth and excellence in the industry.

PORTFOLIO HIGHLIGHTS				
13	51	7 MM	63	\$2.2 Billion
markets	building portfolio	square feet	tenants	AUM

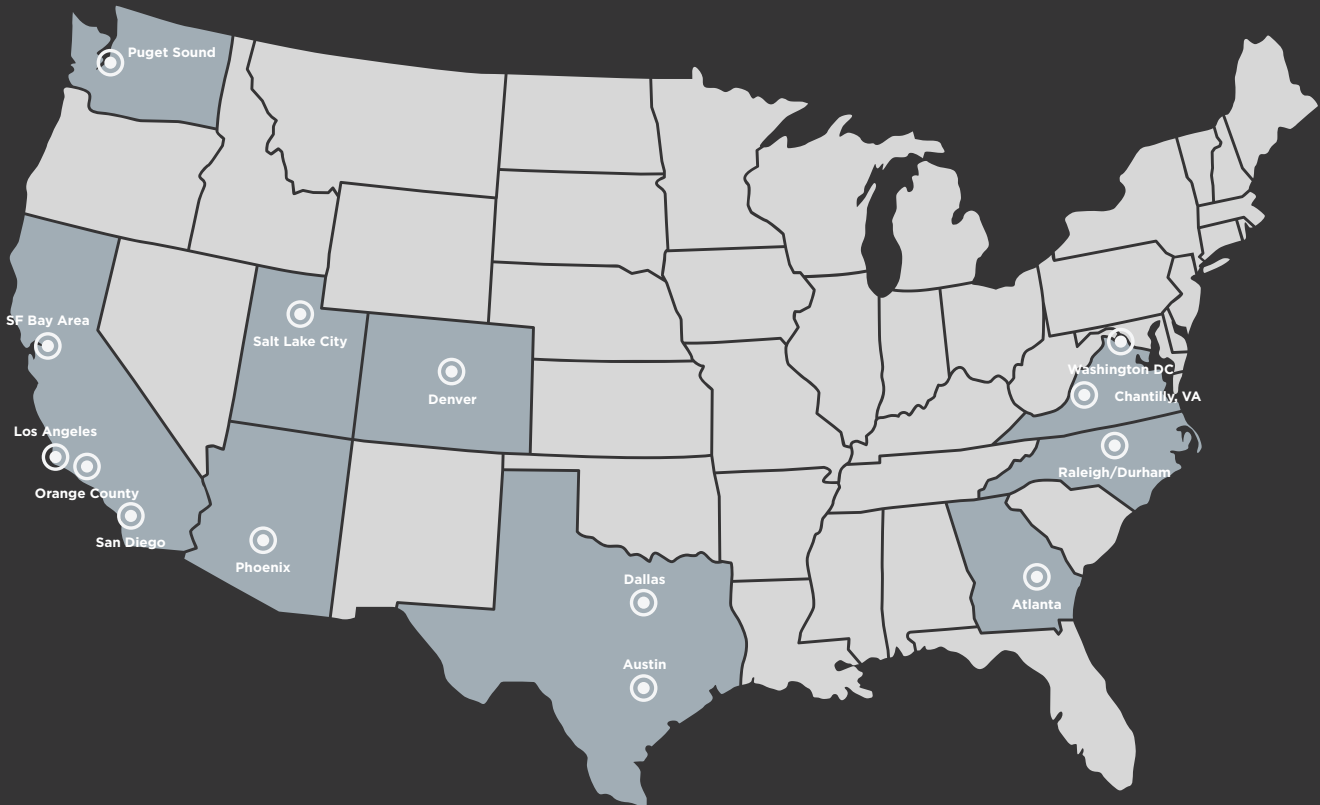

FOR MORE INFORMATION, CONTACT:

Jon Schreck
 Director
 801-303-5531
 jon.schreck@cushwake.com

Phillip Eilers
 Managing Director
 801-303-5426
 phillip.eilers@cushwake.com



170 South Main Street, Suite 1600
 Salt Lake City, UT 84101
 +1 801 322 2000 / cushmanwakefield.com

Cushman & Wakefield Copyright 2025. No warranty or representation, express or implied, is made to the accuracy or completeness of the information contained herein, and same is submitted subject to errors, omissions, change of price, rental or other conditions, withdrawal without notice, and to any special listing conditions imposed by the property owner(s). As applicable, we make no representation as to the condition of the property (or properties) in question.