

FOR LEASE

# LANDMARK COMMERCE CENTER

1300 N Florida Mango Road, West Palm Beach, FL



Suite Number	Square Footage	Lease Rate	OpEx
--------------	----------------	------------	------

Suites 9-10	4,600 SF	\$18.95 NNN	\$6.43 OpEx
-------------	----------	-------------	-------------



Built in 1985



18' Clear Height



±800 SF Office



1 Grade Level Door  
1 Dock High Door



Optional 2,320 SF  
(Suite 3)

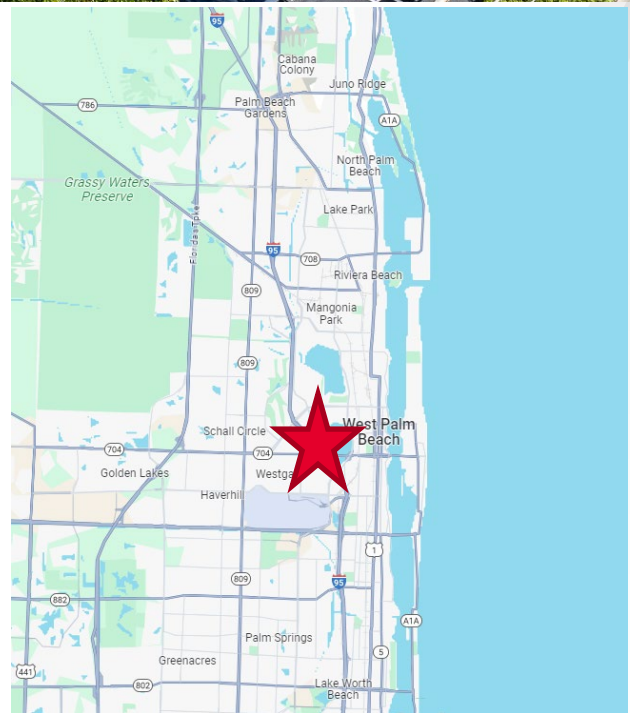

## Contact

Christopher Thomson, SIOR  
Vice Chairman  
+1 561 227 2019  
[Christopher.thomson@cushwake.com](mailto:Christopher.thomson@cushwake.com)

Eric Cantor  
Senior Associate  
+1 561 227 2068  
[Eric.cantor@cushwake.com](mailto:Eric.cantor@cushwake.com)

Juliana Palmisano  
Brokerage Specialist  
+1 561 729 7478  
[Juliana.palmisano@cushwake.com](mailto:Juliana.palmisano@cushwake.com)

FOR LEASE

# LANDMARK COMMERCE CENTER

1300 N Florida Mango Road, West Palm Beach, FL

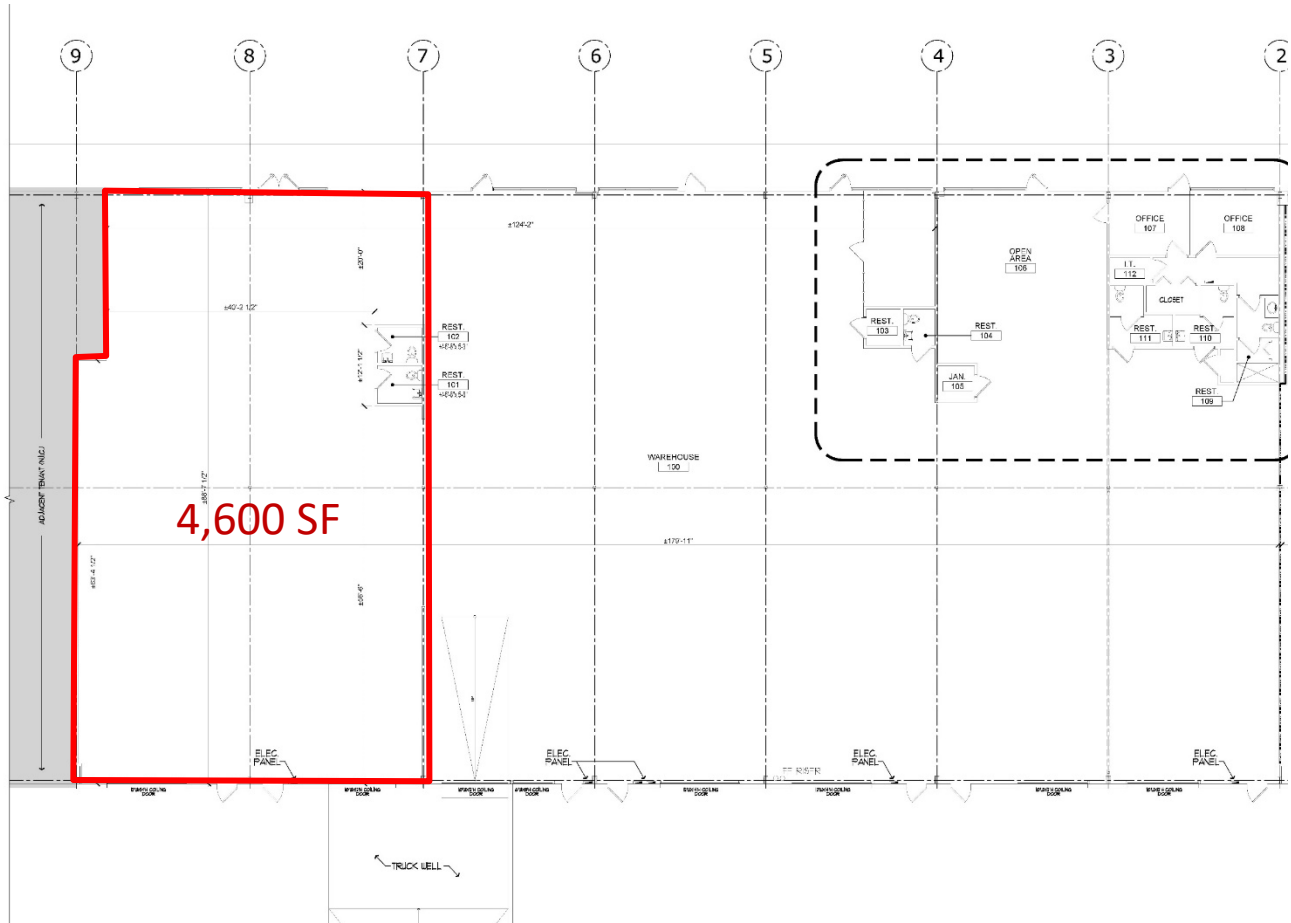

## Contact

Christopher Thomson, SIOR  
Vice Chairman  
+1 561 227 2019  
[Christopher.thomson@cushwake.com](mailto:Christopher.thomson@cushwake.com)

Eric Cantor  
Senior Associate  
+1 561 227 2068  
[Eric.cantor@cushwake.com](mailto:Eric.cantor@cushwake.com)

Owned By:

**ARDEN** | LOGISTICS  
PARKS

Juliana Palmisano  
Brokerage Specialist  
+1 561 729 7478  
[Juliana.palmisano@cushwake.com](mailto:Juliana.palmisano@cushwake.com)