

5910 Taylor Road  
FOR SALE



# PINE RIDGE INDUSTRIAL PARK



ARK PLAZA - A Pine Ridge Industrial Park landmark. Situated on 1.29 acres, ARK Plaza is 2 buildings with ingress/egress and 39 designated parking spaces. Tenant units range from 400 - 2,000 SF.

Tenants are either month-to-month or short term.

Today's set back requirements would not allow the land to property ratio.

## 11,600 & 5,000 SF FREESTANDING BUILDINGS

The statement and figures presented herein, while not guaranteed, are secured from sources we believe authoritative. Subject to prior sale, lease, withdrawal and price change without notice.

Investment Properties Corporation of Naples  
3838 Tamiami Trail North Suite 402  
Naples Florida 34103-3586  
Tel: 239-261-3400 Fax: 249-261-7579 [www.ipcnaples.com](http://www.ipcnaples.com)  
*Licensed Real Estate Broker*

# OFFERING SUMMARY

**PRICE:** \$4,999,000

**BUILDING SIZE:** 16,600 SF total

Building A: 11,600 SF  
6 drive in doors = 12'W X 12' H  
18' center height  
New Roof - 2023  
Niine (9) bathrooms

Building B: 5,000 SF  
5 garage doors = 7'W X 10'H  
13' center height  
New Roof - 2011  
Two (2) bathrooms

**LOT SIZE:** 1.29 acres 56,192 SF

**CONSTRUCTION:** Metal with block firewalls

**ZONING:** Industrial

**FLOOD ZONE:** Front of property - X  
Back of property - AH

**YEAR BUILT:** 1988 & 1974

**RE TAXES (2025):** \$18,532.50

**OTHER:**

- ingress/egress to buildings
- New Roofs - 2023 & 2011
- 39 designated parking spots

# SALES AGENT



**Christine McManus CCIM, SIOR**  
Principal



**FOR MORE INFORMATION:**

**Christine McManus / christine@ipcnaples.com**  
**239-777-2020**

**WWW.IPCNAPLES.COM**

*click here!*





Investment Properties Corporation

# BUILDING PHOTOS & MAPS



Back of front building



North side



South side



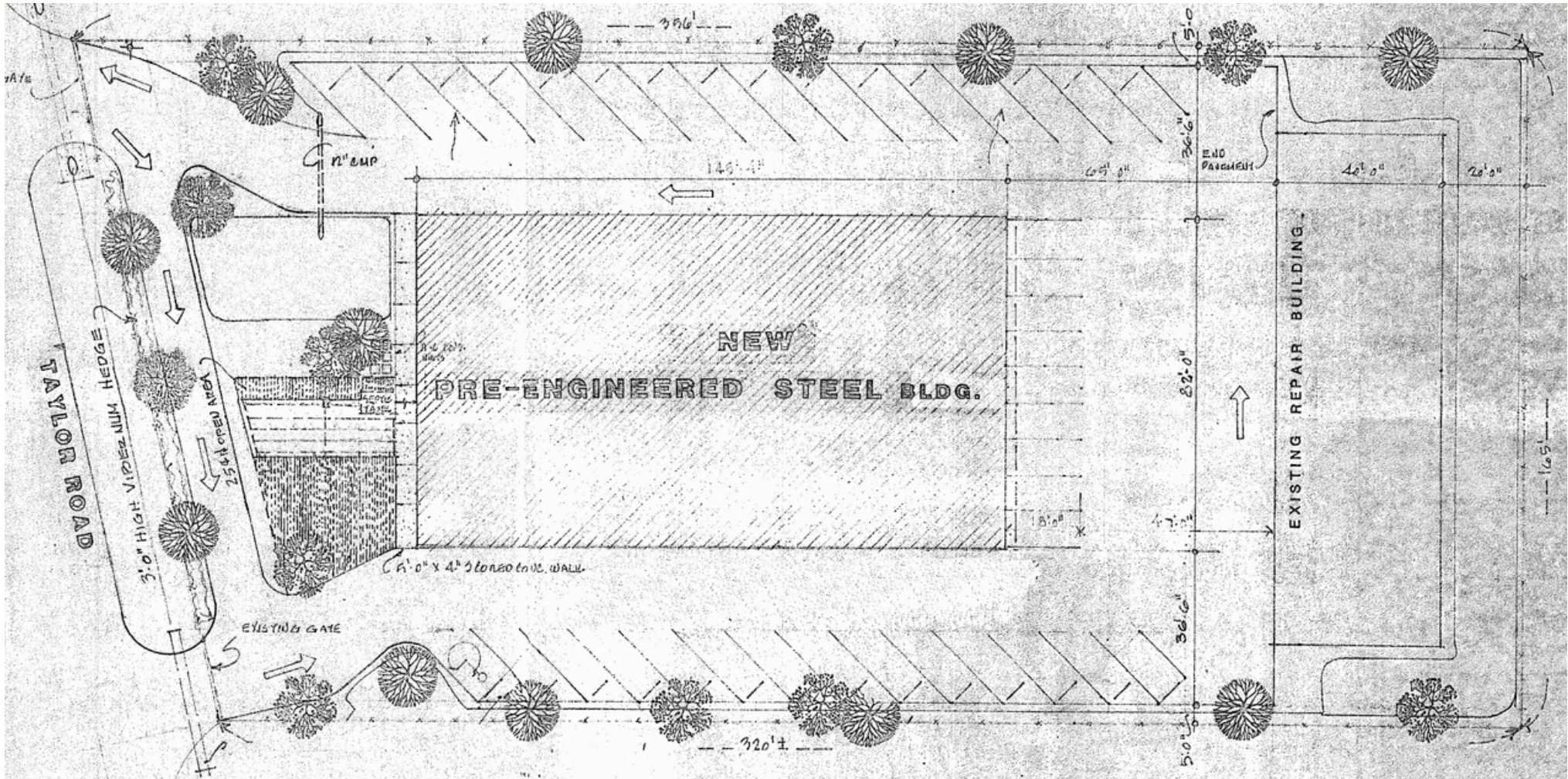

**FOR MORE INFORMATION:**

**Christine McManus / [christine@ipcnaples.com](mailto:christine@ipcnaples.com)**

**239-777-2020**

**[WWW.IPCNAPLES.COM](http://WWW.IPCNAPLES.COM)**