



4,520 SF AVAILABLE

3482 OAKCLIFF ROAD

SUITE B2 | DORAVILLE, GA 30340

OWNED BY:



FOR LEASE



PROPERTY INFORMATION

Total Size:	4,520 SF
Office:	350 SF
Warehouse:	4,170 SF
Loading:	One (1) Dock High Door
Clear Height:	18'
Available:	July 1 st , 2026
Access:	Immediate access to I-85 and I-285

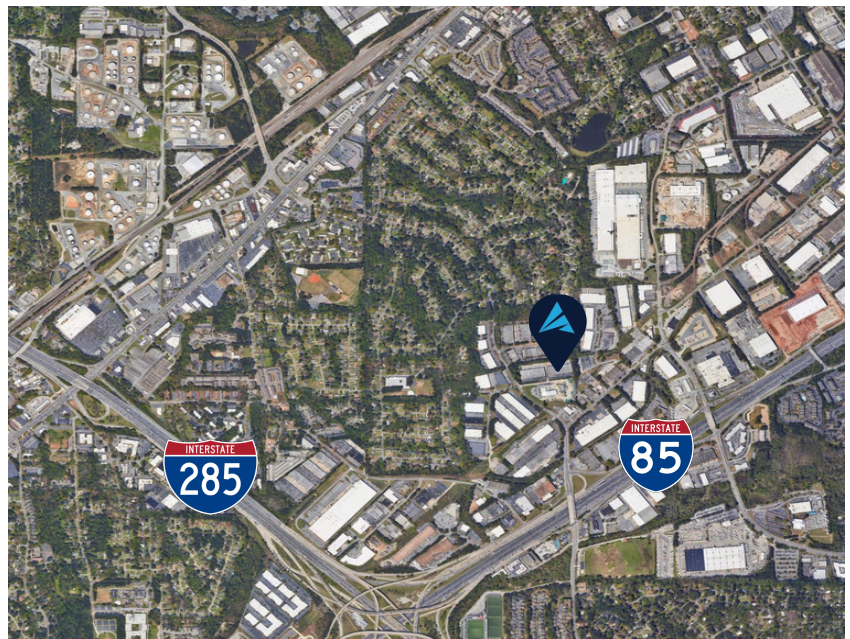

For more information, please contact:

ANDY HEAD

Office: (404) 595 - 1466
Cell: (404) 713 - 4601
ahead@apexindustrialre.com

TREY WEGHORST

Office: (770) 264 - 9420
Cell: (404) 276 - 9314
tweghorst@apexindustrialre.com

MORGAN MCMENAMY

Office: (404) 806 - 6631
Cell: (404) 771 - 1199
mcmcmnamy@apexindustrialre.com



Although the information contained therein was provided from sources believed to be reliable, Apex Industrial makes no representation, expressed or implied, as to its accuracy and said information is subject to errors, omissions or changes.



4,520 SF AVAILABLE

3482 OAKCLIFF ROAD

SUITE B2 | DORAVILLE, GA 30340

OWNED BY:



FLOOR PLAN

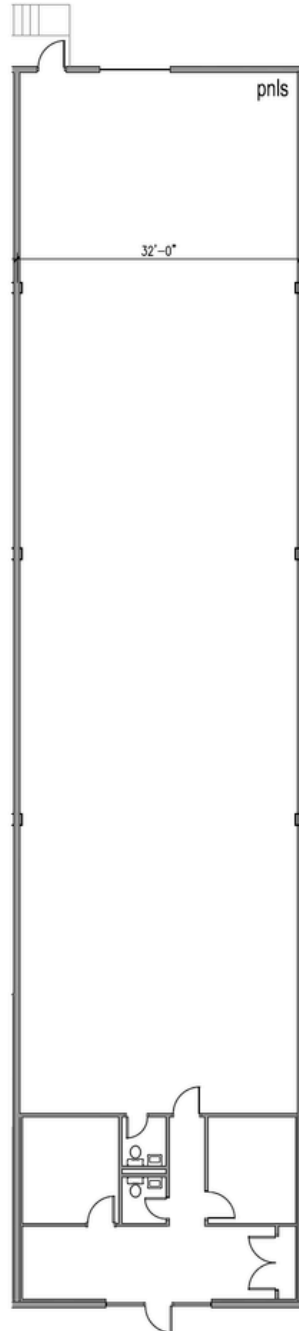

For more information, please contact:

ANDY HEAD

Office: (404) 595 - 1466
Cell: (404) 713 - 4601
ahead@apexindustrialre.com

TREY WEGHORST

Office: (770) 264 - 9420
Cell: (404) 276 - 9314
tweghorst@apexindustrialre.com

MORGAN MCMENAMY

Office: (404) 806 - 6631
Cell: (404) 771 - 1199
mmcmnamy@apexindustrialre.com



Although the information contained therein was provided from sources believed to be reliable, Apex Industrial makes no representation, expressed or implied, as to its accuracy and said information is subject to errors, omissions or changes.