

# OFFICE AND WAREHOUSE SPACE FOR LEASE!

*300 McLaws Circle, Williamsburg, VA*



6 Manhattan Sq., Suite 102  
Hampton, VA 23666  
(757) 865-6600  
FAX- (757) 865-7066



For more information contact:

Craig Read

[fcr@readcompanies.com](mailto:fcr@readcompanies.com)

(757) 865-6600

Disclaimer: This information is obtained from sources deemed to be accurate, but is not warranted. This offer is subject to error, change or withdrawal from prior notice.

- **Office Space**
  - Suite 100B - 2,042 RSF
  - Suite 202 - 2,214 RSF
  - Suite 203 - 2,717 RSF
  - Rent - \$13.50/RSF Full Service
- **Warehouse Space**
  - Suite 109 - 5,892 SF
  - Suite 111 - 6,100 SF (Available 7/1/26)
  - Loading Docks
  - 16'/18' clear ceiling height
  - Rent - \$9.00/SF NNN
  - NNN OPEX (CAM) Estimated at \$1.53/SF (Includes insurance and taxes)
  - 6" thick floor
  - Power 480
- Ample parking.
- Great Williamsburg location near Interstate 64, Busch Gardens, Anheuser Busch brewery, Colonial Williamsburg, and the College of William & Mary.
- Join Sea World/Busch Gardens, Habitat for Humanity, Wagman Heavy Civil, Inc. and others in this beautifully situated industrial facility.

# 300 McLaws Circle – Williamsburg, VA

## Building Availability

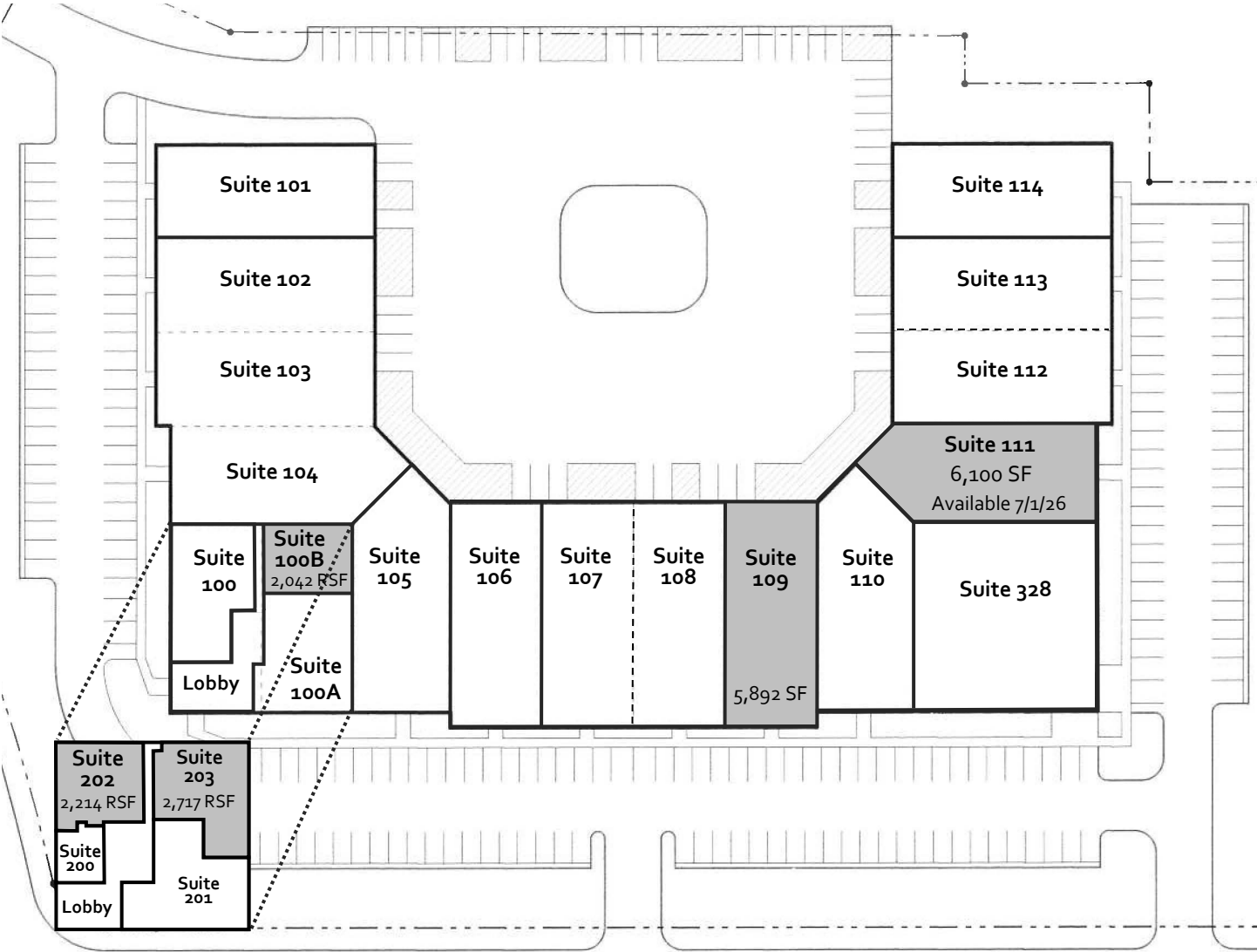

Areas in gray are available for lease.



For more information, contact:

Craig Read

[fcr@readcompanies.com](mailto:fcr@readcompanies.com)

(757) 865-6600

**Disclaimer:** This information is obtained from sources deemed to be reliable but is not warranted. This offer is subject to error, change, withdrawal and prior sale or lease.

# 300 McLaws Circle – Williamsburg, VA

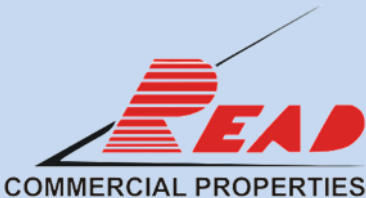

6 Manhattan Square, Suite 102  
Hampton, VA 23666  
(757) 865-6600 Office  
(757) 865-7066 Fax

For more information, contact:

Craig Read  
fcr@readcompanies.com  
(757) 865-6600

**Disclaimer:** This information is obtained from sources deemed to be reliable but is not warranted. This offer is subject to error, change, withdrawal and prior sale or lease.

## Suite 109 As Built Floor Plan - 5,892 SF

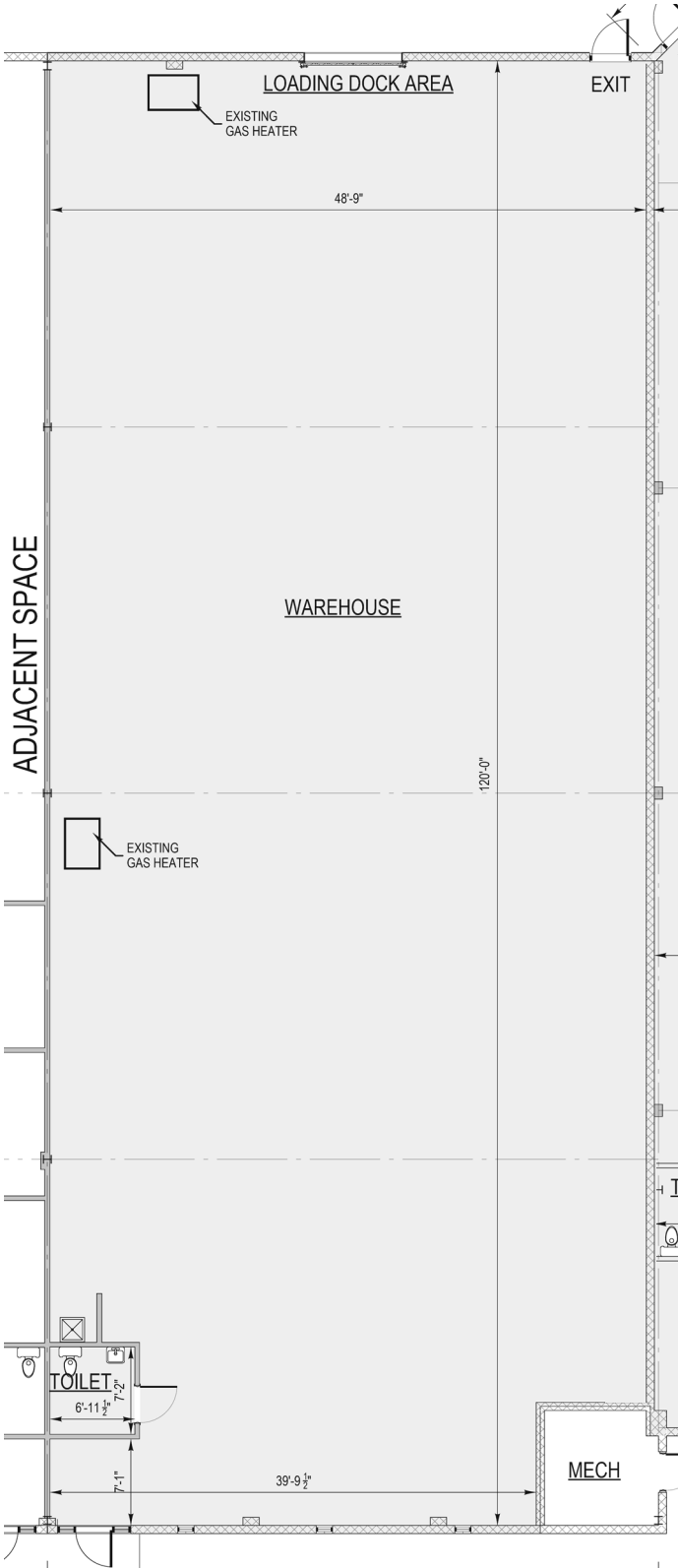

Drawing not to scale

# 300 McLaws Circle – Williamsburg, VA

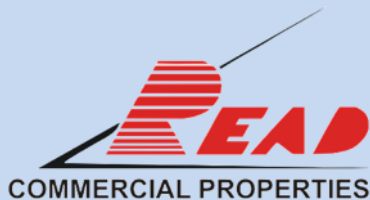

6 Manhattan Square, Suite 102  
Hampton, VA 23666  
(757) 865-6600 Office  
(757) 865-7066 Fax

For more information, contact:  
Craig Read  
fcr@readcompanies.com  
(757) 865-6600

**Disclaimer:** This information is obtained from sources deemed to be reliable but is not warranted. This offer is subject to error, change, withdrawal and prior sale or lease.

## Suite 111 As Built Floor Plan - 6,100 SF

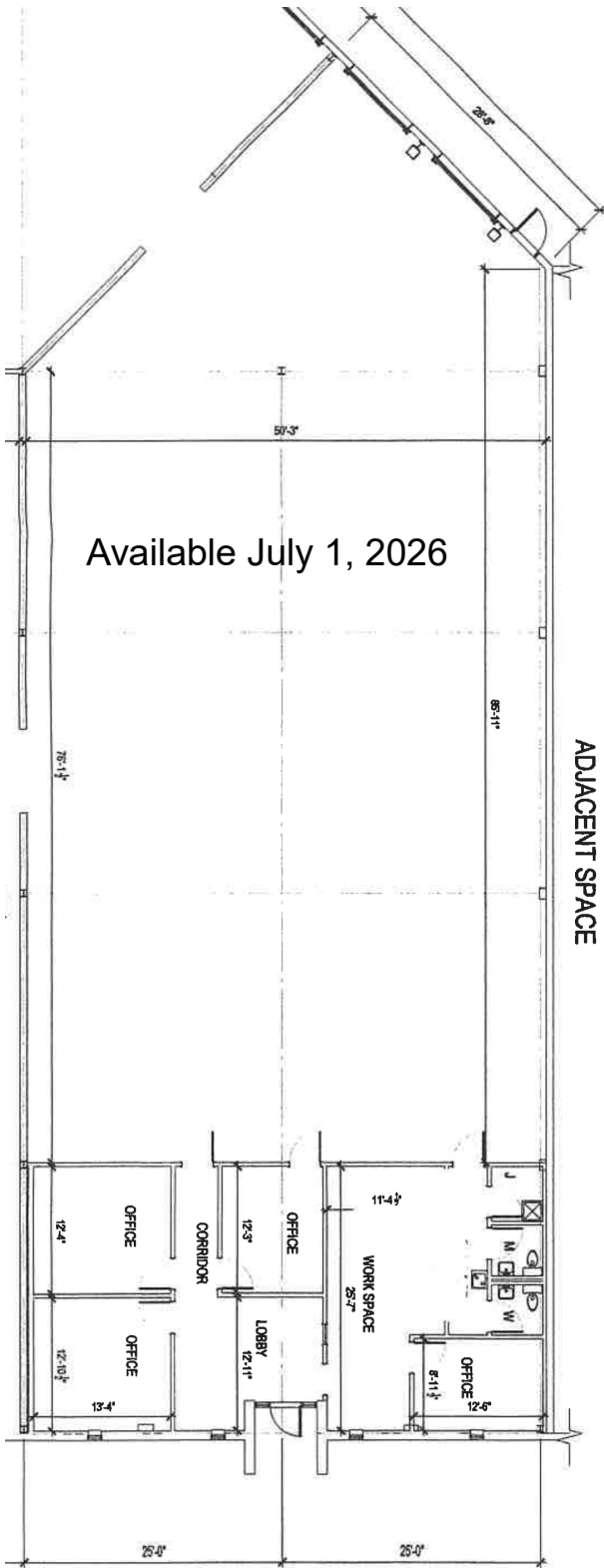

Drawing not to scale



# 300 McLaws Circle – Williamsburg, VA

## Second Floor Offices As Built Floor Plans

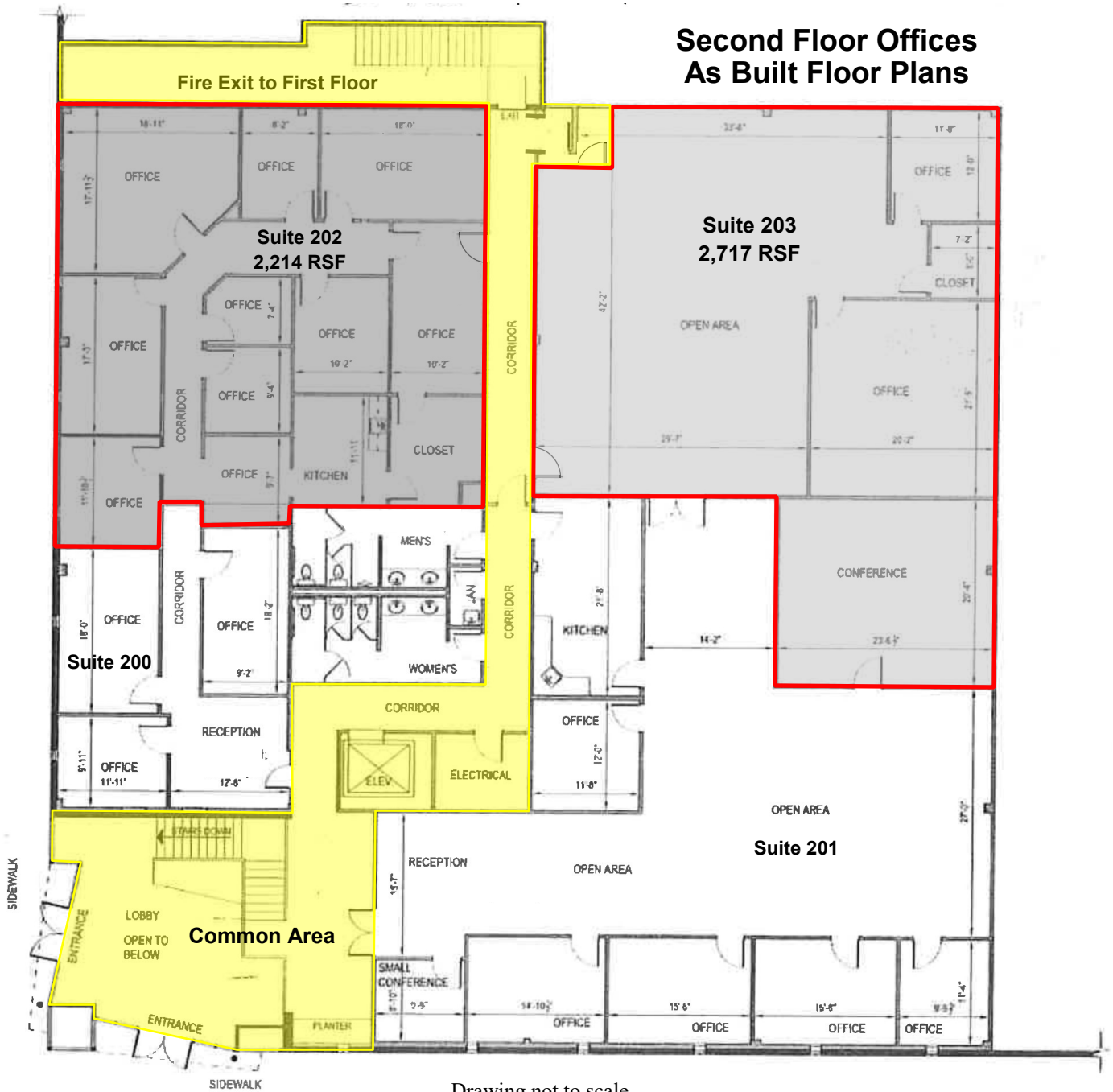

Drawing not to scale



For more information, contact:

Craig Read

[fcr@readcompanies.com](mailto:fcr@readcompanies.com)

(757) 865-6600

**Disclaimer:** This information is obtained from sources deemed to be reliable but is not warranted. This offer is subject to error, change, withdrawal and prior sale or lease.