



# RAVENDALE APARTMENTS SHREVEPORT, CADDO PARISH, LOUISIANA

**M B**  
Miller  
& Associates, LLC  
Civil Engineers & Land Surveyors  
610 Dennis Street, Metairie, LA 70001  
Tel: 318.442.8465

PROJECT NO. 21-81  
DATE: MARCH 2022  
DESIGNED BY: BLM  
CHECKED BY: BLM  
DRAWN BY: BLM  
SCALE: BY: BLM

REVISIONS  
 1. 3-24-2022, REV. 1  
 2. 4-15-2022, REV. 2  
 3. 11-6-2022, REV. 3

SHEET NO.  
**C1**  
 OF NO.  
 21-81

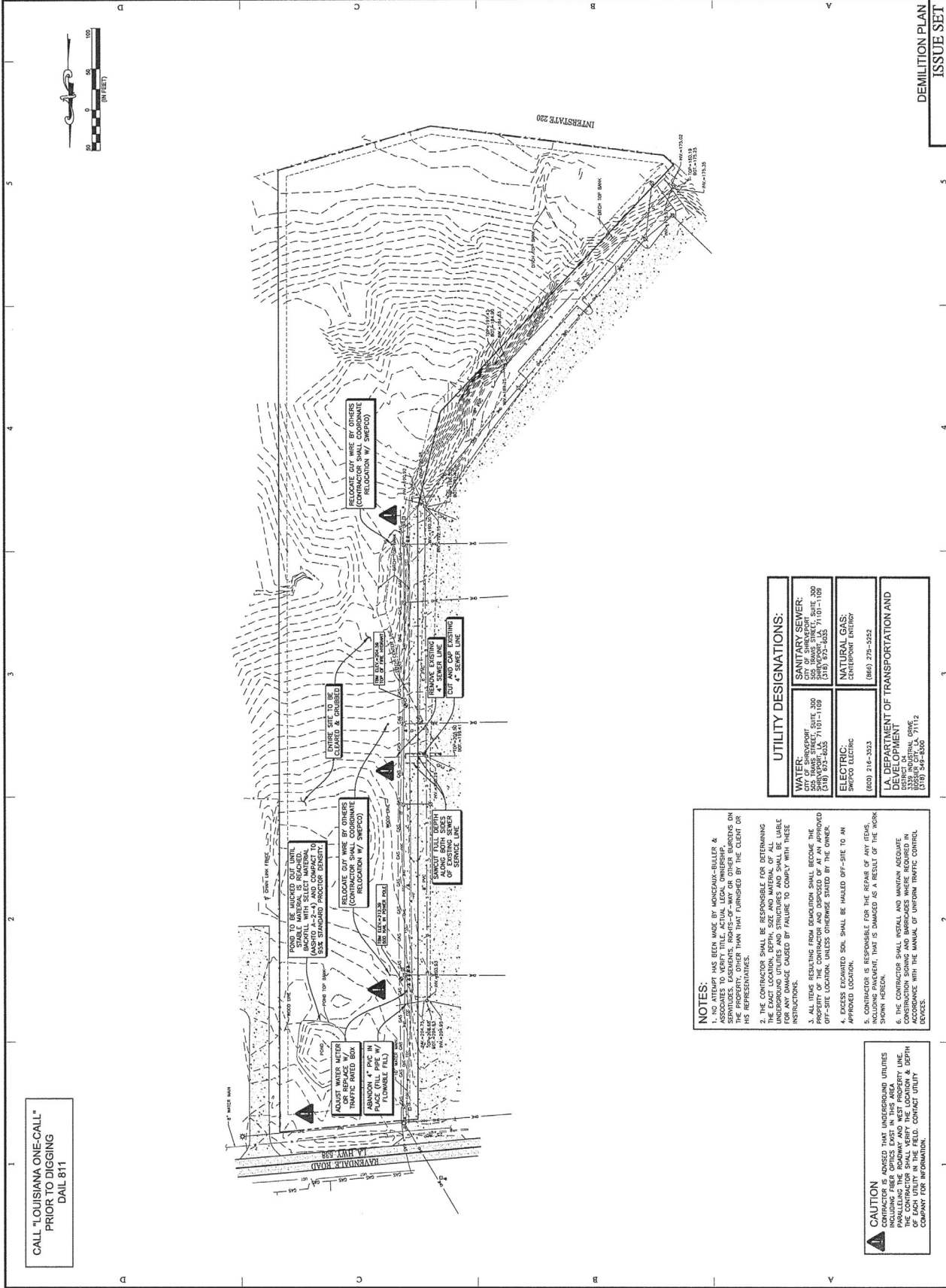

CALL "LOUISIANA ONE-CALL"  
 PRIOR TO DIGGING  
 DIAL 811

- NOTES:**
1. NO ATTEMPT HAS BEEN MADE BY MONCAUX-BELLER & ASSOCIATES, ENGINEERS & LAND SURVEYORS, TO LOCATE OR IDENTIFY ANY UTILITIES, EASEMENTS, RIGHTS-OF-WAY OR OTHER BURDENS ON THE PROPERTY, OTHER THAN THAT FURNISHED BY THE CLIENT OR HIS REPRESENTATIVES.
  2. THE CONTRACTOR SHALL BE RESPONSIBLE FOR DETERMINING THE LOCATION AND DEPTH OF ALL UTILITIES AND STRUCTURES INCLUDING UNDERGROUND UTILITIES AND STRUCTURES AND SHALL BE LIABLE FOR ANY DAMAGE CAUSED BY FAILURE TO COMPLY WITH THESE INSTRUCTIONS.
  3. ALL ITEMS RESULTING FROM DEMOLITION SHALL BECOME THE PROPERTY OF THE CONTRACTOR UNLESS OTHERWISE STATED BY THE OWNER. EXCESS EXCAVATED SOIL SHALL BE HAILED OFF-SITE TO AN APPROVED LOCATION.
  4. CONTRACTOR IS RESPONSIBLE FOR THE REPAIR OF ANY TRENCHES, INCLUDING PAVEMENT, THAT IS DAMAGED AS A RESULT OF THE WORK SHOWN HEREON.
  5. THE CONTRACTOR SHALL INSTALL AND MAINTAIN ADEQUATE CONSTRUCTION SIGNING AND BARRICADES WHERE REQUIRED IN CONFORMANCE WITH THE MANUAL OF UNIFORM TRAFFIC CONTROL DEVICES.

UTILITY DESIGNATIONS:	
<b>WATER:</b> SWEPCO 500 FRANK STREET, SUITE 300 SHREVEPORT, LA 71201-1105 (504) 923-6625	<b>SANITARY SEWER:</b> SWEPCO 500 FRANK STREET, SUITE 300 SHREVEPORT, LA 71201-1105 (504) 923-6625
<b>ELECTRIC:</b> SWEPCO ELECTRIC (800) 216-3553	<b>NATURAL GAS:</b> CENTREPOINT ENERGY (800) 276-5522
<b>LA DEPARTMENT OF TRANSPORTATION AND DEVELOPMENT</b> 3339 INDUSTRIAL DRIVE SHREVEPORT, LA 71112 (504) 949-8500	

**CAUTION**  
 CONTRACTOR IS ADVISED THAT UNDERGROUND UTILITIES PARALLELING THE ROADWAY AND WEST PROPERTY LINE. THE CONTRACTOR SHALL VERIFY THE LOCATION & DEPTH OF ALL UTILITIES PRIOR TO ANY DEMOLITION. CONTACT UTILITY COMPANY FOR INFORMATION.

DEMOLITION PLAN  
 ISSUE SET