

# 9474 KVR



**FOR LEASE**  
Office Space

9474 Kearny Villa Road | San Diego, CA 92126

# Property Description

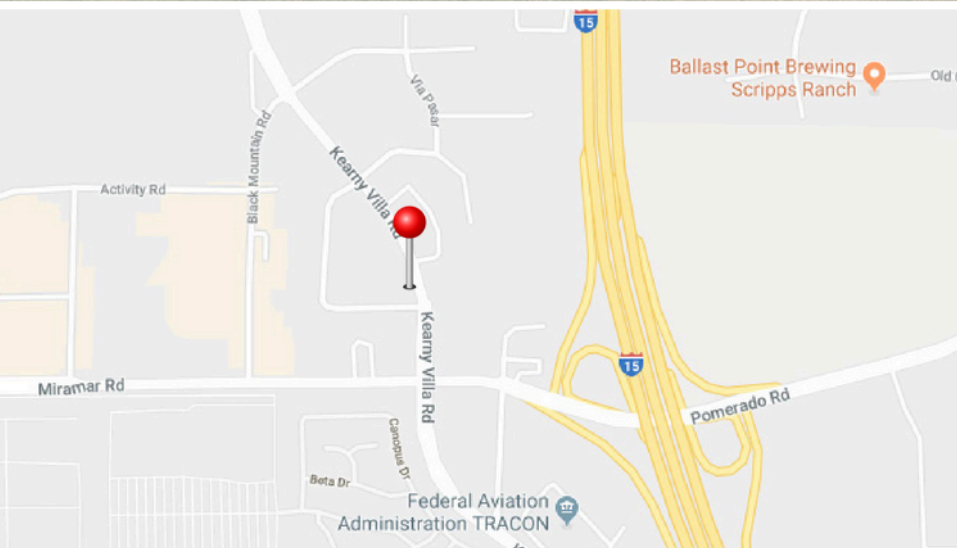

Address

9474 Kearny Villa Road  
San Diego, CA 92126

Building Type

Office Building

Land Area

1.07 AC

Building Size

±17,124 SF

Parking

±3.62/1000 SF

Signage

Building Signage & Monument Signage

Stories

2

Access

Elevator and Multiple Stairways

Freeway Access

2 Blocks from I-15, Excellent FWY  
access

Electric

Separate Electric Meters

Location

The space is very unique offering an extensive glass line with operable windows. The building is centrally located on the corner of Kearny Villa Rd. & Tierra Grande St. one block off Miramar Rd.

# Office Space FOR LEASE

# Suite 215

SUITE 215 | ±1,653 SF



\$3,223 gross / \$1.95/SF

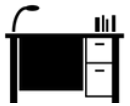

Window Lined Corner Unit.  
Windows are operable.



Available Now

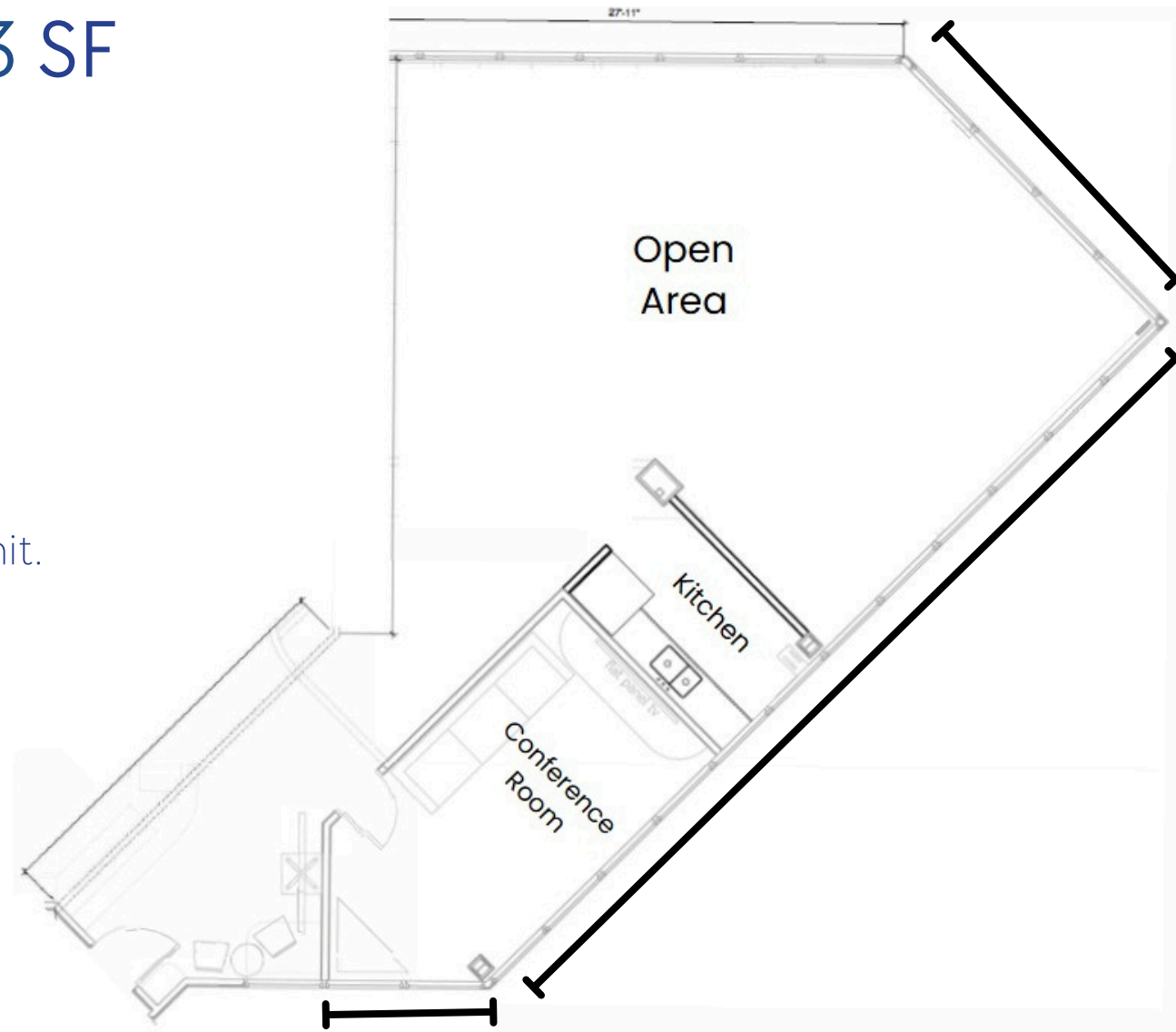

9474  
KVR

FOR MORE  
INFORMATION PLEASE  
CONTACT

--

Mark Silverman

Executive Vice President, SIOR  
619.857.2813  
msilverman@naisandiego.com

**NAI San Diego**

9820 Willow Creek Road, Suite 100  
San Diego, CA 92131 619.497.2255



NO WARRANTY OR REPRESENTATION, EXPRESS OR IMPLIED, IS MADE AS TO THE ACCURACY OF THE INFORMATION CONTAINED HEREIN, AND THE SAME IS SUBMITTED SUBJECT TO ERRORS, OMISSIONS, CHANGE OF PRICE, RENTAL OR OTHER CONDITIONS, PRIOR SALE, LEASE OR FINANCING, OR WITHDRAWAL WITHOUT NOTICE, AND OF ANY SPECIAL LISTING CONDITIONS IMPOSED BY OUR PRINCIPALS NO WARRANTIES OR REPRESENTATIONS ARE MADE AS TO THE CONDITION OF THE PROPERTY OR ANY HAZARDS CONTAINED THEREIN ARE ANY TO BE IMPLIED.