

# EXECUTIVE MARKET PLACE



FOR MORE INFORMATION, CONTACT DOUG FLICK | 419.724.2222 | DFLICK@EIDIPROPERTIES.COM

- Built in 1986, completely renovated in 2012.
- Located in the heart of Toledo's Westgate Shopping District.
- Nearby retailers include: Costco, Fresh Market, Home Depot, Big Lots, and many more.
- Multiple points of ingress/egress that include 2 traffic lights for convenient access.

## PROPERTY DEMOGRAPHICS

	1 MILE	3 MILE	5 MILE
 POPULATION	11,459	103,036	236,417
 MED. INCOME	\$84,300	\$74,200	\$70,800

## TENANTS INCLUDE

GOODWILL  
UPS STORE  
ZAZA WOOD FIRED PIZZA  
AL SMITH'S PLACE  
THE CASUAL PINT

## BUILDING SIZE:

39,710 SF

## AVAILABLE SPACE:

1,700 SF

\$16/SF NNN

# EXECUTIVE MARKET PLACE

3550 EXECUTIVE PARKWAY TOLEDO, OH 43606

FOR MORE INFORMATION, CONTACT DOUG FLICK | 419.724.2222 | DFLICK@EIDIPROPERTIES.COM



Disclaimer: The site plan shows approximate location, square footage and configuration of the shopping center and adjacent areas, and is only illustrative of the size and relationship of the stores and common areas generally, all of which are subject to change. The showing of any names of tenants, parking spaces, square footage, curb-cuts of traffic controls shall not be deemed to be a representation or warranty that any tenants will be at the shopping center, the square footage is accurate, or that any parking spaces, curb-cuts or traffic controls do or will continue to exist. Moreover, any demographics set forth in this flyer are for illustrative purposes only and shall not be deemed a representation by Landlord or their accuracy.

# EXECUTIVE MARKET PLACE



3550 EXECUTIVE PARKWAY TOLEDO, OH 43606

FOR MORE INFORMATION, CONTACT DOUG FLICK | 419.724.2222 | DFLICK@EIDIPROPERTIES.COM

## 1,700 SF INLINE SPACE



# EXECUTIVE MARKET PLACE



3550 EXECUTIVE PARKWAY TOLEDO, OH 43606

FOR MORE INFORMATION, CONTACT DOUG FLICK | 419.724.2222 | DFLICK@EIDIPROPERTIES.COM

1,700 SF INLINE SPACE

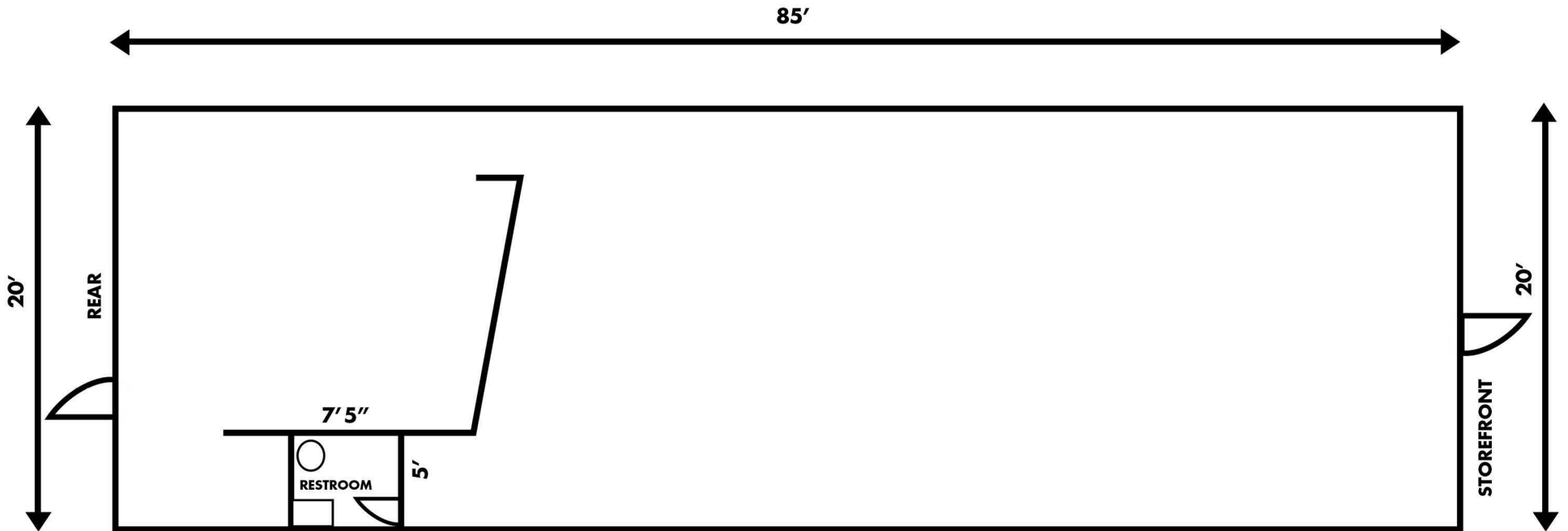

# EXECUTIVE MARKET PLACE



3550 EXECUTIVE PARKWAY TOLEDO, OH 43606

FOR MORE INFORMATION, CONTACT DOUG FLICK | 419.724.2222 | DFLICK@EIDIPROPERTIES.COM

