

INDUSTRIAL PARK ON DURHAM

8100-8198 SW Durham Rd | Tigard, OR 97224

FOR LEASE

AGGRESSIVE RATE



1 MONTH FREE ON 3-YEAR LEASE • 2 MONTHS FREE ON 5-YEAR LEASE



INDUSTRIAL SPACE FOR LEASE

DETAILS

- Suite 8142: ± 1,760 SF \$1.60 PSF, Modified Gross
- Suite 8168: ± 1,800 SF \$1.60 PSF, Modified Gross
- Suite 8172: ± 1,760 SF \$1.60 PSF, Modified Gross
- Suite 8184: ± 3,000 SF \$1.50 PSF, Modified Gross
- Suite 8194: ± 3,000 SF \$1.60 PSF, Modified Gross

FEATURES

- 8 building industrial park
- Warehouse with private offices and upstairs loft
- Oversized grade doors
- Easy access to I-5 and Bridgeport Village

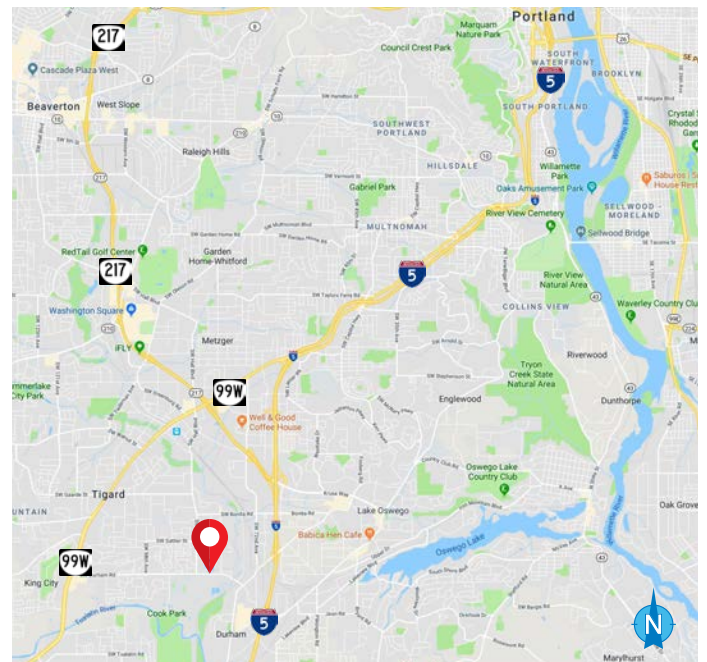

05.04.2026

For more information or a property tour, please contact:

SCOTT FINNEY, SIOR
503.225.8431
ScottF@norris-stevens.com

NICK CHESSAR
503.225.8469
NickC@norris-stevens.com

Norris & Stevens

INVESTMENT REAL ESTATE SERVICES

900 SW 5th Avenue • 17th Floor • Portland, OR 97204
503.223.3171 • norris-stevens.com



Information contained herein has been obtained from others and considered to be reliable; however, a prospective purchaser or lessee is expected to verify all information to their own satisfaction.

INDUSTRIAL PARK ON DURHAM

8100-8198 SW Durham Rd | Tigard, OR 97224

FOR LEASE

SITE PLAN



For more information or a property tour, please contact:

SCOTT FINNEY, SIOR
503.225.8431
ScottF@norris-stevens.com

NICK CHESAR
503.225.8469
NickC@norris-stevens.com

Norris & Stevens

INVESTMENT REAL ESTATE SERVICES



Information contained herein has been obtained from others and considered to be reliable; however, a prospective purchaser or lessee is expected to verify all information to their own satisfaction.

900 SW 5th Avenue • 17th Floor • Portland, OR 97204
503.223.3171 • norris-stevens.com