

CIVIC CENTER PLAZA

1560 BROADWAY, DENVER

SPEC SUITE WITH FURNITURE

Suite 520
3,359 rsf

- 4 offices
- 2 conference rooms
- Open space for 16 6' x 6' workstations
- Breakroom
- IT

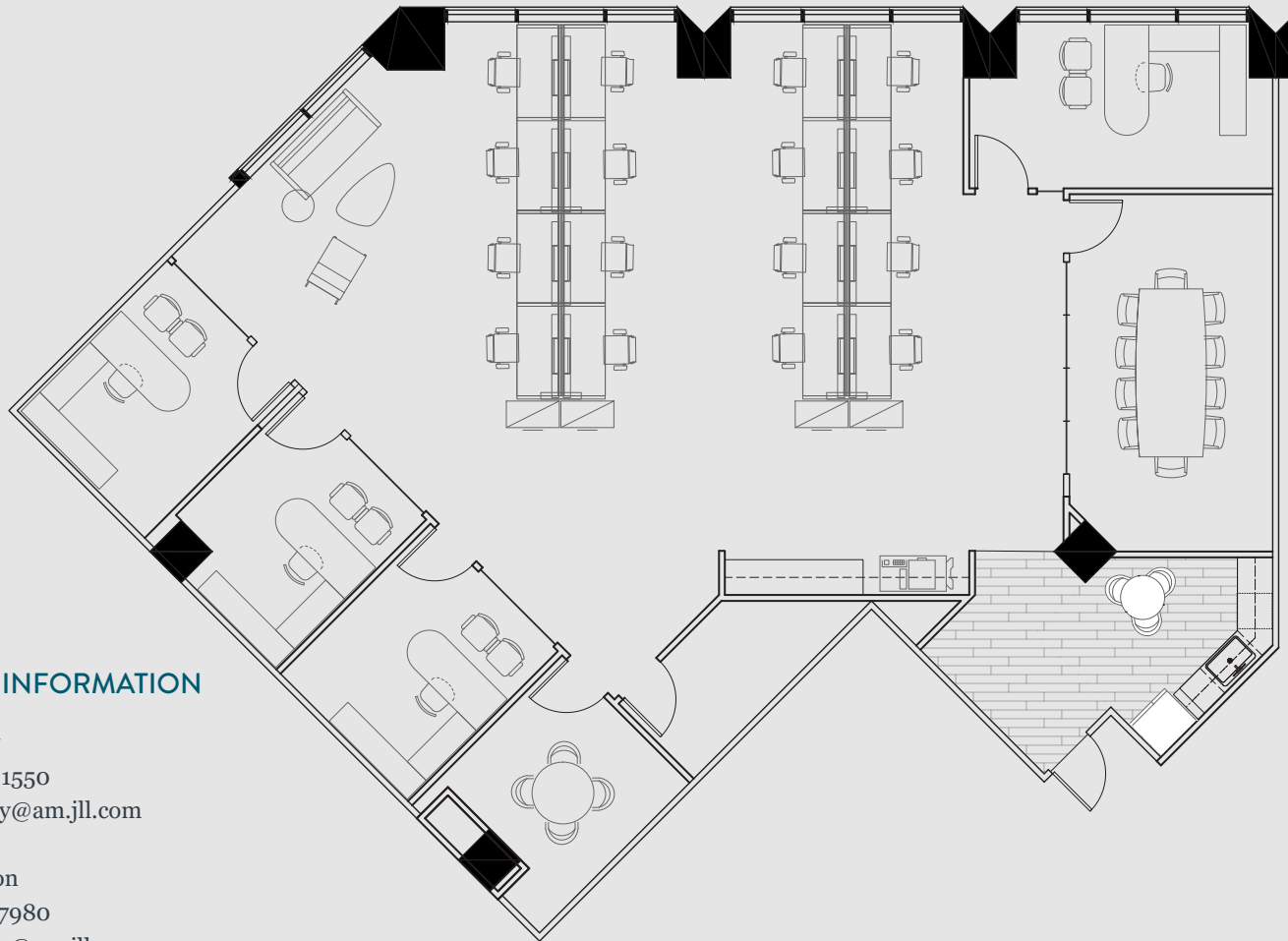

LEASING INFORMATION

Kevin Foley
+1 303.542.1550
kevin.p.foley@am.jll.com

Andy Willson
+1 303.217.7980
andy.willson@am.jll.com

