

CERTIFICATION:
 THE WITHIN DRAWINGS CONSISTING OF PAGES 1 THROUGH 3 OF
 EASTSIDE PLAZA CONDOMINIUM CONTAINS APPROXIMATELY
 1.1478 ACRES AS RECORDED IN SITUATED IN COUNTY OF MARION, STATE OF
 INDIANA AND BEING RECORDED IN INST. # 2009-002976 OF THE
 MARION COUNTY, INDIANA RECORDS.
 THE MEASUREMENTS ARE CERTIFIED CORRECT AND THESE DRAWINGS ACCURATELY SHOW
 THE BUILDING AS CONSTRUCTED. THESE DRAWINGS ALSO ACCURATELY REFLECT THE
 LOCATION OF IMPROVEMENTS.
 I AFFIRM, UNDER PENALTIES OF PERJURY, THAT I HAVE TAKEN REASONABLE CARE TO
 REDACT EACH SOCIAL SECURITY NUMBER IN THIS DOCUMENT, UNLESS REQUIRED BY LAW.

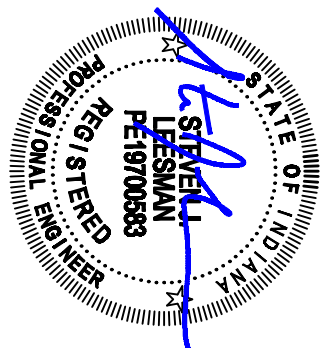

REGISTERED PROFESSIONAL ENGINEER
 LICENSE # PE19700583

ALP

CONDOMINIUM PLAT FOR:

EASTSIDE PLAZA CONDOMINIUM
 9503 E. WASHINGTON STREET
 LOCATED IN SECTION 5, TOWN 15N, RANGE 5E
 EAST OF THE PRINCIPAL MERIDIAN
 MARION COUNTY, INDIANA

OWNER:
 PRD PROPERTIES, LTD
 RANGA GORREPATI
 1843 KEMPER STRINGS DR.
 CINCINNATI, OHIO 45240
 HAMILTON COUNTY

BUILDING AREA
 BUILDING A = 5,481.2 SQ FT
 BUILDING B = 7,280.0 SQ FT

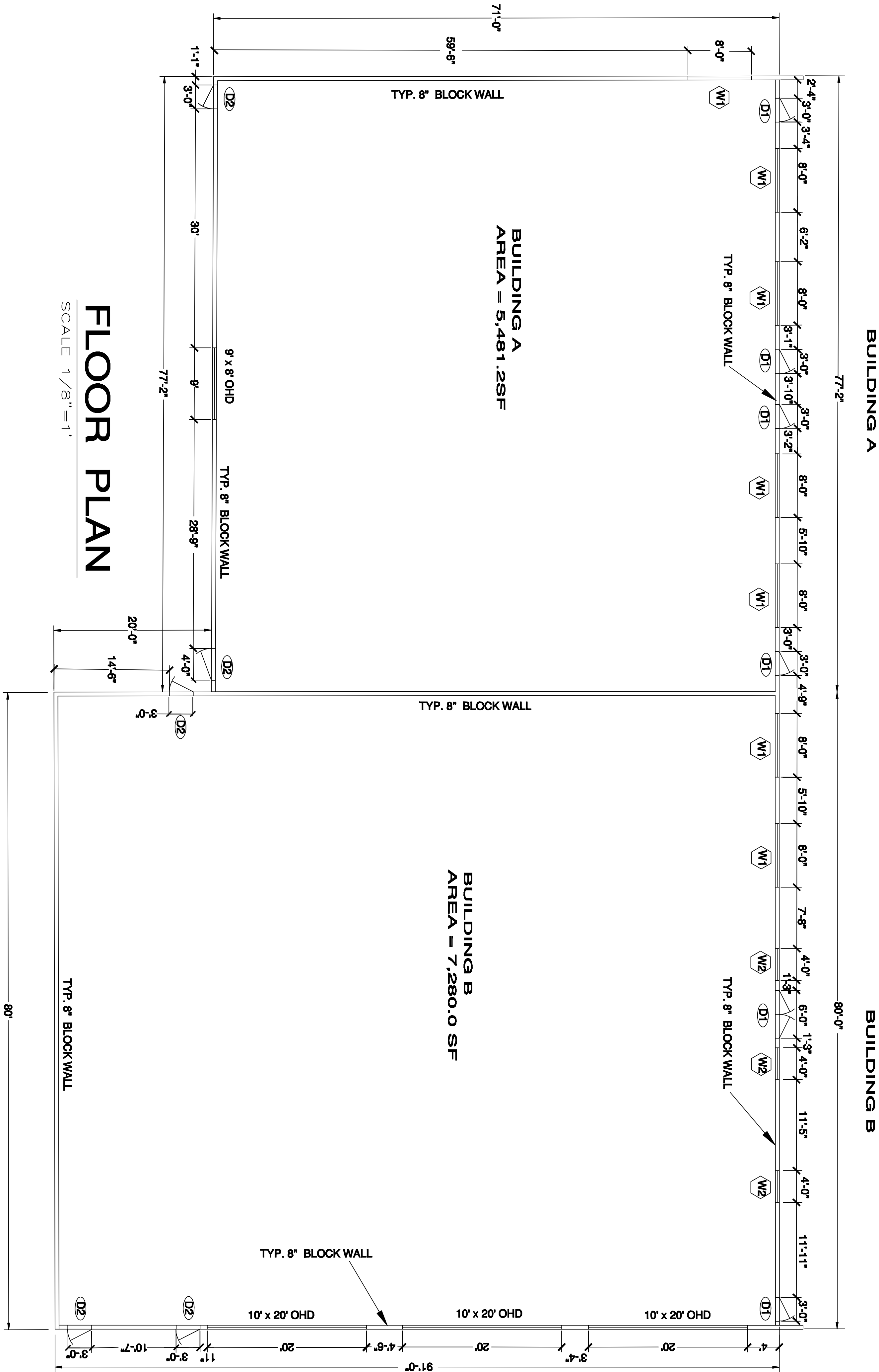

FLOOR PLAN

SCALE 1/8" = 1'

DOOR TYPES

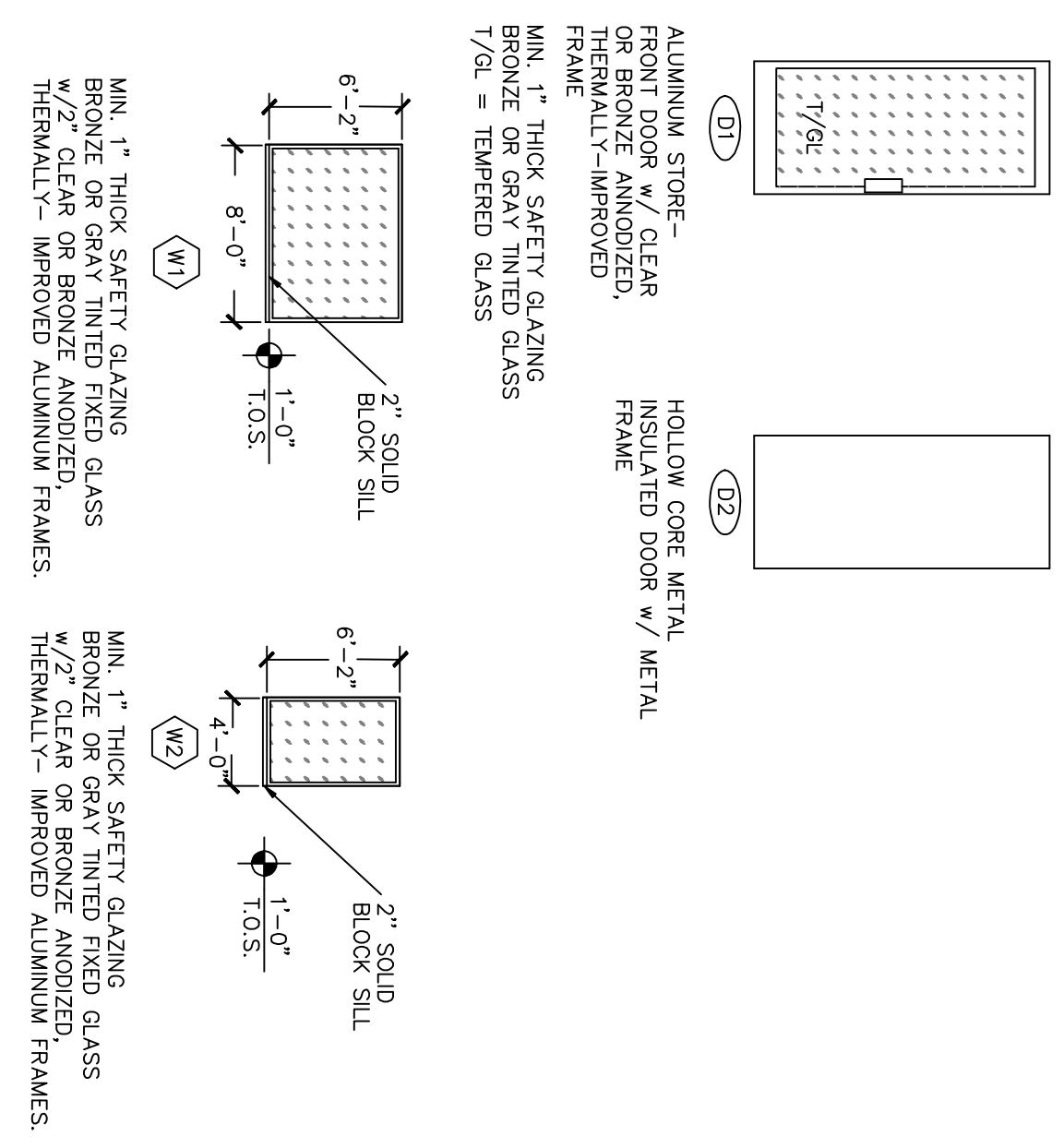

BACK REFERENCE
 INST. NO. 2006-0107271
 INST. NO. 2009-002976

EASTSIDE PLAZA CONDOMINIUM
 9503 E. WASHINGTON STREET
 SECTION 5, TOWN 15N, RANGE 5E
 EAST OF THE PRINCIPAL MERIDIAN
 MARION COUNTY, INDIANA

DATE: 2/15/2022
 SCALE: 1/8" = 1' feet
 SHEET NO.
 3 of 3