

# 510 & 600 Sunbeam Ave

Sacramento, CA



## 600 SUNBEAM AVE, SUITE 4 - ± 4,078 SF

±3,578, SF Warehouse

±500 SF Office

One (1) Grade Level Door (10' x 14')

## 510 SUNBEAM AVE - ±7,600 SF

±7,600 SF Freestanding Building

±3,768 SF Office

Two (2) Oversized Grade Level Doors (16' x 16')

± 0.83 Acre (36,087 SF) Secured Yard Space

## PROPERTY HIGHLIGHTS

16' Clear Height

Sprinklered

Insulated

Excellent Access to Downtown Sacramento and Major Freeways

Flexible C-4 Zoning

Site Plan on Reverse

### Contact:

#### Jeff Kvarme

First Vice President  
+1 916 203 5257  
jeff.kvarme@cbre.com  
Lic. 01924968

#### Tyler Howell

Senior Associate  
+1 916 781 4835  
tyler.howell1@cbre.com  
Lic. 02100245

# 600 SUNBEAM AVE

For Lease

## Floor Plan

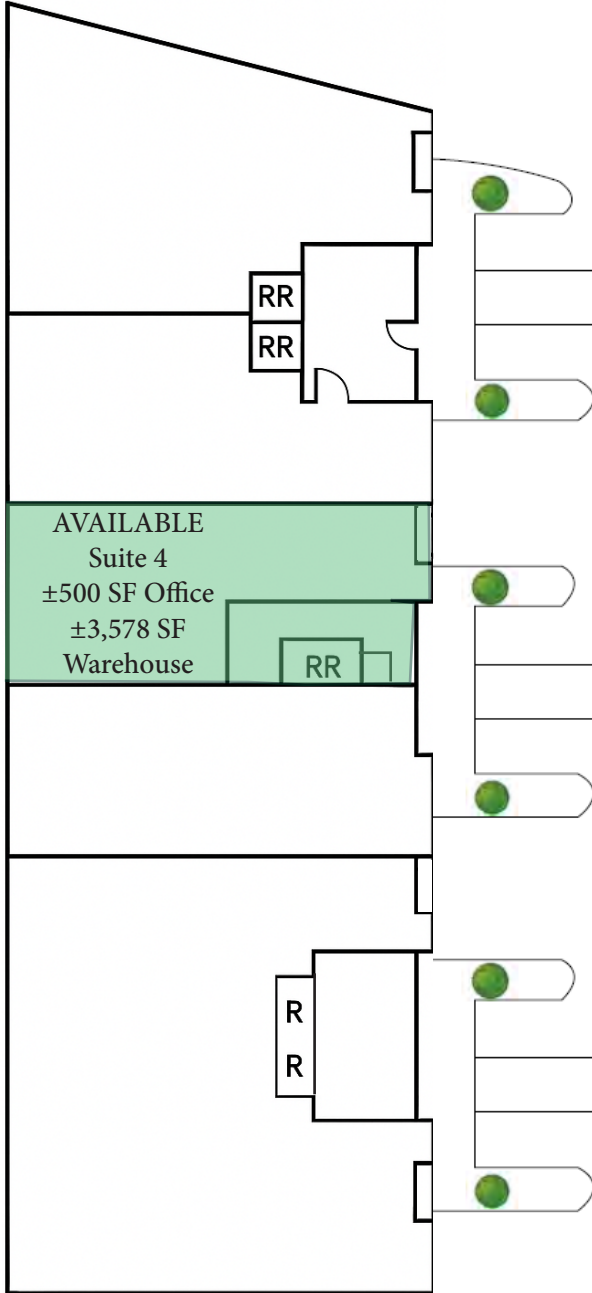

## Site Aerial



## Area Map

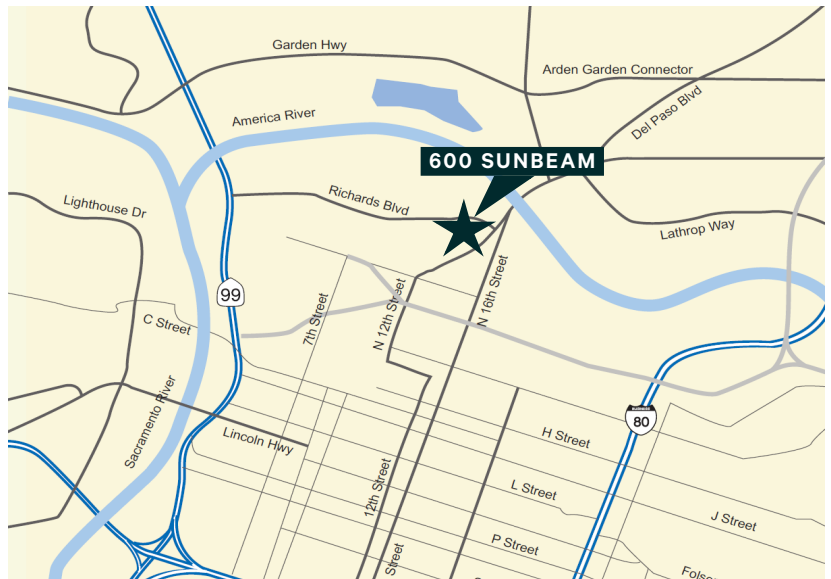

© 2025 CBRE, Inc. All rights reserved. This information has been obtained from sources believed reliable, but has not been verified for accuracy or completeness. You should conduct a careful, independent investigation of the property and verify all information. Any reliance on this information is solely at your own risk. CBRE and the CBRE logo are service marks of CBRE, Inc. All other marks displayed on this document are the property of their respective owners, and the use of such logos does not imply any affiliation with or endorsement of CBRE. Photos herein are the property of their respective owners. Use of these images without the express written consent of the owner is prohibited.

# 510 SUNBEAM AVE

For Lease

## Site Photo



## Site Aerial



## Floor Plan

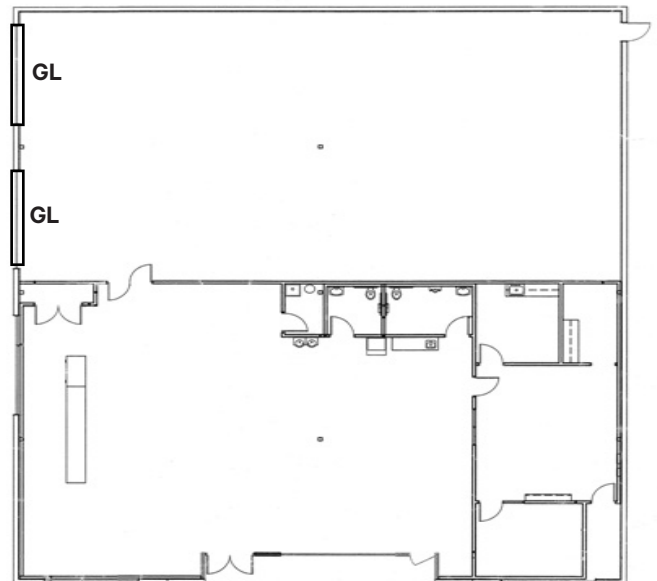

### Contact:

**Jeff Kvarme**  
First Vice President  
+1 916 203 5257  
jeff.kvarme@cbre.com  
Lic. 01924968

**Zac Sweet, SIOR**  
Senior Vice President  
+1 916 717 4768  
zac.sweet@cbre.com  
Lic. 01352800

**Tyler Howell**  
Senior Associate  
+1 916 781 4835  
tyler.howell1@cbre.com  
Lic. 02100245

**Courtney Lee**  
Associate  
+1 916 906 5544  
courtney.lee@cbre.com  
Lic. 02031694

