



639 FRONT STREET
SAN FRANCISCO, CA

FINLAYPACIFIC
commercial real estate



For information, please contact our
exclusive listing agent:

Matthew Brasler

Lic.01260686

Principal

415.271.5297

mbrasler@finlaypacific.com



Finlay Pacific

233 Sansome Street

Suite 700

San Francisco, CA 94104

www.finlaypacific.com

Building Highlights

- Prime Jackson Square location
- Direct views to Washington Square
- Brick walls and wood ceilings
- Key FOB access to the building
- Local 'mom and pop' ownership

Ground floor ± 4,684 rsf

- Full private floor
- Exposed wood ceilings
- Brick perimeter walls
- Natural light from Front Street and rear skylights
- Front Street conference room
- Two large conference rooms
- Full kitchen
- Two restrooms
- 30 workstations in place

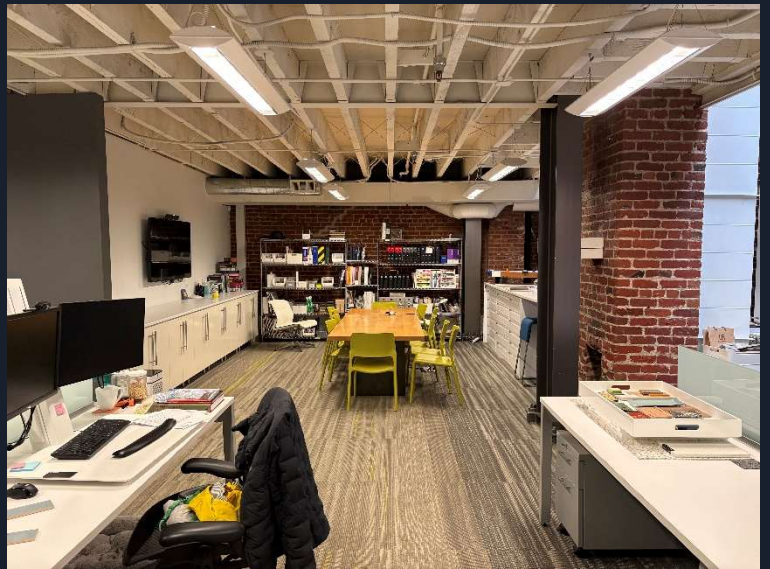

639 FRONT STREET SAN FRANCISCO, CA Ground floor – 4,684 square feet

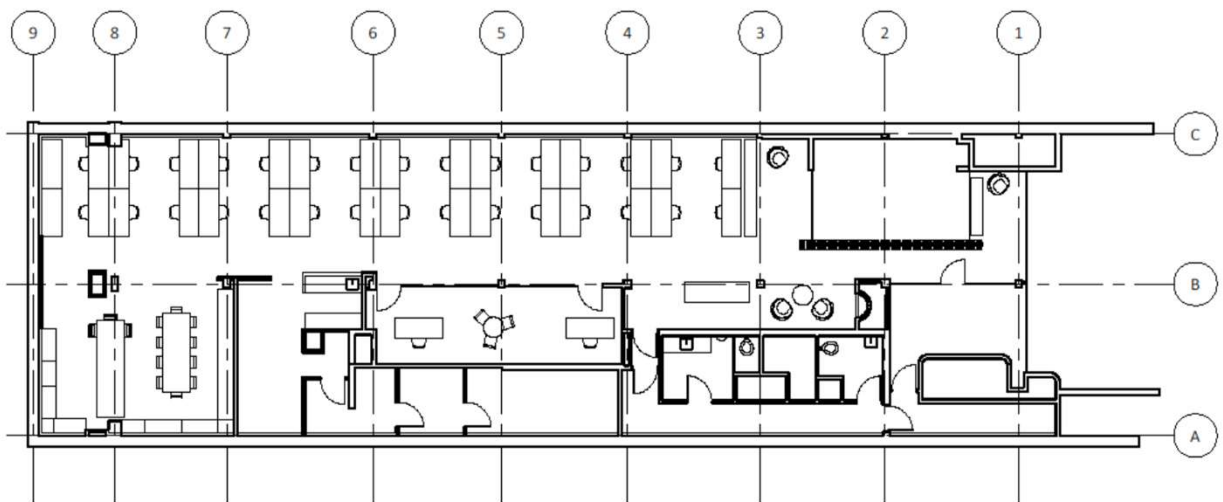

THIS DOCUMENT WAS PREPARED BY QA FOR INTERNAL USE. ALL DIMENSIONS, SIZING/TYPES OF EQUIPMENT, AND SIZING/TYPES OF FURNITURE ARE FOR REPRESENTATIONAL PURPOSES ONLY. ANY USE OF THIS DOCUMENT FOR SPACE PLANNING OR ANY SIMILAR TASKS IS AT THE RISK OF THE PERSON OR ORGANIZATION DOING THE WORK. BY USING THIS PLAN THE USER IS AGREEING TO INDEMNIFY QA FROM ANY LIABILITY REGARDING THIS DOCUMENT AND TO ACCEPT ALL AND ALL LIABILITY FOR ACTIONS PERFORMED WHILE USING THIS DOCUMENT.

639 Front Street

OFFICE FLOOR PLAN

A201

NOT TO SCALE
DATE: 4/14/2026 2:19:50 PM
PROJECT #: 25000.00



639 FRONT STREET
SAN FRANCISCO, CA
Ground floor – 4,684 square feet





FINLAYPACIFIC
commercial real estate

Contact Us

For information, please contact our
exclusive listing agent:



Matthew Brasler

Lic.01260686

Principal

415.271.5297

mbrasler@finlaypacific.com



Finlay Pacific

244 California Street

Suite 308

San Francisco, CA 94111

www.finlaypacific.com