

CHELSEA

AT JUANITA VILLAGE

LEASING OPPORTUNITIES



11718 97TH LN NE
KIRKLAND, WA 98034

BROKER BONUS | 1% TO OUTSIDE BROKER | EXPIRES MARCH 31, 2025

EURO STYLE MEETS JUANITA BEACH

A LIFE WELL-LIVED

Chelsea at Juanita Village is a charming, European-inspired community center nestled near the picturesque Juanita Bay waterfront in Kirkland, Washington. This walkable destination boasts a thriving ground-floor retail scene, perfectly positioned to serve a captive audience of active young professionals residing in over 1,000 nearby apartments.

Furthermore, Chelsea at Juanita Village benefits from a substantial daytime population, creating a consistent stream of potential customers.

Ideally situated just minutes away from Downtown Kirkland, the renowned Kirkland Urban Mall, and The Village at Totem Lake (home to Whole Foods, Nordstrom Rack, and Trader Joe's), Chelsea at Juanita Village enjoys unparalleled access to a vibrant and thriving regional market.

LEASING HIGHLIGHTS

R1.01: 3,749 SF | CALL FOR RATES | SPACE CAN BE DEMISED

NEARBY TENANTS



Walgreens



urban
COFFEE
lounge

DEMOGRAPHICS



TRADE AREA Drive Time Analysis

	Population	Total Employees	Average Household Income	Median Age	Households	White Collar Workers %
5 MINUTES	25,776	11,552	\$199,558	37.7	11,089	81.7%
7 MINUTES	48,749	19,296	\$208,197	38.3	21,442	81.5%
10 MINUTES	83,461	34,677	\$217,435	38.2	35,490	80.4%

THE KIRKLAND AREA



**126,824 HOUSEHOLDS
5 MILE RADIUS**



**CENTRALLY LOCATED TO
TOTEM LAKE & DOWNTOWN KIRKLAND**



**THRIVING BUSINESS
ENVIRONMENT**



**7 MINUTES DRIVE TIME
FROM I-405**

A THRIVING WATERFRONT DESTINATION



AMPLE PARKING | 1,000+ ADJACENT RESIDENTIAL UNITS | RESTAURANTS | PUBLIC PARKS | BEACHES

AVAILABLE UNIT LOCATION | R1.01 | 3,739 SF



ONLY ONE SPACE REMAINS! | SPACE CAN BE DEMISED | SURFACE AND GARAGE PARKING

AVAILABLE UNIT PLAN

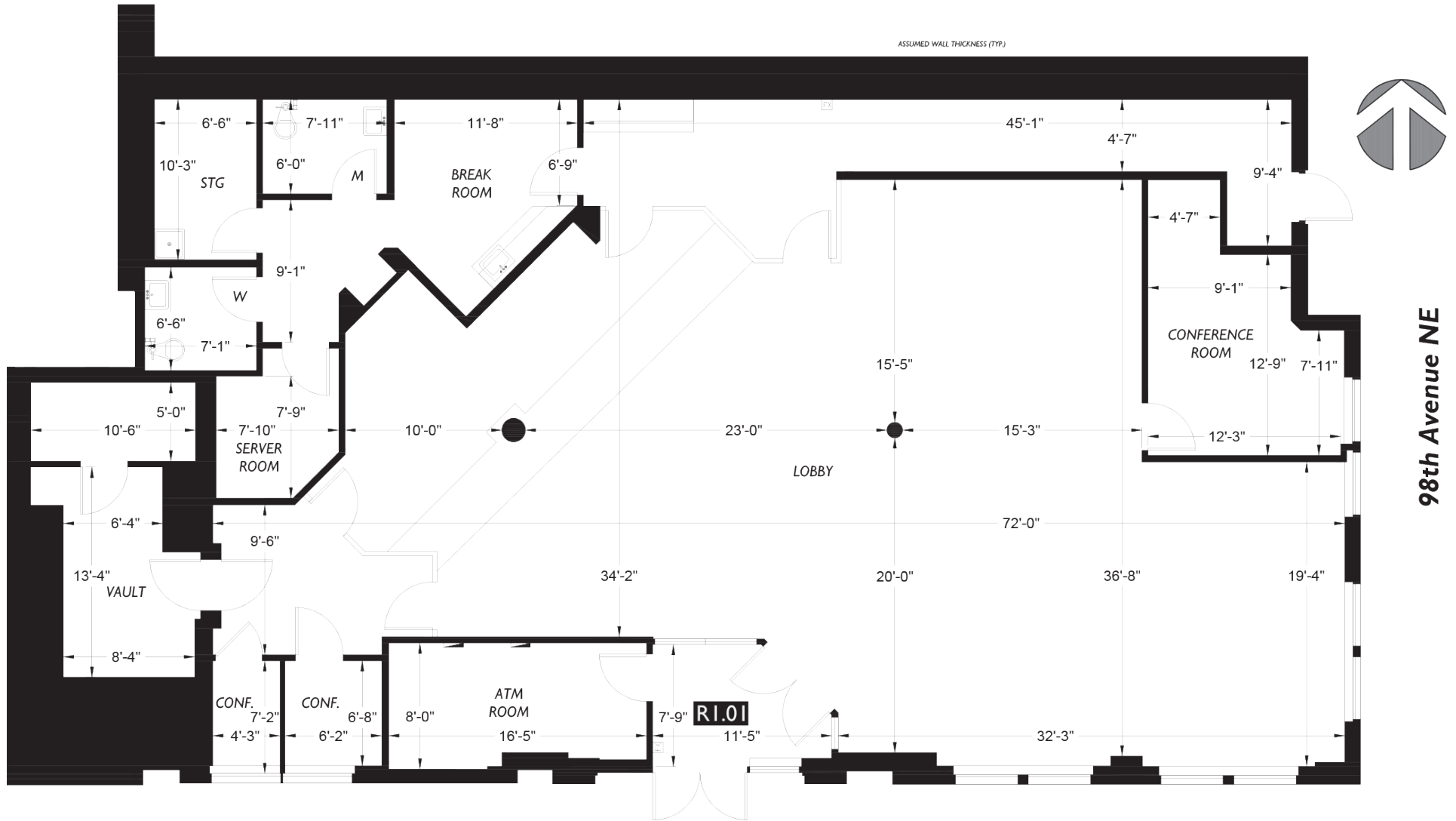

CURRENT CONFIGURATION | UP TO 3,749 SF | SPACE CAN BE DEMISED

A HIGHLY DESIRABLE LOCATION



HIGHLY WALKABLE | EASILY ACCESSIBLE | CHARMING WATERFRONT COMMUNITY | URBAN AMENITIES

A HIGHLY DESIRABLE LOCATION



AFFLUENT SUBURB OF KIRKLAND | SURROUNDED BY DENSE RESIDENTIAL | POPULAR BEACH DESTINATION

JOIN OUR COMMUNITY



EAST LAKE WASHINGTON | WELL-CONNECTED | VIBRANT

GET IN TOUCH

CONTACT INFORMATION

JAKE THURBER

425.250.3277

jthurber@fwp-inc.com



PROUDLY OWNED BY

GROSVENOR



First Western Properties, Inc. | 425.822.5522

11621 97th Lane NE Kirkland, WA 98034 | fwp-inc.com

KIRKLAND | TACOMA | PORTLAND | SEATTLE

© First Western Properties, Inc. DISCLAIMER: The above information has been secured from sources believed to be reliable, however, no representations are made to its accuracy. Prospective tenants or buyers should consult their professional advisors and conduct their own independent investigation. Properties are subject to change in price and/or availability without notice.

