

FOR LEASE

±38,322 SQ. FT.

Industrial Building

1468 DAVRIL CIR. | CORONA | CA



PROPERTY FEATURES

- ±38,322 Sq. Ft. Portion of a Larger Building
- ±6,500 of Office Space (with unimproved mezzanine above)
- Can Be Combined with 1467 Davril Circle (±54,083 Sq. Ft.) Totaling ± 92,405 Sq. Ft.
- 2,000 Amps, 277/480 Volt Power (Verify)
- 2:1,000 Sq. Ft. Parking Ratio
- One (1) Ground Level Loading Door
- Four (4) Dock High Loading Doors
- 24'-26' Minimum Warehouse Clearance
- Fire Sprinklered
- Convenient Access to the Riverside (91) and Interstate (15) Freeways



MIKE HEFNER, SIOR

Executive Vice President | Partner

(714) 935-2331

mhefner@voitco.com

License #00857352

Voit
REAL ESTATE SERVICES

HV HEFNER
VERNICK
TEAM

2400 E. Katella Ave., Suite 750
Anaheim, CA 92806
www.VoitCo.com

FOR LEASE

±38,322 SQ. FT.
Industrial Building

1468 DAVRIL CIR. | CORONA | CA

SITE PLAN

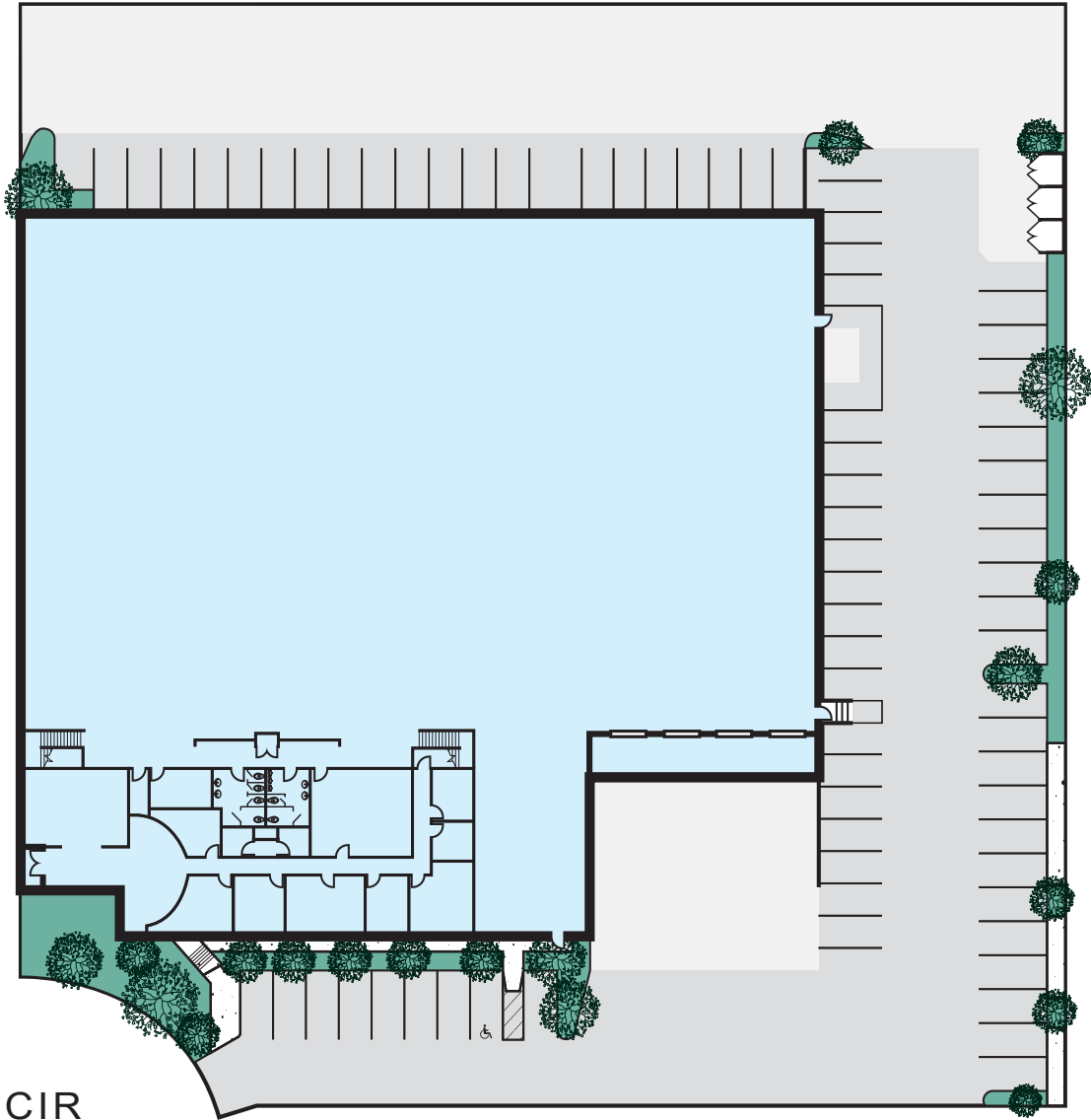

DAVRIL CIR

**Not to scale*

MIKE HEFNER, SIOR
Executive Vice President | Partner
(714) 935-2331
mhefner@voitco.com
License #00857352

Voit
REAL ESTATE SERVICES

HV HEFNER
VERNICK
TEAM

2400 E. Katella Ave., Suite 750
Anaheim, CA 92806
www.VoitCo.com