

# 334 North Street

Momence, IL 60954

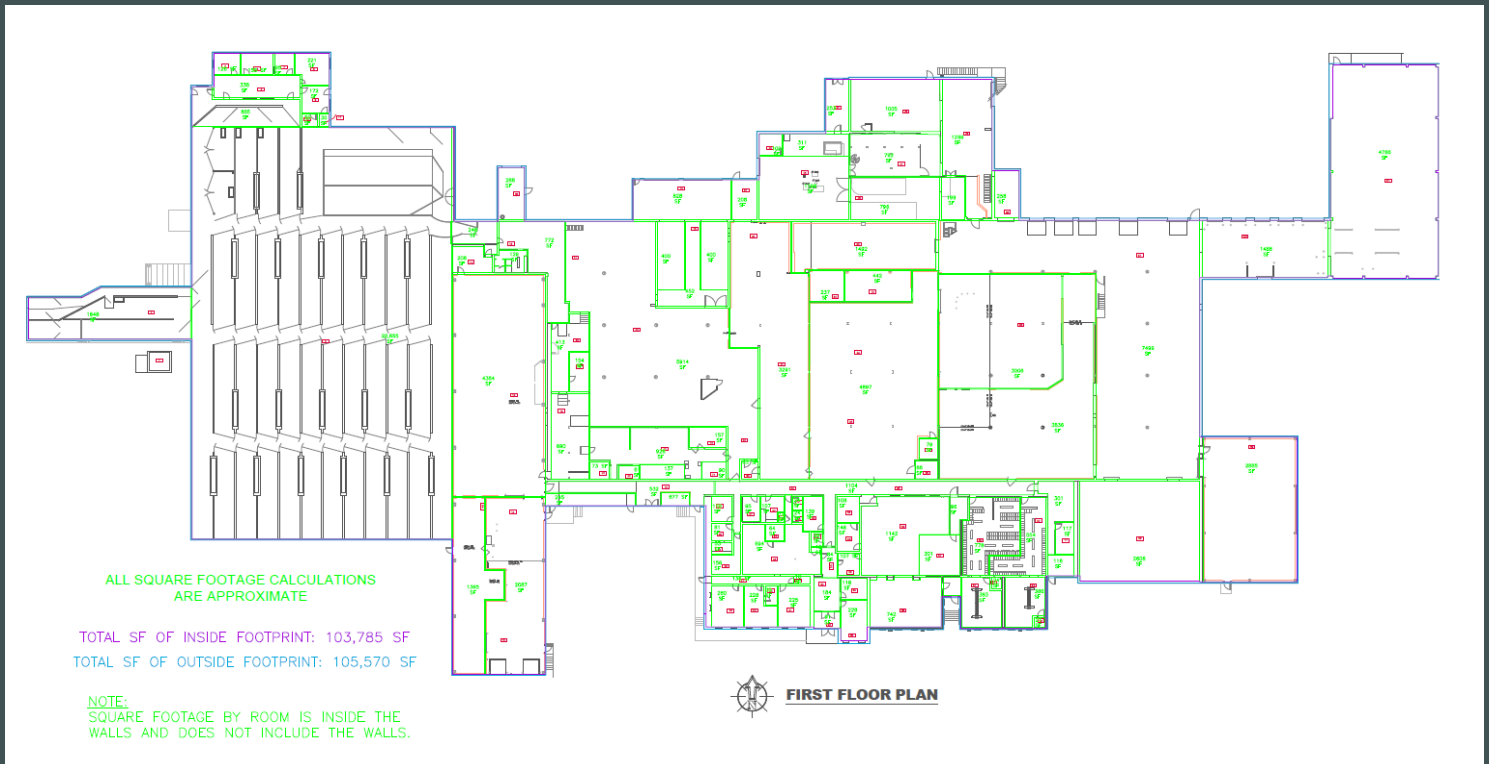



### Property Overview

- + Built: 1962
- + Campus Size: 12 acres
- + Facility Size: 103,785 sq. ft.

### Building Features

- + Full Fire Suppression System
- + Electrical Service: 460v, 3,000 Amp. Service
- + Dock Doors: 10

### Temperature-Controlled Space

- + Refrigerated Space:
  - 5,500 sq. ft. at +0 degrees
  - 29,245 sq. ft. at +42 degrees
- + Ceiling Height: Ranges from 19' to 9' (in refrigerated area)

### Infrastructure & Capacity

Infrastructure & Capacity	Year
Freezer Addition	1981
Production Addition	1997
Dry Storage Addition	2010
Freezer Addition	2021

## Contact Us

#### Pete D. Roberson

Senior Vice President  
+1 847 254 9259  
pete.roberson@cbre.com

#### Chris Schatok

Executive Vice President  
+1 847 602 8118  
chris.schatok@cbre.com

© 2025 CBRE, Inc. All rights reserved. This information has been obtained from sources believed reliable, but has not been verified for accuracy or completeness. You should conduct a careful, independent investigation of the property and verify all information. Any reliance on this information is solely at your own risk. CBRE and the CBRE logo are service marks of CBRE, Inc. All other marks displayed on this document are the property of their respective owners, and the use of such logos does not imply any affiliation with or endorsement of CBRE. Photos herein are the property of their respective owners. Use of these images without the express written consent of the owner is prohibited.