

# 2,478 SF RESTAURANT SITE ON .40 AC

## IDEAL LOCATION OFF ROUTE 30 (LINCOLN HWY)

1460 N 3RD ST LARAMIE, WY 82072

FOR SALE



**SALE PRICE CALL FOR PRICING**

### PROPERTY HIGHLIGHTS

- For Sale
- 2,478 +/- SF Restaurant Site on .40 +/- AC
- Previously a Pizza Hut
- Drive-thru Capable
- Estimated Daily Traffic Count: 12,000-20,000+ ADT
- Built in 1977
- Zoned: B-2
- (35) Parking Stalls
- Parcel ID: 1673283400300
- Prime Location Just Off Route 30 & Minutes from I-80

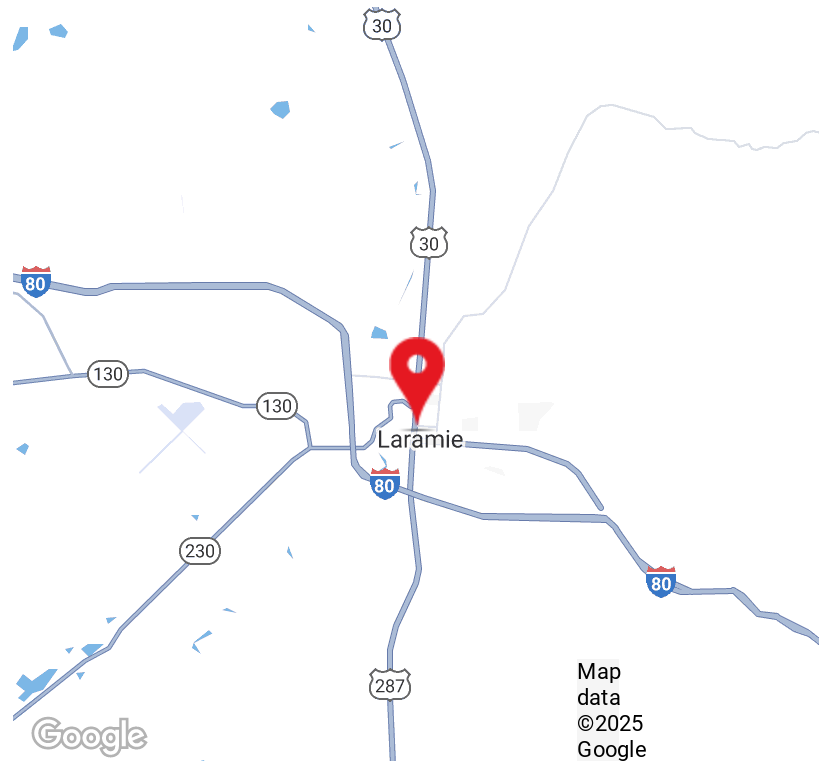

**Tom Bradley**  
Managing Broker  
303.880.0108  
tom.bradley@erescompanies.com



# 2,478 SF RESTAURANT SITE ON .40 AC

## IDEAL LOCATION OFF ROUTE 30 (LINCOLN HWY)

1460 N 3RD ST LARAMIE, WY 82072

FOR SALE

AERIAL



**Tom Bradley**  
Managing Broker  
303.880.0108  
tom.bradley@erescompanies.com



2,478 SF RESTAURANT SITE ON .40 AC

IDEAL LOCATION OFF ROUTE 30 (LINCOLN HWY)

1460 N 3RD ST LARAMIE, WY 82072

FOR SALE

ADDITIONAL PHOTOS



**Tom Bradley**  
Managing Broker  
303.880.0108  
tom.bradley@erescompanies.com



ERES | erescompanies.com

# 2,478 SF RESTAURANT SITE ON .40 AC

## IDEAL LOCATION OFF ROUTE 30 (LINCOLN HWY)

1460 N 3RD ST LARAMIE, WY 82072

FOR SALE

### SITE MAP

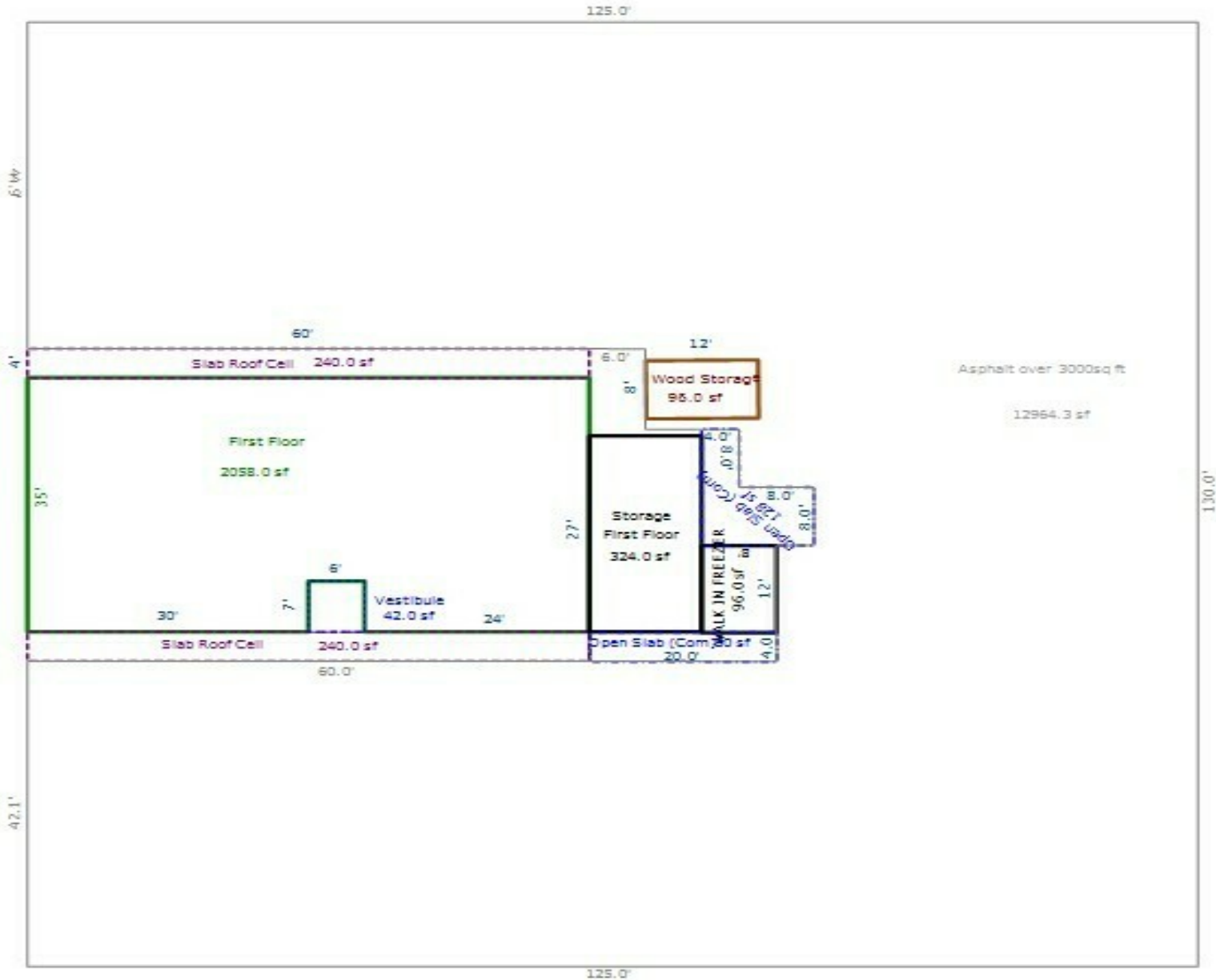

**Tom Bradley**  
Managing Broker  
303.880.0108  
tom.bradley@erescompanies.com



# 2,478 SF RESTAURANT SITE ON .40 AC

## IDEAL LOCATION OFF ROUTE 30 (LINCOLN HWY)

1460 N 3RD ST LARAMIE, WY 82072

FOR SALE

RETAILER MAP

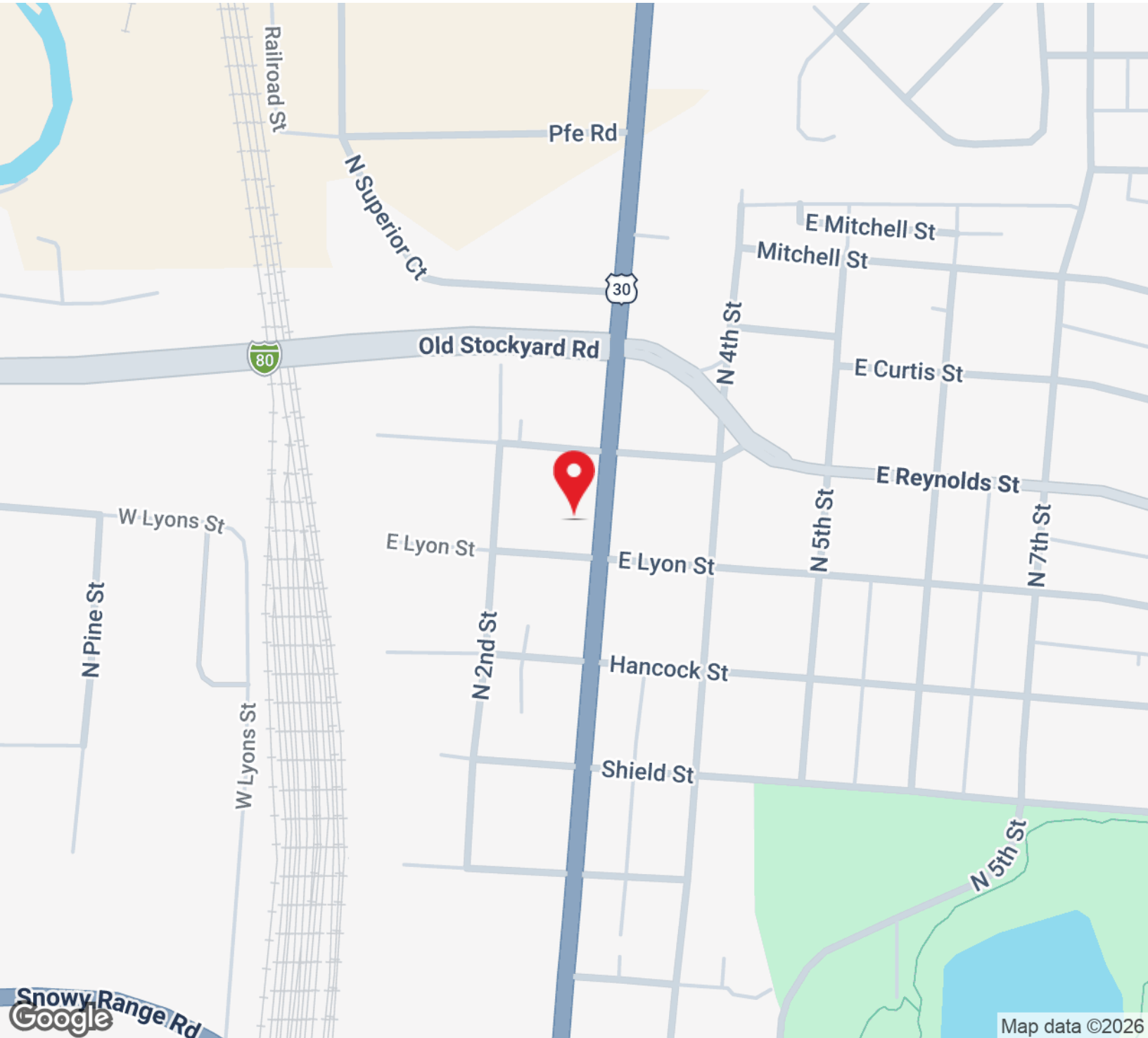

**Tom Bradley**  
Managing Broker  
303.880.0108  
tom.bradley@erescompanies.com



# 2,478 SF RESTAURANT SITE ON .40 AC

## IDEAL LOCATION OFF ROUTE 30 (LINCOLN HWY)

1460 N 3RD ST LARAMIE, WY 82072

FOR SALE

### DEMOGRAPHICS MAP & REPORT

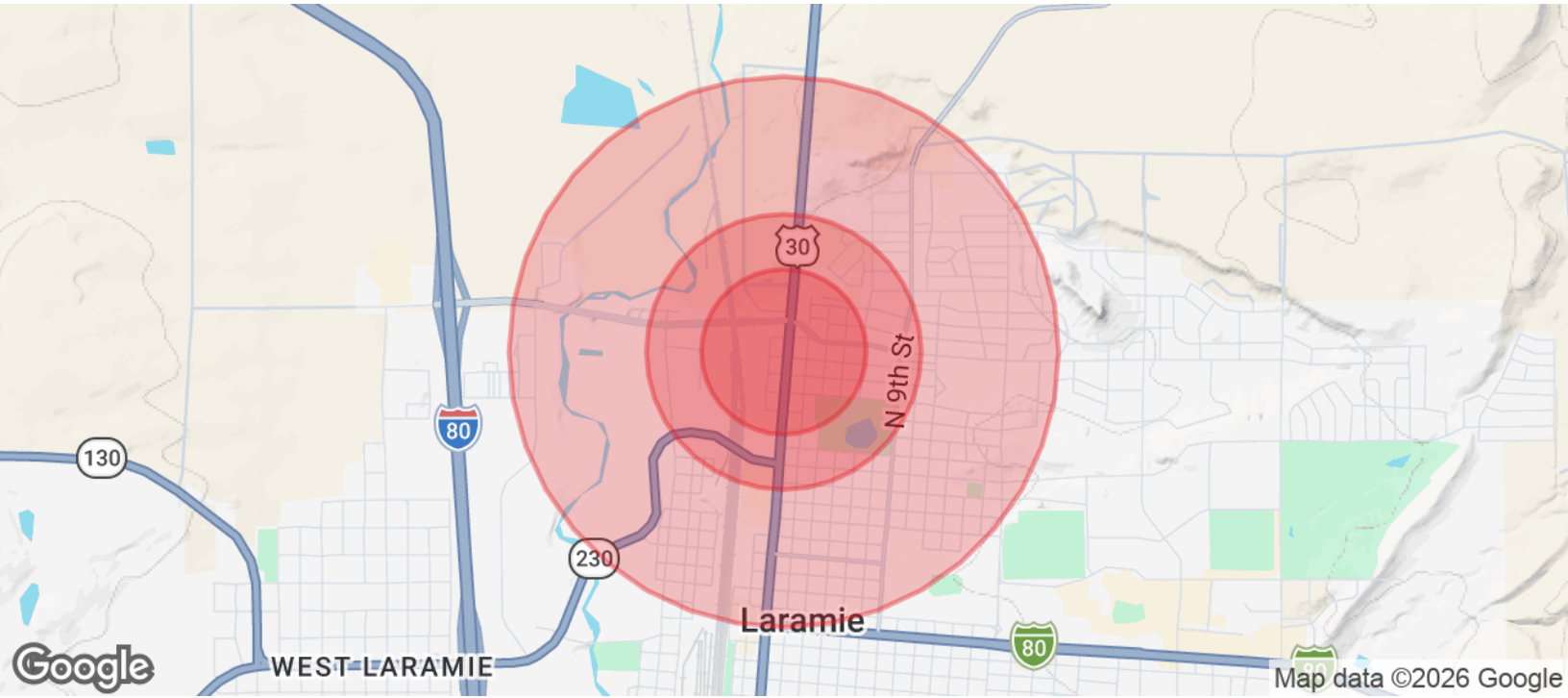

POPULATION	0.3 MILES	0.5 MILES	1 MILE
Total Population	519	1,910	8,335
Average Age	34	35	34
Average Age (Male)	33	33	33
Average Age (Female)	36	36	35

HOUSEHOLDS & INCOME	0.3 MILES	0.5 MILES	1 MILE
Total Households	261	951	4,138
# of Persons per HH	2	2	2
Average HH Income	\$62,162	\$68,653	\$74,142
Average House Value	\$206,438	\$212,504	\$257,085

2020 American Community Survey (ACS)

**Tom Bradley**  
Managing Broker  
303.880.0108  
tom.bradley@erescompanies.com

