

# FOR SALE

±26,794 SF TOTAL BLDGS

# 5519

JILLSON ST

COMMERCE, CA 90040



## MAJOR PRICE REDUCTION

### SALE PRICE: \$7,600,000

### PROPERTY HIGHLIGHTS

-  City of Commerce Housing Opportunity Overlay
-  ±26,794 SF of Buildings
-  ±53,946 SF of Land
-  Adjacent to City Hall in City of Commerce
-  Well Maintained Clean Buildings
-  12' - 18' Clear Height
-  4 GL Doors & 2 DH Positions
-  Zoning: CMM2
-  Heavy Power: 1,000 Amps, 277 / 480 V
-  Easy Access to I-5 Freeway and Eastern Ave
-  Occupied by Short Term Tenants
-  Suitable for Owner-Users, Investors or Developers

**ASKING PRICE: \$7,600,000**

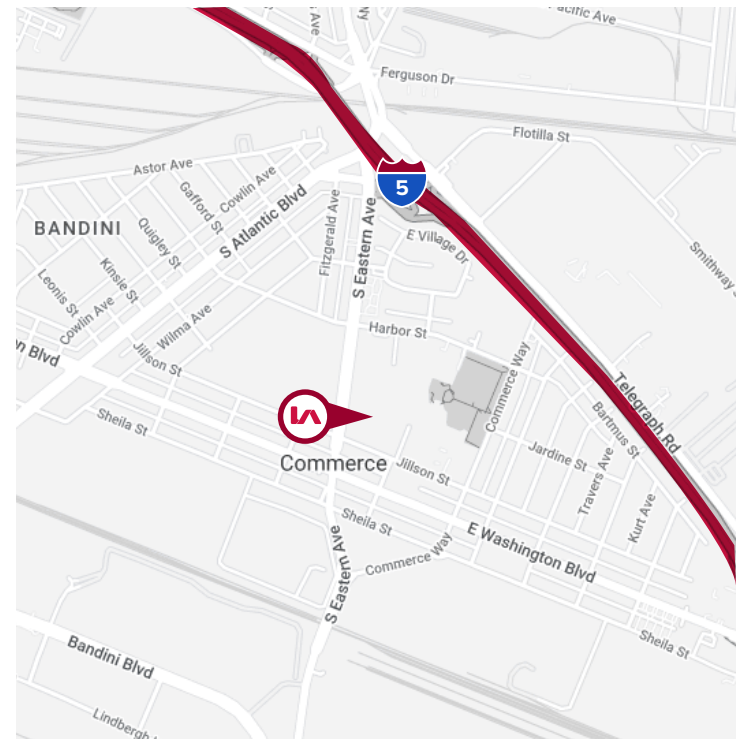

**Touring Instructions: Do not disturb tenants.**  
Email Agent at least 24 hours in advance.

### SEHYUNG KIM

Senior Vice President | LIC NO 01327276

skim@lee-associates.com | 213.290.3599

[www.skimcre.com](http://www.skimcre.com)

All information furnished regarding property for sale, rental or financing is from sources deemed reliable, but no warranty or representation is made to the accuracy thereof and same is submitted to errors, omissions, change of price, rental or other conditions prior to sale, lease or financing or withdrawal without notice. No liability of any kind is to be imposed on the broker herein.

# FOR SALE - 5519 Jillson St

## SITE PLAN

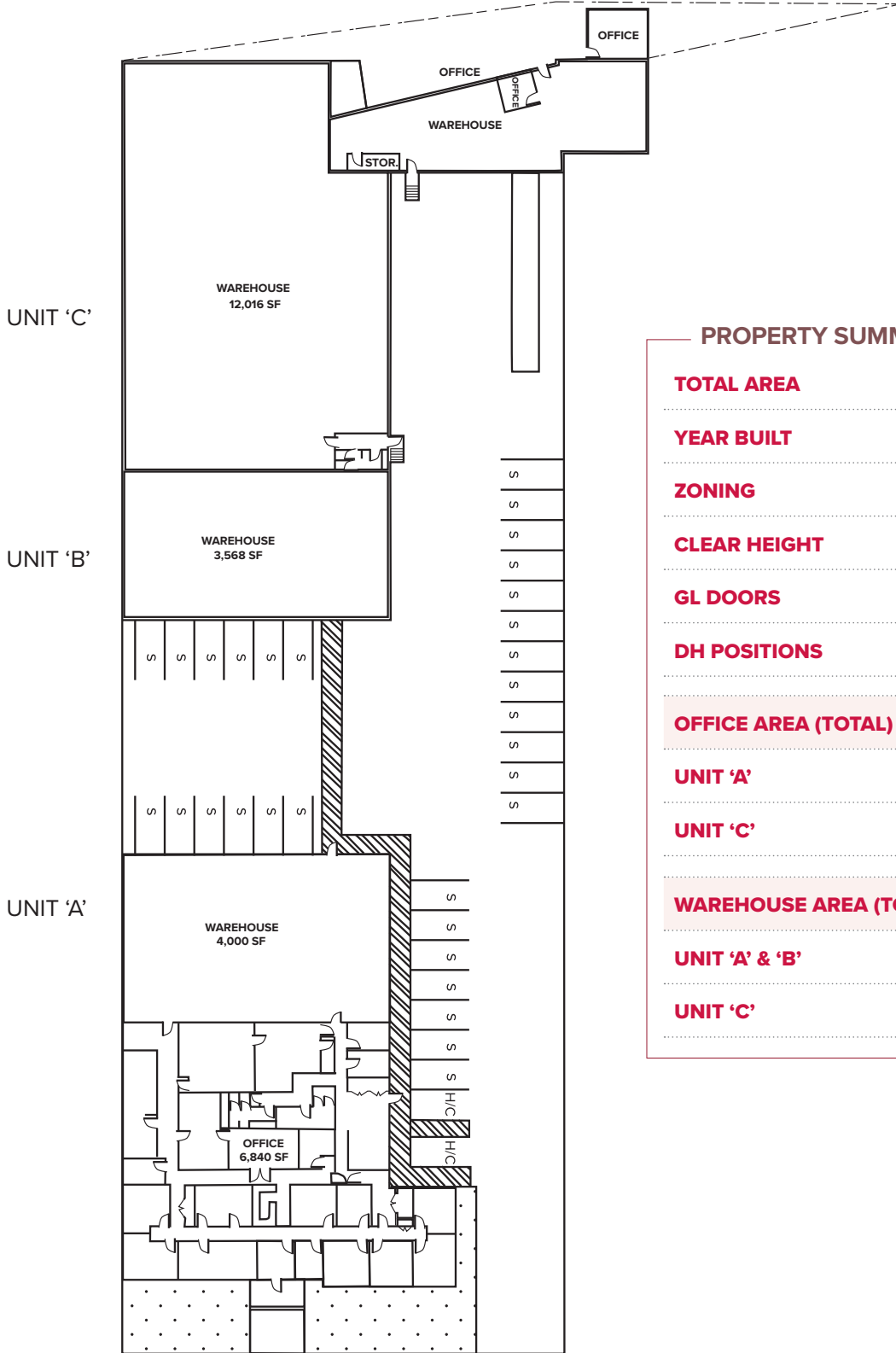

### PROPERTY SUMMARY

<b>TOTAL AREA</b>	±26,794 SF
<b>YEAR BUILT</b>	1952
<b>ZONING</b>	CMM2
<b>CLEAR HEIGHT</b>	12' - 18'
<b>GL DOORS</b>	4 (19' x 11' - 10' x 11')
<b>DH POSITIONS</b>	2 (12' x 12')
<b>OFFICE AREA (TOTAL)</b>	±7,210 SF
<b>UNIT 'A'</b>	±6,840 SF
<b>UNIT 'C'</b>	±370 SF
<b>WAREHOUSE AREA (TOTAL)</b>	±19,584 SF
<b>UNIT 'A' &amp; 'B'</b>	±7,568 SF
<b>UNIT 'C'</b>	±12,016

### SEHYUNG KIM

Senior Vice President | LIC NO 01327276

skim@lee-associates.com | 213.290.3599

[www.skimcre.com](http://www.skimcre.com)

All information furnished regarding property for sale, rental or financing is from sources deemed reliable, but no warranty or representation is made to the accuracy thereof and same is submitted to errors, omissions, change of price, rental or other conditions prior to sale, lease or financing or withdrawal without notice. No liability of any kind is to be imposed on the broker herein.



## AERIAL & LOCAL LANDMARKS



### SEHYUNG KIM

Senior Vice President | LIC NO 01327276

skim@lee-associates.com | 213.290.3599

[www.skimcre.com](http://www.skimcre.com)

All information furnished regarding property for sale, rental or financing is from sources deemed reliable, but no warranty or representation is made to the accuracy thereof and same is submitted to errors, omissions, change of price, rental or other conditions prior to sale, lease or financing or withdrawal without notice. No liability of any kind is to be imposed on the broker herein.

**LEE & ASSOCIATES**  
COMMERCIAL REAL ESTATE SERVICES

# FOR SALE - 5519 Jillson St

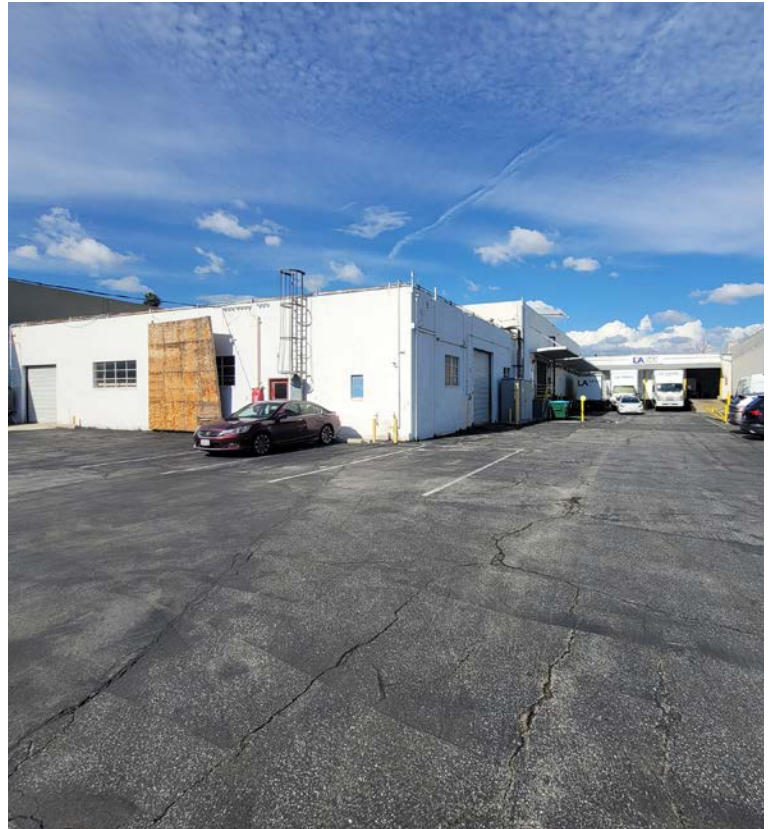

## SEHYUNG KIM

Senior Vice President | LIC NO 01327276

skim@lee-associates.com | 213.290.3599

[www.skimcre.com](http://www.skimcre.com)

All information furnished regarding property for sale, rental or financing is from sources deemed reliable, but no warranty or representation is made to the accuracy thereof and same is submitted to errors, omissions, change of price, rental or other conditions prior to sale, lease or financing or withdrawal without notice. No liability of any kind is to be imposed on the broker herein.

# FOR SALE - 5519 Jillson St

## STREET VIEW



## AERIAL VIEW

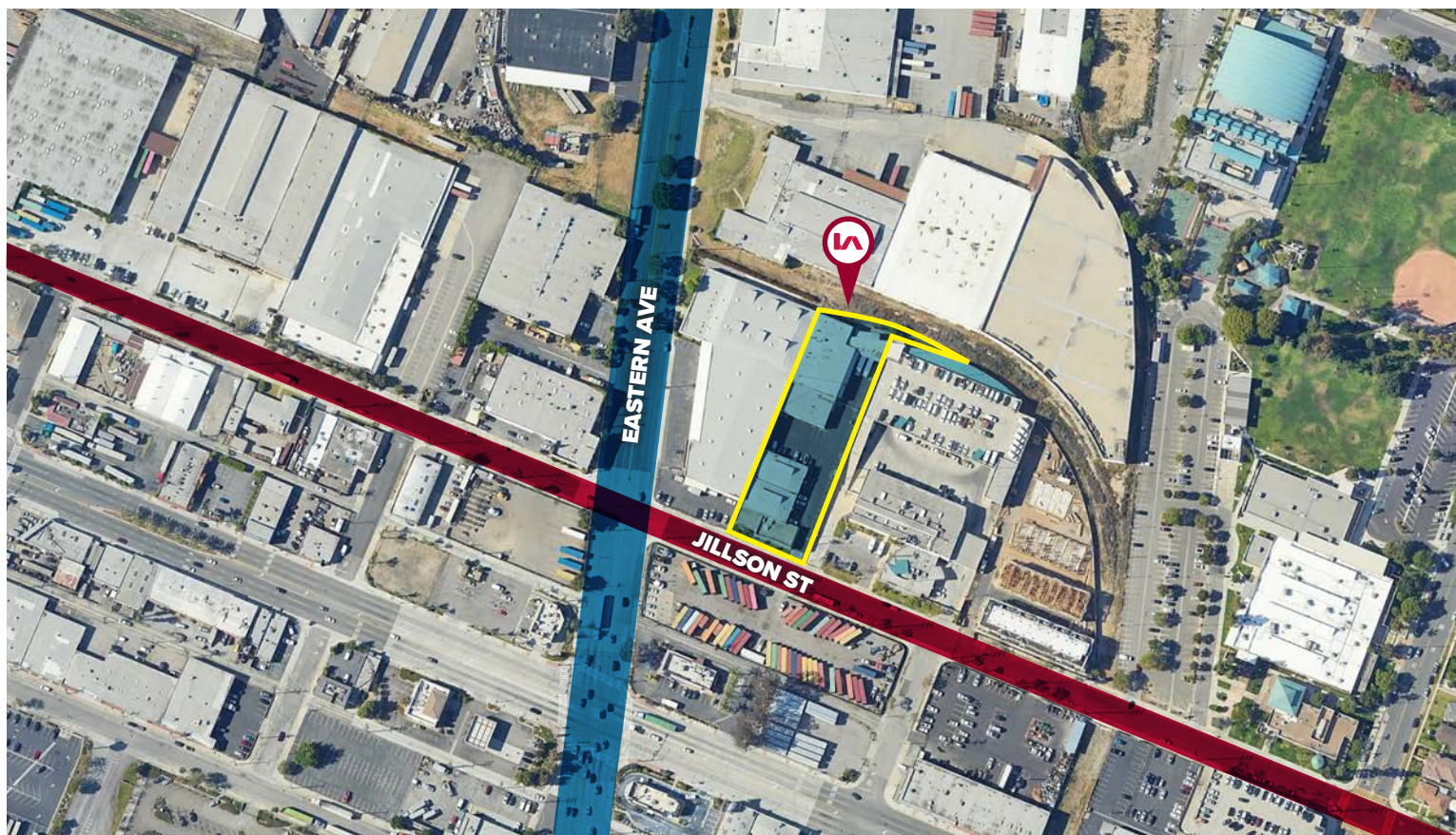

### SEHYUNG KIM

Senior Vice President | LIC NO 01327276

skim@lee-associates.com | 213.290.3599

[www.skimcre.com](http://www.skimcre.com)

All information furnished regarding property for sale, rental or financing is from sources deemed reliable, but no warranty or representation is made to the accuracy thereof and same is submitted to errors, omissions, change of price, rental or other conditions prior to sale, lease or financing or withdrawal without notice. No liability of any kind is to be imposed on the broker herein.



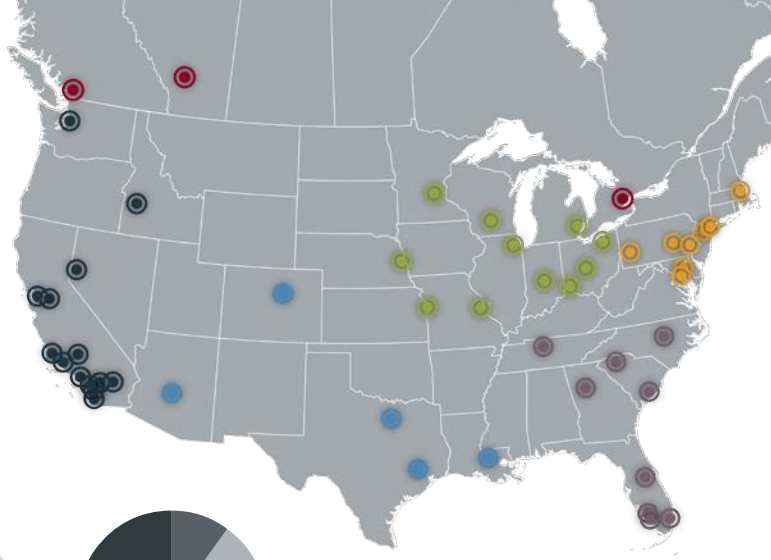

LOCAL EXPERTISE. INTERNATIONAL REACH. WORLD CLASS.

**160+**  
**YEARS**

BROKERAGE  
EXPERIENCE



INTERNATIONAL  
PRESENCE &  
LOCAL EXPERTISE

**1.2+**  
**MILLION**

SF IN ACTIVE  
LISTINGS

MARKET SHARE  
IN THE INDUSTRY

**+35%**

## ABOUT US

Since 1979, Lee & Associates has reimagined the way that commercial real estate companies should be structured. Each Lee & Associates office is owned and operated by its professionals. As shareholders of the company, this separates us from our competition and creates one common goal; to provide seamless, consistent execution and value-driven market-to-market services to our clients.

Every Lee & Associates office delivers world-class service to an array of regional, national, and international clients - from small businesses and local investors to major corporate users and institutional investors.



*Largest Broker-Owned  
CRE Firm in  
North America*



*Cooperation and  
Collaboration*



*Industrial,  
Commercial,  
and Investment  
Services*

## NATIONWIDE PRESENCE

- |            |           |                        |                  |
|------------|-----------|------------------------|------------------|
| California | Indiana   | District Columbia (DC) | Tennessee        |
| Idaho      | Illinois  | Massachusetts          | North Carolina   |
| Nevada     | Kansas    | Maryland               | South Carolina   |
| Washington | Ohio      | New York               | Canada: Alberta  |
| Arizona    | Michigan  | New Jersey             | British Columbia |
| Colorado   | Minnesota | Pennsylvania           | Ontario          |
| Louisiana  | Missouri  | Florida                |                  |
| Texas      | Nebraska  | Georgia                |                  |

**SEHYUNG KIM**  
Senior Vice President | LIC NO 01327276  
skim@lee-associates.com | 213.290.3599  
[www.skimcre.com](http://www.skimcre.com)