

# EVERGREEN BUSINESS PARK

15,636 Sq. Ft.  
Industrial/Warehouse  
Space For Lease



7205 NE Evergreen Parkway, Hillsboro, OR 97124

**PACTRUST**

### Space Plan | 23' Clear Height

**PacTRUST**

- ▲ Dock Access
- △ Grade Access

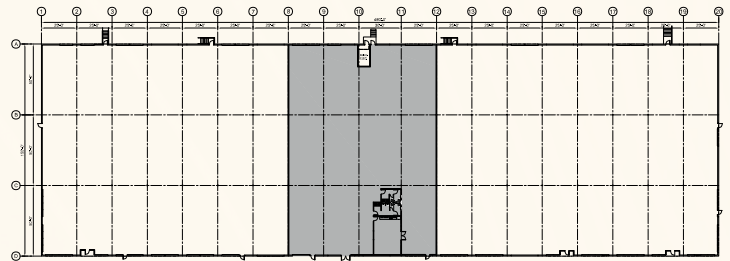
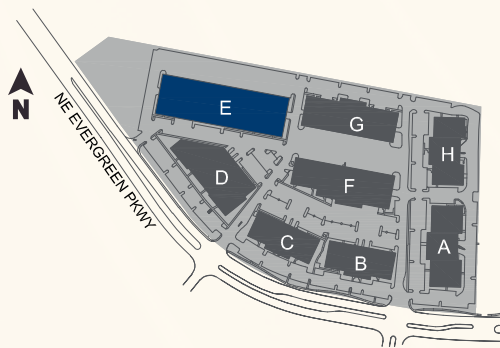
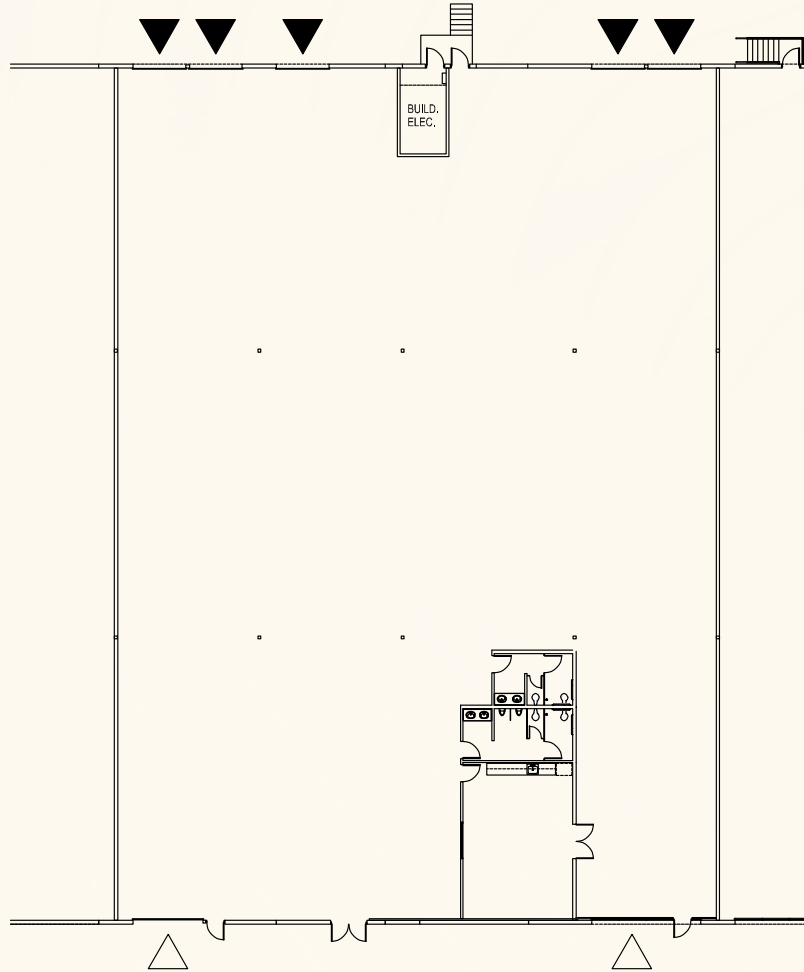

**Building Plan**

Evergreen Business Park  
Industrial/Warehouse  
Space For Lease

# Key Features



15,636 sq. ft shell



880 sq. ft. office



5 dock doors  
2 grade doors

Fully conditioned space

LED on motion sensor lighting

Located in the desirable Hillsboro submarket nearby Intel, Oracle, and Amazon

Less than a mile to US-26 interchange and within 2 miles of a variety of amenities including Orenco Station

Space Available 10.1.26

**Lease Rate:**  
**\$0.95/sq. ft. shell**  
**\$1.20/sq. ft. office**

**NNN Lease**



# Leasing Contacts

Jake Bigby

jakeb@pactrust.com

Caitlin Knecht

caitlink@pactrust.com

503.624.6300

www.pactrust.com

Owned & Managed by

**PacTrust**

Evergreen Business Park  
Industrial/Warehouse  
Space For Lease

7205 NE Evergreen Parkway  
Hillsboro, OR 97124

