

# NORTHWEST SERVICE CENTER



10615 NEWKIRK STREET, SUITE 600 | DALLAS, TEXAS 75220



## PROPERTY HIGHLIGHTS

- Total Building SF: 46,790 RSF
- Available SF: 4,965 SF
- Clear Height: 18'
- Year Built: 1984
- 100% Climate Controlled Warehouse
- Ample Parking
- Professionally Landscaped
- Fully Sprinklered
- 24/7 Security Monitoring
- Strong/Responsive Property Management



**JON SKIDMORE** | 972.442.8942 | [jskidmore@holtlunsford.com](mailto:jskidmore@holtlunsford.com)  
**ANDREW GILBERT** | 972.280.8312 | [agilbert@holtlunsford.com](mailto:agilbert@holtlunsford.com)



This information is deemed reliable, however Holt Lunsford Commercial makes no guarantees, warranties or representation as to the completeness or accuracy thereof.

# NORTHWEST SERVICE CENTER



10615 NEWKIRK STREET, SUITE 600 | DALLAS, TEXAS 75220

## SPACE BREAKDOWN

### SUITE 600

Warehouse	4,256 SF
Office	709 SF
TOTAL AREA	4,965 SF

## SPACE FEATURES

- One (1) Dock High Door
- 18' Clear Height
- Fully Sprinklered

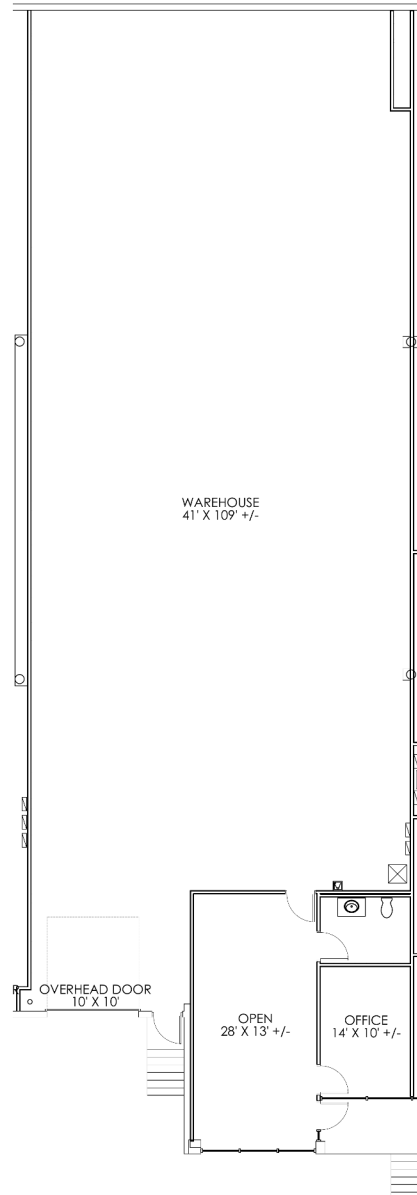

**JON SKIDMORE** | 972.442.8942 | [jskidmore@holtlunsford.com](mailto:jskidmore@holtlunsford.com)  
**ANDREW GILBERT** | 972.280.8312 | [agilbert@holtlunsford.com](mailto:agilbert@holtlunsford.com)



This information is deemed reliable, however Holt Lunsford Commercial makes no guarantees, warranties or representation as to the completeness or accuracy thereof.

