



Rendition used for illustration purposes only

New building adjacent to the Saint-Hubert Airport

- New industrial building to be built offering a leasable area of 22,000 square feet located in Saint-Hubert in the agglomeration of Longueuil.
- Booming sector adjacent to the Montréal-Saint-Hubert-Longueuil Airport.
- Located near Highway 30, alongside Highway 116, offering quick and easy access to the main thoroughfares of the South Shore, including the Trans-Canada Highway.



22,000 square feet of
available space



Available as of the
3rd quarter of 2022



Premises adjacent to the
Saint-Hubert Airport



Property in proximity of
the new Molson brewery

Get more information

Maxime Florio
Commercial Real Estate Broker
maxime.florio@avisonyoung.com
+1 514 392 9476

Gilles St-Amand
Vice President
Chartered Real Estate Broker
gilles.stamand@avisonyoung.com
+1 514 392 9400

Avison Young
800 René-Lévesque Boulevard West
Suite 900
Montréal, Québec H3B 1X9
+1 514 392 1330



Details of the lease

Address	7150 John-Molson Street
Municipality	Saint-Hubert (Longueuil)
Building Area	56,000 sf
Year of Construction	2022
Rentable Area	22,000 sf
Ceiling Height	28 ft
Electrical Input	To be determined
Docks and Doors	To be determined
Availability	3 rd quarter of 2022
Base Rent	To be discussed
Additional Rent	To be discussed

**New building
in the heart of the
Saint-Hubert Airport sector,
which is currently
undergoing solid growth**



**Get more
information**

Maxime Florio
Commercial Real Estate Broker
maxime.florio@avisonyoung.com
+1 514 392 9476

Gilles St-Amand
Vice President
Chartered Real Estate Broker
gilles.stamand@avisonyoung.com
+1 514 392 9400

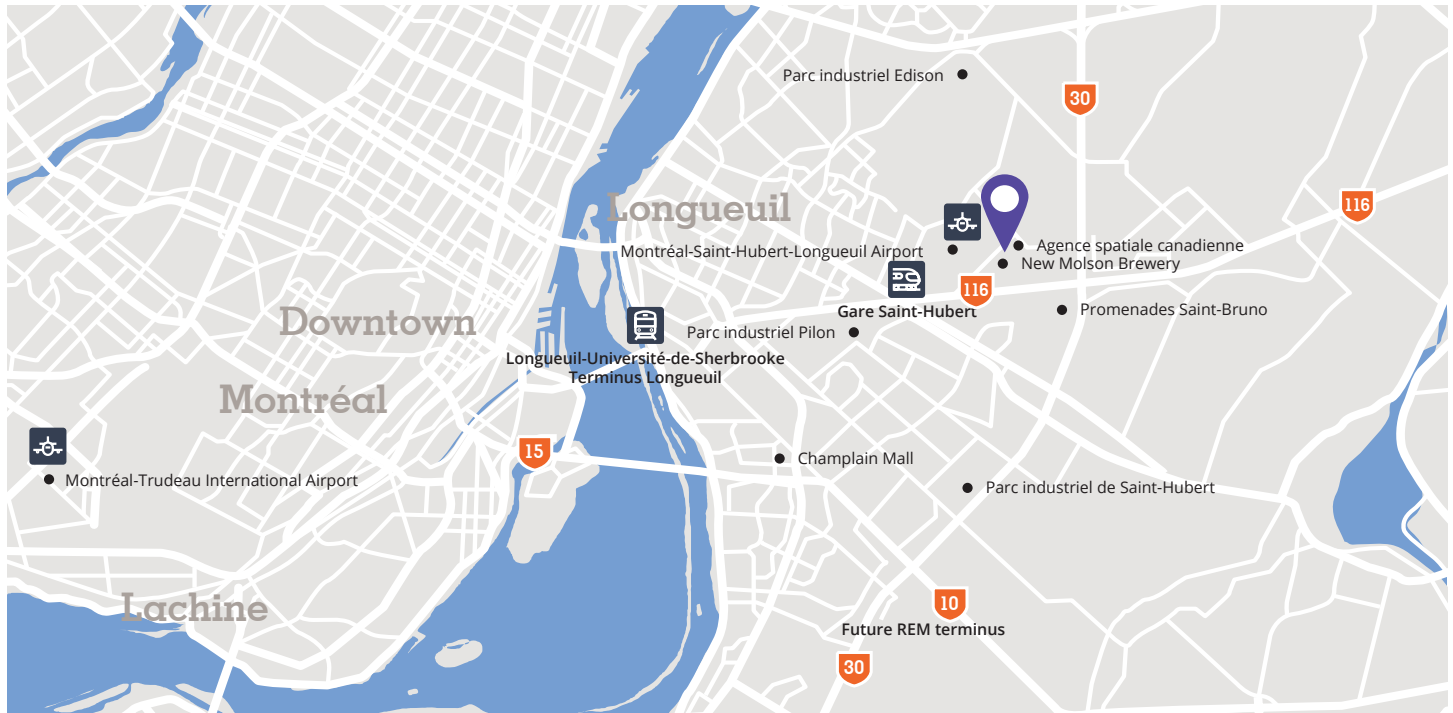

Location

- Excellent road accessibility, near Highway 30, alongside Highway 116, offering quick and easy access to the main arteries of the South Shore, including the Trans-Canada Highway.
- Property adjacent to the Montréal-Saint-Hubert-Longueuil Airport, in an area primarily focused on aerospace, with occupants such as the Canadian Space Agency, Pratt & Whitney Canada and Airmedic nearby, as well as the new Molson Brewery, which is currently under construction.
- The property benefits from the proximity of the Pilon Industrial Park and the Saint-Bruno-de-Montarville Industrial Ecopark, offering good synergy with nearby industrial occupants.



50-minute from Longueuil-Université-de-Sherbrooke station (bus line 28)



50-minute bus ride from Terminus Longueuil (via line 28), offering access to several municipal lines



Near the Saint-Hubert train station of the exo3 commuter train line (Montréal / Mont-Saint-Hilaire)



Adjacent to Montréal-Saint-Hubert-Longueuil Airport



Proximity to major highways, namely Highways 10, 20 and 30 as well as Routes 116 and 132

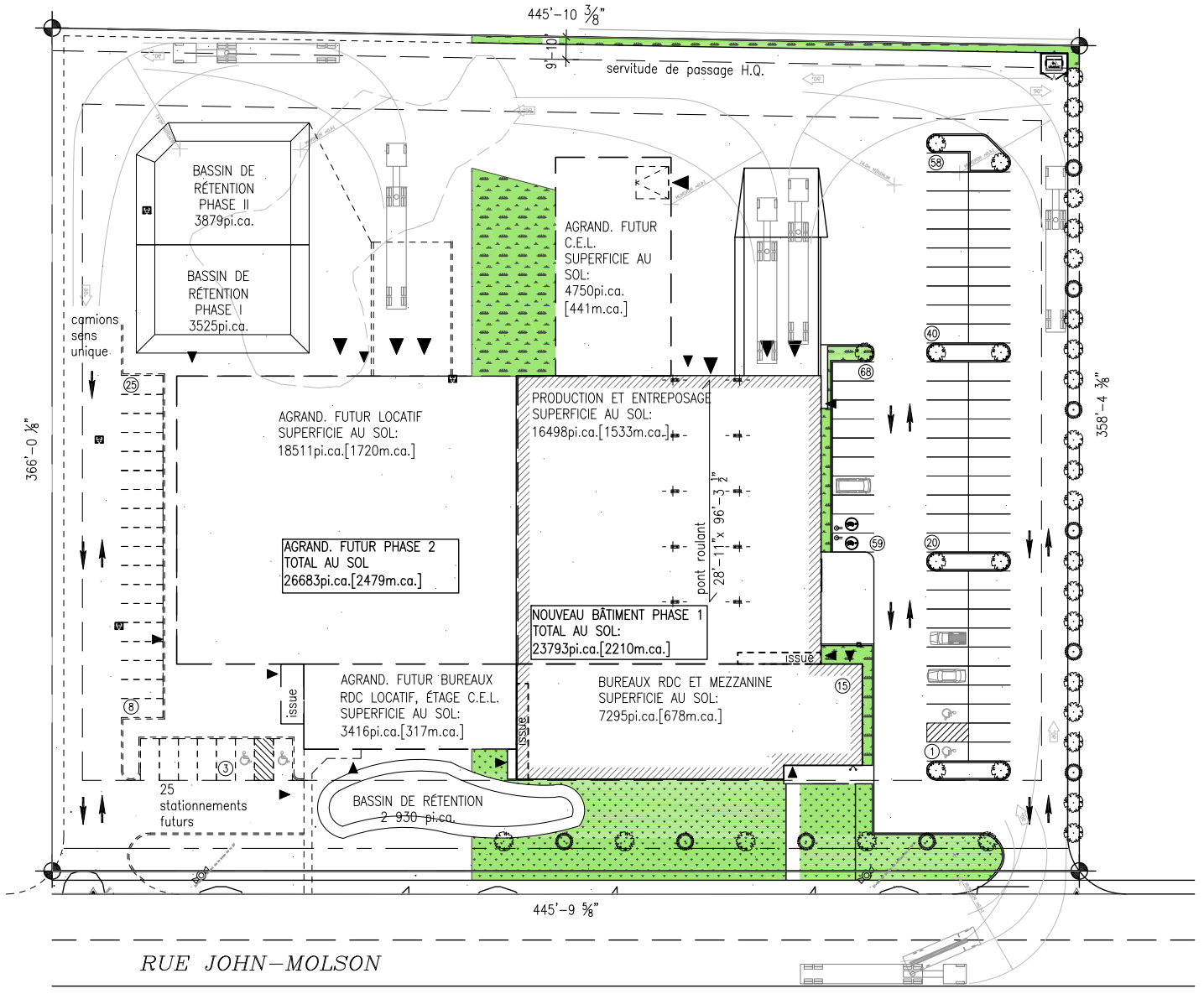

Get more information

Maxime Florio
 Commercial Real Estate Broker
 maxime.florio@avisonyoung.com
 +1 514 392 9476

Gilles St-Amand
 Vice President
 Chartered Real Estate Broker
 gilles.stamand@avisonyoung.com
 +1 514 392 9400



Rendition used for illustration purposes only



Rendition used for illustration purposes only



Rendition used for illustration purposes only

Want to plan a tour? Contact us for more information.

Maxime Florio

Commercial Real Estate Broker
maxime.florio@avisonyoung.com
+1 514 392 9476

Gilles St-Amand

Vice President
Chartered Real Estate Broker
gilles.stamand@avisonyoung.com
+1 514 392 9400

Avison Young

800 René-Lévesque Boulevard W.
Suite 900
Montréal, Québec
H3B 1X9

+1 514 392 1330
avisonyoung.ca