

Penta Pacific Properties

9500 Norwalk Blvd Santa Fe Springs, CA 90670 | 562-699-1922

Available SF 6,232 SF

Industrial For Lease

Building Size 6,232 SF



Address: 9225 Greenleaf Ave, Santa Fe Springs, CA 90670

Cross Streets: Greenleaf Ave/Busch Pl

Attractive Free Standing Building
Oversize Ground Level Doors
Shop Office w/Bonus Mezzanine
Easy Fwy Access - 605/60/5
Available Immediately

Lease Rate/Mo:	\$7,790	Sprinklered:	No	Office SF / #:	475 SF / 2
Lease Rate/SF:	\$1.25	Clear Height:	16'	Restrooms:	2
Lease Type:	Gross	GL Doors/Dim:	2 / 16'x14'	Office HVAC:	
Available SF:	6,232 SF	DH Doors/Dim:	0	Finished Ofc Mezz:	0 SF
Minimum SF:	6,232 SF	A: 200 V: 208/208 O: 3 W: TBD		Include In Available:	No
Prop Lot Size:	0.29 Ac / 12,546 SF	Construction Type:	TILT UP	Unfinished Mezz:	200 SF
Term:	3 - 5 Years	Const Status/Year Blt:	Existing / 1983	Include In Available:	No
Sale Price:	NFS	Whse HVAC:	No	Possession:	Now
Sale Price/SF:	NFS	Parking Spaces: 12 / Ratio: 1.9:1		Vacant:	Yes
Taxes:		Rail Service:	No	To Show:	Call broker
Yard:	Fenced / Paved	Specific Use:	Warehouse/Office	Market/Submarket:	MidCounties
Zoning:	M-2			APN#:	8167-001-036
Listing Company:	Penta Pacific Properties				
Agents:	Greg Jenkins 562-618-9440				
Listing #:	44865237	Listing Date:	05/12/2026	FTCF:	CB250N000S000/A0AA
Notes:	Email: greg@pentapacific.com. Cell: 562-618-9440. Verify Power Information. Free Standing Building.				

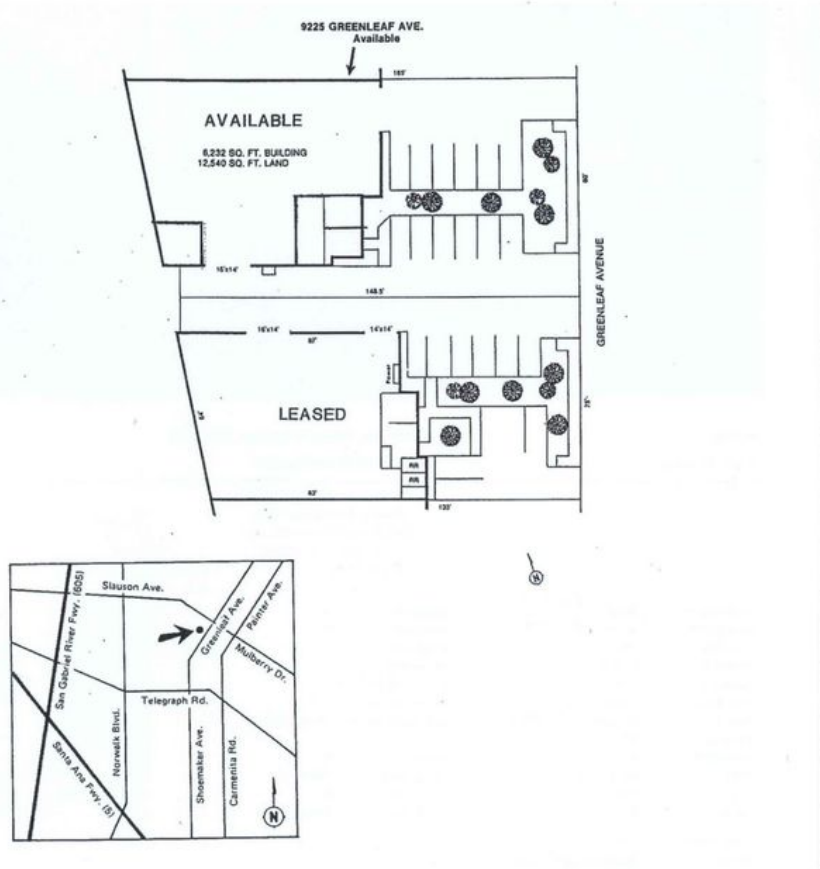

PENTA PACIFIC PROPERTIES
 Greg Jenkins
 greg@pentapacific.com
 562-618-9440



This information supplied herein is from sources we deem reliable. It is provided without any representation, warranty or guarantee, expressed or implied as to its accuracy. Prospective Buyer or Tenant should conduct an independent investigation and verification of all matters deemed to be material, including, but not limited to, statements of income and expenses. Consult your attorney, accountant, or other prof. advisor.

PENTA PACIFIC PROPERTIES
 9500 NORWALK BOULEVARD / SANTA FE SPRINGS, CA 90670 / 562-699-1922
 LICENSE # 00480117
Greg Jenkins
 greg@pentapacific.com
 562-618-9440



This information supplied herein is from sources we deem reliable. It is provided without any representation, warranty or guarantee, expressed or implied as to its accuracy. Prospective Buyer or Tenant should conduct an independent investigation and verification of all matters deemed to be material, including, but not limited to, statements of income and expenses. Consult your attorney, accountant, or other prof. advisor.