

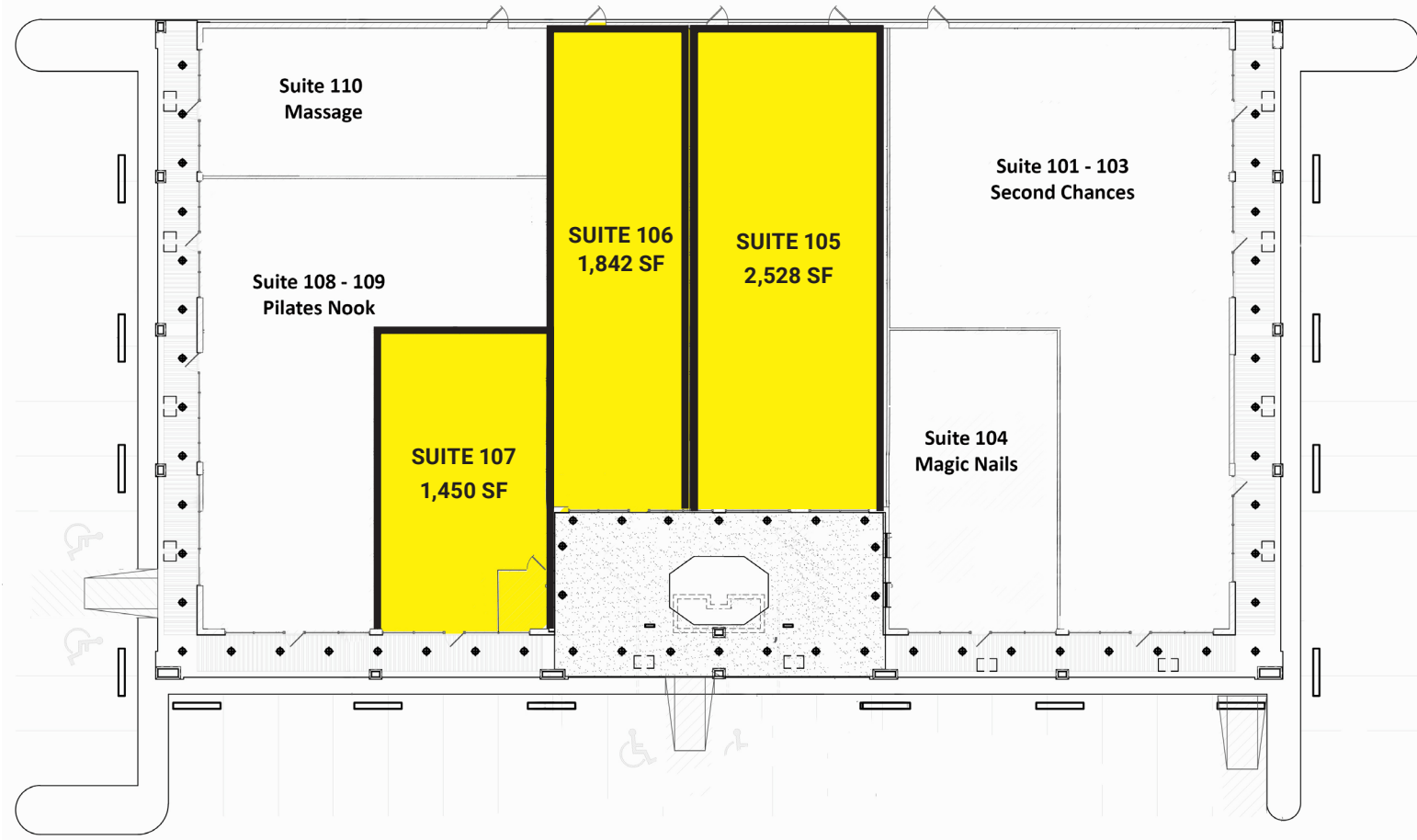

RETAIL

BOULEVARD SQUARE-TURN KEY MEDICAL & RETAIL SUITES | FOR LEASE
3431 S BLVD., EDMOND, OK

THE
RETAIL
GROUP



PROPERTY DETAILS

Building Size	*15,920 SF
Available	
Suite 105	2,528 SF
Suite 106	1,842 SF
Suite 107	1,450 SF
Lease Rate	\$17.00/SF
Additional Rent	\$5.00/SF NNN

PROPERTY HIGHLIGHTS

Surrounded by a robust mix of regional and national retailers

Near the University of Central Oklahoma, with enrollment of 12,500+, and Oklahoma Christian University, with enrollment of 2,700+

Edmond features more than 9.4 million square feet of retail space and more than 200 restaurants

Median household income is \$104,145, compared to \$79,068 for all U.S. households

SNAPSHOT



Estimated Vehicles/Day
S Blvd.
20,020 VPD



Avg. HH Income
5 mi Radius
\$122,478



Population
5 mi Radius
160,958



SITE

20,020 cnd

21,117 cnd

28,943 cnd

31,906 cnd

Penn Square Mall

Lake Heimer

Quail Springs Mall

Auto Mall

Kilpatrick Turnpike 34,761 cnd

Broadway Ext

Boulevard St

33rd Street

**THE
RETAIL
GROUP**

BRANDON BIRDWELL
bbirdwell@newmarkrp.com
C: 405.612.4639

JAY COHLMIA
jaycohlmia@newmarkrp.com
O: 405.602.2989

MICHAEL RAPELLA
mrapella@newmarkrp.com

211 N. Robison, Ste 600N OKC, OK, 73102 | for more information, visit us at
110 W. 7th, Ste 2710 Tulsa, OK, 74119 | **NEWMARKRP.COM**
The information contained herein was obtained from sources believed reliable; however, Newmark
Robinson Park makes no guarantees, warranties or representations as to the completeness or accuracy
thereof. The presentation of this property is submitted subject to errors, omissions, change of price or
conditions prior to sale or lease, or withdrawal without notice. Independently Owned and Operated.

