

The Hideout

Storage Park



**One of the largest and most unique storage communities
in Florida.**

THE HIDEOUT STORAGE PARK ANNOUNCES:

ELITE MOTOR STORAGE CONDOS
PHASE II

195 Basik Drive, Naples, FL 34109



Phase I: Elite Motor Condo Storage

38 Luxury Condo Storage Unit

The Hideout ELITE MOTOR STORAGE Condominiums



Condo Ownership

- ✓ 15' x 30' (10' x 12' Overhead Door)
- ✓ 25' x 55' (14' x 14' Overhead Door)

Concrete Block Construction

A/C, 200 AMPs

(100AMP for 15'X30')

+ Add-Ons:

Bathroom, Loft, Showers, Etc.

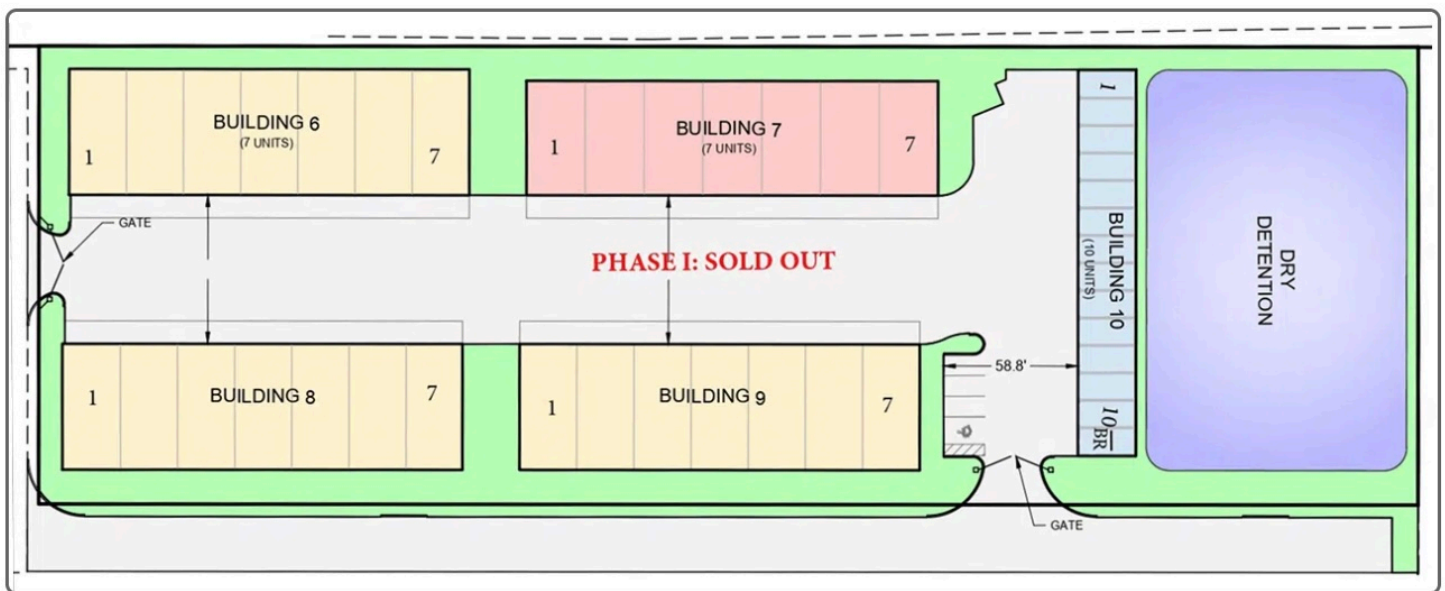

**PHASE I
SOLD OUT**



Phase II: Elite Motor Condo Storage

34 Luxury Condo Storage Unit

The Hideout ELITE MOTOR STORAGE Condominiums



11

Building

Indoor Storage

- ✔ **Unit Dimensions:** 30' x 60' each (6 Units)
- ✔ **Interior Height:** 21
- ✔ **Power:** 50-AMP service
- ✔ **Features:** Air conditioning, 18' (w) x 18' (h) overhead doors, pedestrian door
- ✔ **Options:** Mezzanine, bath/shower, floor finish

Our largest units to date. Perfect for exotic cars, RV and Boats.

12

Building

Indoor Storage

- ✔ **Unit Dimensions:** 30' x 60' each (6 Units)
- ✔ **Interior Height:** 21
- ✔ **Power:** 50-AMP service
- ✔ **Features:** Air conditioning, 18' (w) x 18' (h) overhead doors, pedestrian door
- ✔ **Options:** Mezzanine, bath/shower, floor finish

Our largest units to date. Perfect for exotic cars, RV and Boats.

13

Building

Indoor Storage

- ✔ **Unit Dimensions:** 15' x 32' (9 Units)
- ✔ **Interior Height:** 14
- ✔ **Power:** 100-AMP service
- ✔ **Features:** Air conditioning, 10' x 12' overhead doors, pedestrian door
- ✔ **Options:** Utility Sink

Designed for the cars, boats and trailer storage – balancing security and efficiency with a compact layout.

14

Building

Indoor Storage

- ✔ **Unit Dimensions:** 24' x 40' each (7 Units)
- ✔ **Interior Height:** 16
- ✔ **Power:** 100-AMP service
- ✔ **Features:** Air conditioning, 18' x 12' overhead doors, pedestrian door
- ✔ **Options:** Mezzanine, bath/shower, Floor Finish

The ultimate choice for climate controlled car condos. Uniquely designed. With a lift system you can fit 6 cars in a unit.

PHASE II LAYOUT

(65' Driveway/Aisle)

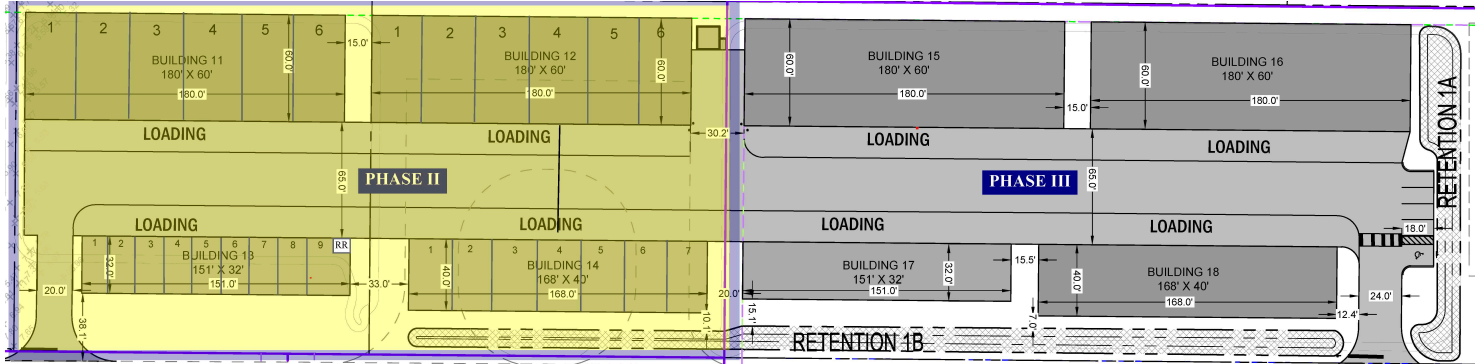

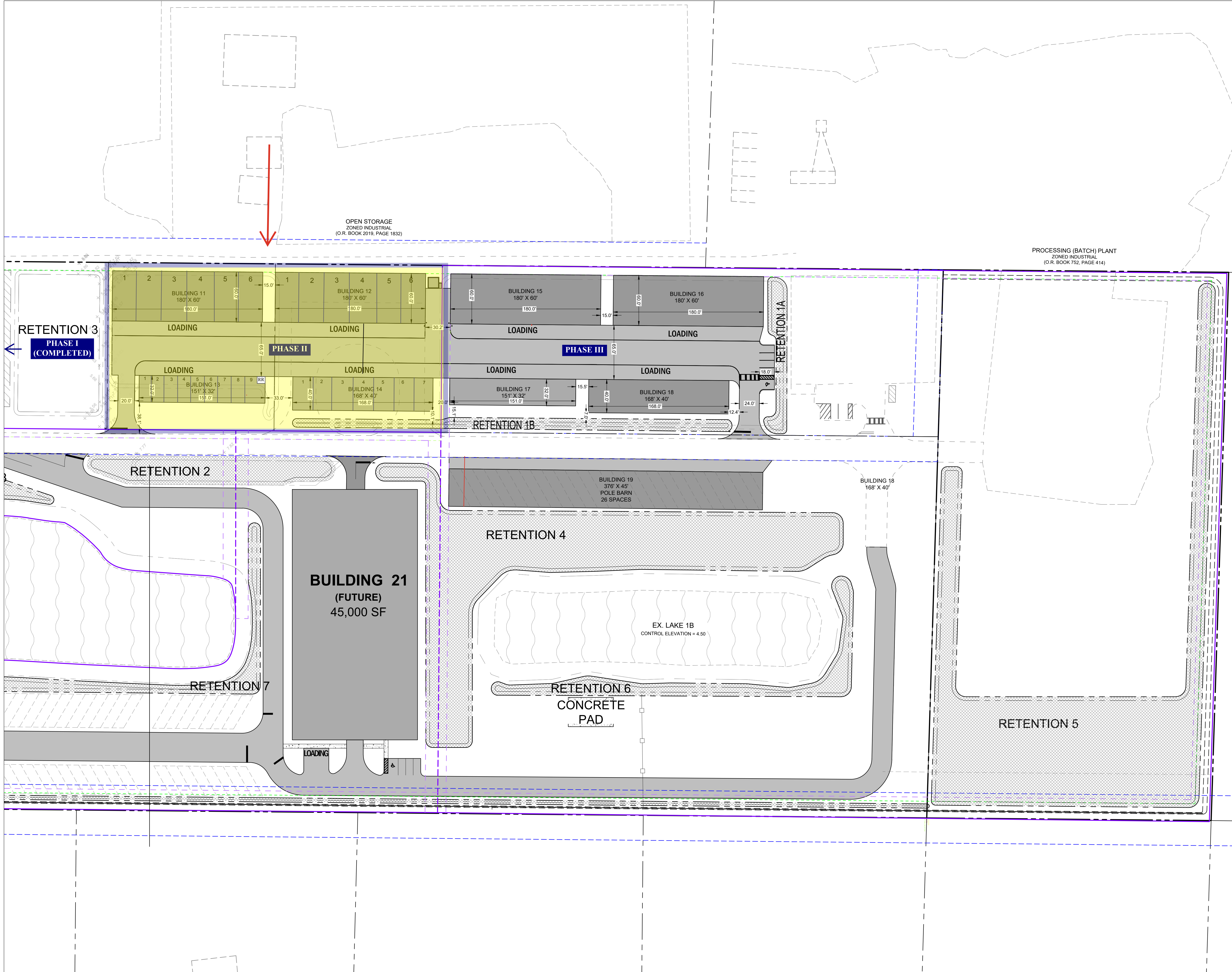

#	DATE	REVISIONS	INITIAL SUBMITTAL DATE: 5-1-25
###	###	###	###
###	###	###	###
###	###	###	###
###	###	###	###



RESERVATION FORM

Name or Entity to Own: _____
Address: _____
City, State: _____
Desired Unit Size (X): _____

PHASE I

PHASE II

Building 11: 30' x 60' Units	<i>Sold Out</i>	_____
Building 12: 30' x 60' Units	\$849,000/Unit (CAM: \$318/m)	_____
Building 13: 15' x 30' Units	\$369,000/Unit (CAM: \$318/m)	_____
Building 14: 24' x 40' Units	\$545,000/Unit (CAM: \$177/m)	_____

Note: Buildings 11, 12, and 14 include step-ups plumbing to rear of units (no bathrooms).

Options: Bathroom w/shower	\$35,500	_____
Epoxy	\$11,500	_____
Mezzanine (Starting at)	\$65,000	_____

\$5,000 reservation fee (refundable) is required to accompany this to reserve either a large and mini-storage unit. Developer will look to convert reservations to contracts within the next month. This reservation does not obligate customer nor developer to enter into a formal sales contract. Funds can be returned to the Purchaser upon request prior to contract.

Escrow deposit checks should be made payable to: **STEVEN J. BRACCI PA RE TRUST ACCOUNT** and mail to their office address: 9015 Strada Stell Court, Suite 102, Naples, Florida 34109. If you wish to wire funds, please contact Steve at 239-596-2635.

**** Please provide an email copy to keith.basik@gmail.com (239)-272-4643****
Prices subject to change without notice.

STEVEN J. BRACCI, PA

****Please call our office to verify wiring instructions before initiating you wire****

Wire Instructions for Steven J. Bracci, PA IOTA Account Real Estate

Ph: (239) 596-2635

Fax: (239) 236-0824

A Professional Association

Attorney at Law

9015 Strada Stell Court, Suite 102

Naples, Florida 34109

Account Name: Steven J. Bracci, PA IOTA Account Real Estate

Bank Name: Regions Bank
201 Milan Parkway
Birmingham, AL 35211

International

Swift Code: UPNBUS44

ABA Number: 062005690

Account #: 0167833543

PHASE I



PHASE I



PHASE I



PHASE I

