

For Lease

1102 Aviation Blvd.

Hebron, KY 41048

98,884 SF



**Rod
MacEachen**

rod@sqftcommercial.com
(513) 675-5764

**Roddy
MacEachen, SIOR**

roddy@sqftcommercial.com
(513) 739-3985

**Jared
Wagoner, SIOR**

jared@sqftcommercial.com
(812) 890-1768

**Matt
Schutte**

matt@sqftcommercial.com
(859) 414-9169

**Amy
Castaneda**

amy@sqftcommercial.com
(503) 310-9768

**Sarah
Kern**

sarah@sqftcommercial.com
(513) 426-4864

**Doug
Lance**

dlance@brennanllc.com
(513) 403-7139

No warranty or representation, expressed or implied, is made as to the accuracy of the information contained herein, and same is submitted subject to error and omissions.

1102 Aviation Blvd.

Hebron, KY 41048

98,884 SF



Property Highlights

- Located in Hebron, KY (Boone County) in the desirable Airport Submarket minutes to I-275 and I-71/75
- 18.81 Total Acres
- Building and truck court are expandable with possible outdoor/trailer storage
- Building is divisible and can Accommodate Two (2) ~50K SqFt Tenants
- 480-volt, 3-phase, approximately 4,000 amps
- Five (5) docks (expandable) and three (3) drive-in doors
- Corporate Headquarters Type Environment with 190 Striped Parking Spaces
- Available Q1 2026
- Lease Rate: Negotiable
- OpEx/CAM: Approximately \$1.00/SqFt
- Sale Price: Negotiable

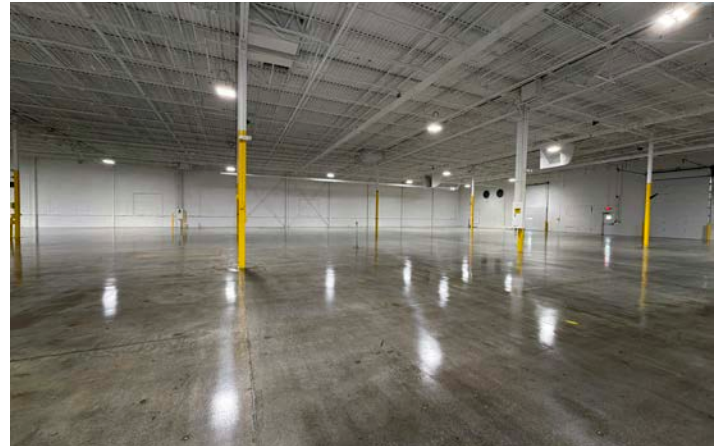

[Click Here For Aerial Video](#)

[Click Here For the 360° tour](#)

Total SqFt:	98,884
Warehouse SqFt:	82,311
Office SqFt:	16,573
Acreage:	18.81 acres
Clear Height:	20'-22'
Year Built:	1994
Type Construction:	Concrete
Lighting:	LED
Column Spacing:	35' x 45'
Dock door:	Five (5), with ability to expand
Drive-in door:	Three (3)

Sprinkler:	Yes-Wet System
Electrical Service:	480-volts, 3-phase, approximately 4,000-amps
Heat:	Gas Heat in Warehouse, full hvac in office
Roof:	New (replaced 2025)
Truck Court:	170'
Parking Lot:	One hundred Ninety (190) spaces
Restrooms:	Two Sets in Offices, Two Sets in Warehouse (One locker room)
Boone County Parcel ID:	047.00-08-002.00

For Lease

1102 Aviation Blvd.

Hebron, KY 41048

98,884 SF



No warranty or representation, expressed or implied, is made as to the accuracy of the information contained herein, and same is submitted subject to error and omissions.

1102 Aviation Blvd.

Hebron, KY 41048





98,884 SF

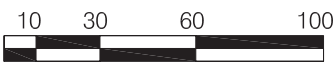
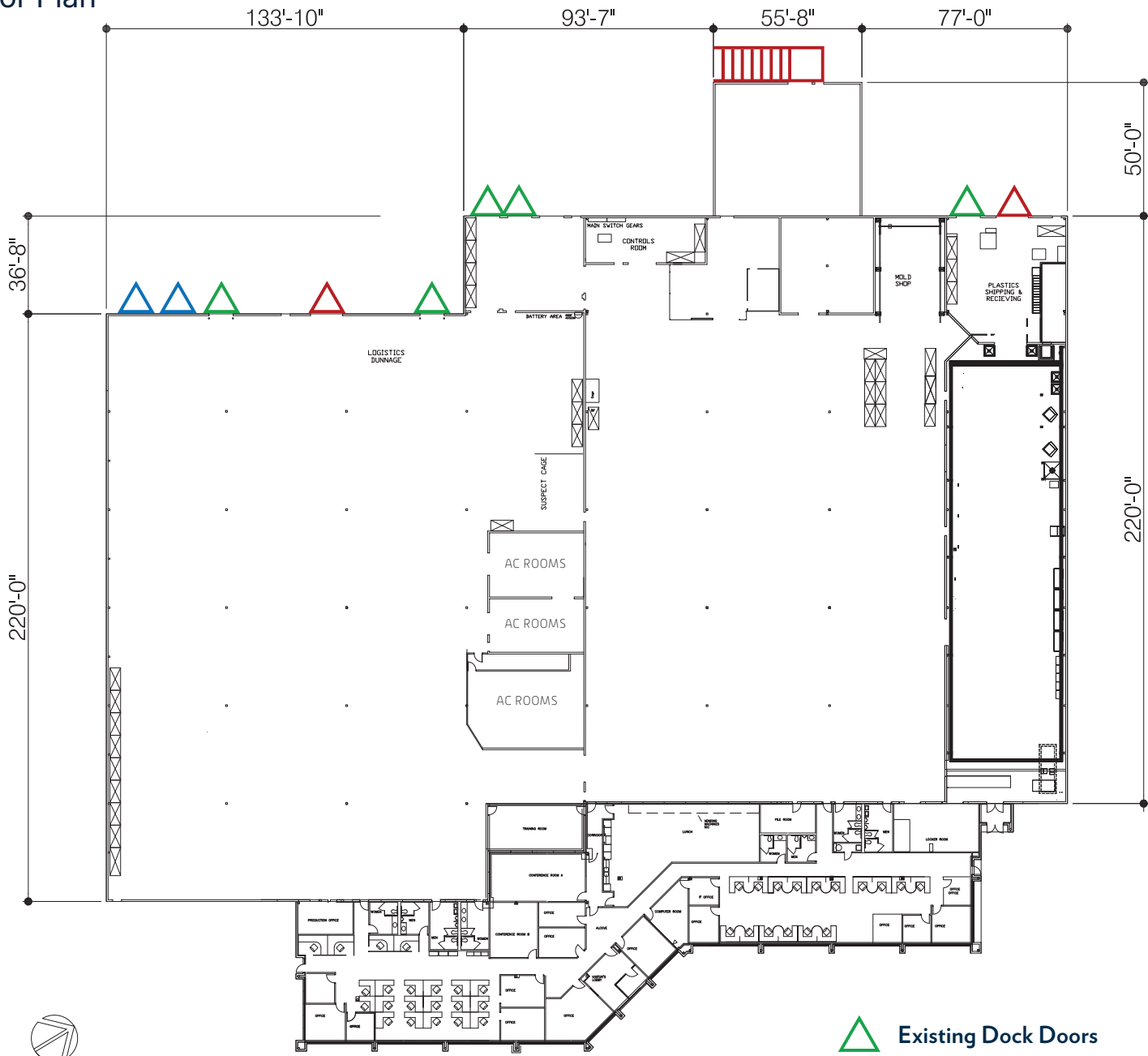

Floor Plan



OFFICE	16,573 SF
WHSE	82,311 SF
TOTAL	98,884 SF

-  Existing Dock Doors
-  Future Dock Expansion
-  Ramp/Drive-in Door
-  Drive-in Doors

For Lease

1102 Aviation Blvd.

Hebron, KY 41048

98,884 SF



No warranty or representation, expressed or implied, is made as to the accuracy of the information contained herein, and same is submitted subject to error and omissions.

For Lease

1102 Aviation Blvd.

Hebron, KY 41048

98,884 SF

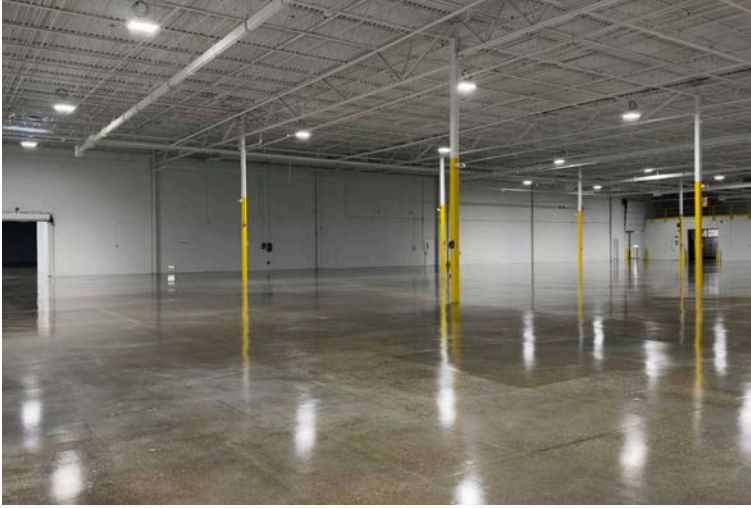
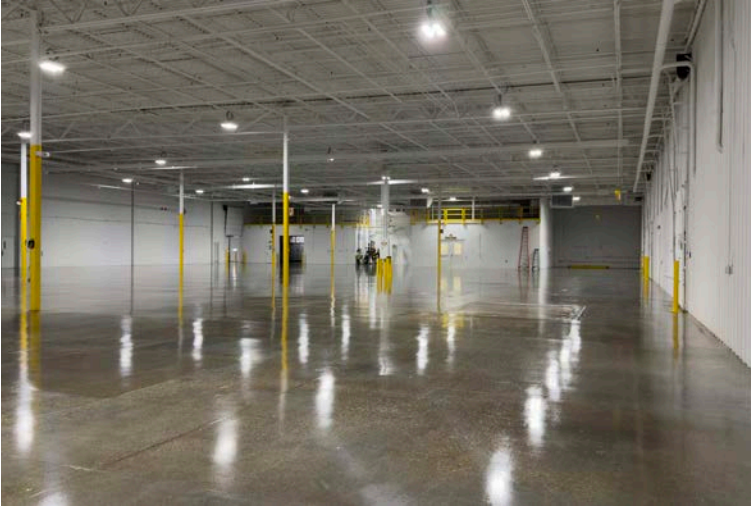

No warranty or representation, expressed or implied, is made as to the accuracy of the information contained herein, and same is submitted subject to error and omissions.

For Lease

1102 Aviation Blvd.

Hebron, KY 41048

98,884 SF

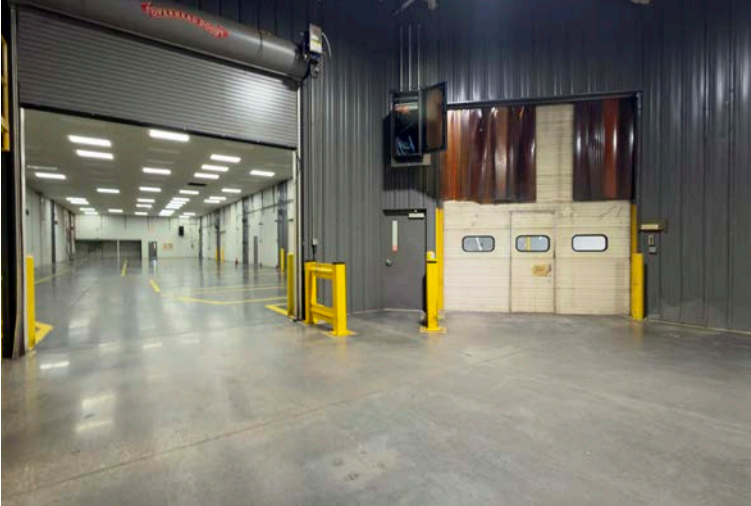

No warranty or representation, expressed or implied, is made as to the accuracy of the information contained herein, and same is submitted subject to error and omissions.