

SUNSET PARK, BROOKLYN NY

737 4TH AVENUE

MOD



SPACE DETAILS

LOCATION

Between 24th and 25th Streets

SPACE

Retail A: 2,008 SF

Retail B: 769 SF

Retail C: 2,147

POSSESSION

Immediete

ASKING RENT

Upon Request

NEIGHBORS

Industry City, Costco Wholesale, Starbucks, Dunkin', Walgreens, CVS, TD Bank, Chase Bank, McDonald's, Taco Bell, Planet Fitness, Sunset Park Diner

TRANSPORTATION



COMMENTS

- Prime new construction retail at the base of a 187-unit residential building
- Open to logical divisions
- All uses to be considered
- Dunkin Donuts recently signed in the building

CONTACTS

MEYER DAGMY

718-249-3613

m@modcre.com

EDDIE MAMIYE

917-379-6719

e@modcre.com

ISAAC BIJOU

718-594-6377

ib@modcre.com



2774 CONEY ISLAND AVE, BROOKLYN, NY 11235

©2026MODCommercialRealtyLLC.Allinformationprovidedis deemed reliable, but is not guaranteed and should be independently verified.

FLOOR PLAN

Ground Floor

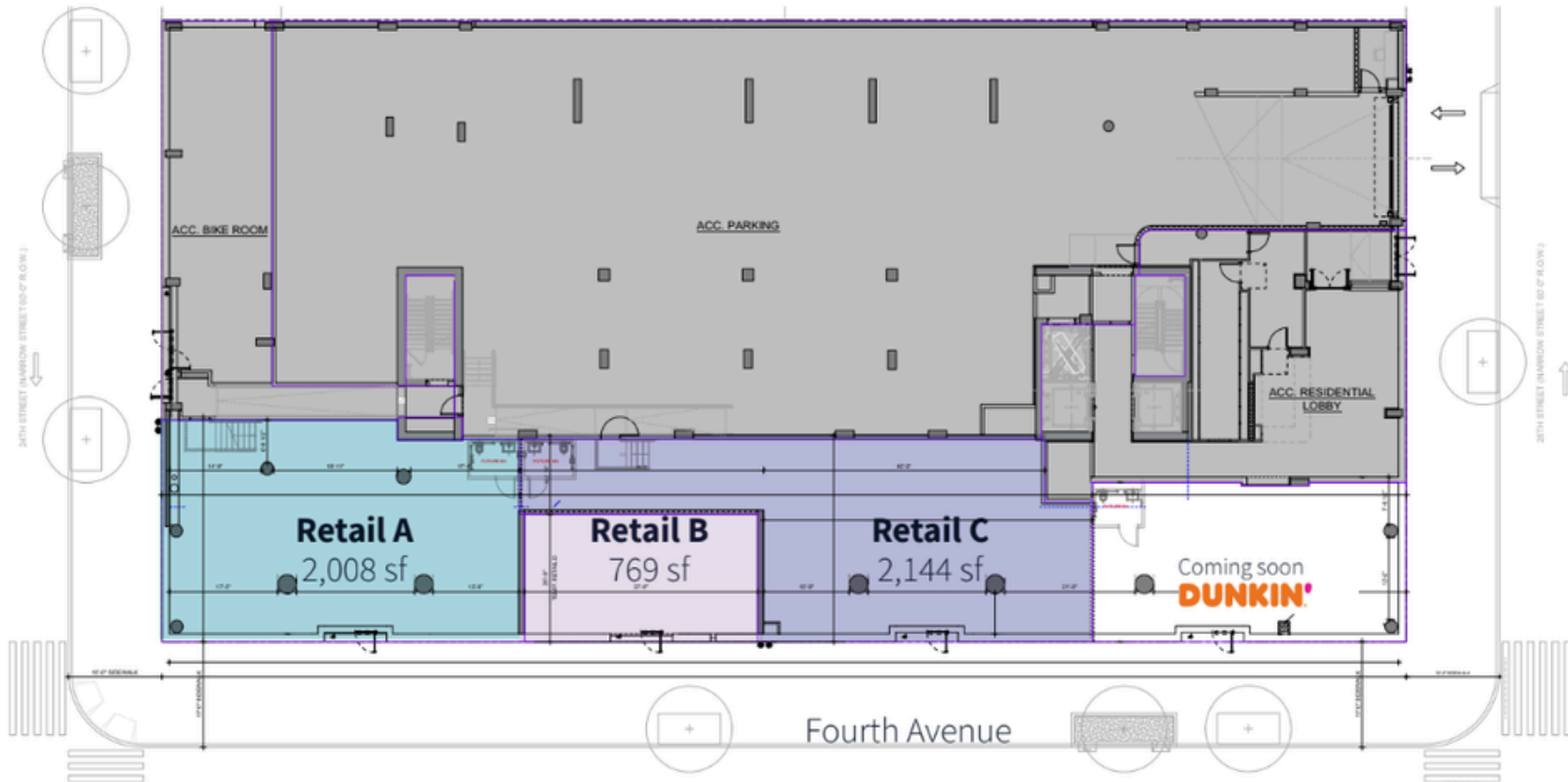

CONTACTS

MEYER DAGMY

718-249-3613

m@modcre.com

EDDIE MAMIYE

917-379-6719

e@modcre.com

ISAAC BIJOU

718-594-6377

ib@modcre.com



2774 CONEY ISLAND AVE, BROOKLYN, NY 11235

©2026MODCommercialRealtyLLC.Allinformationprovidedis deemed reliable, but is not guaranteed and should be independently verified.

AREA MAP

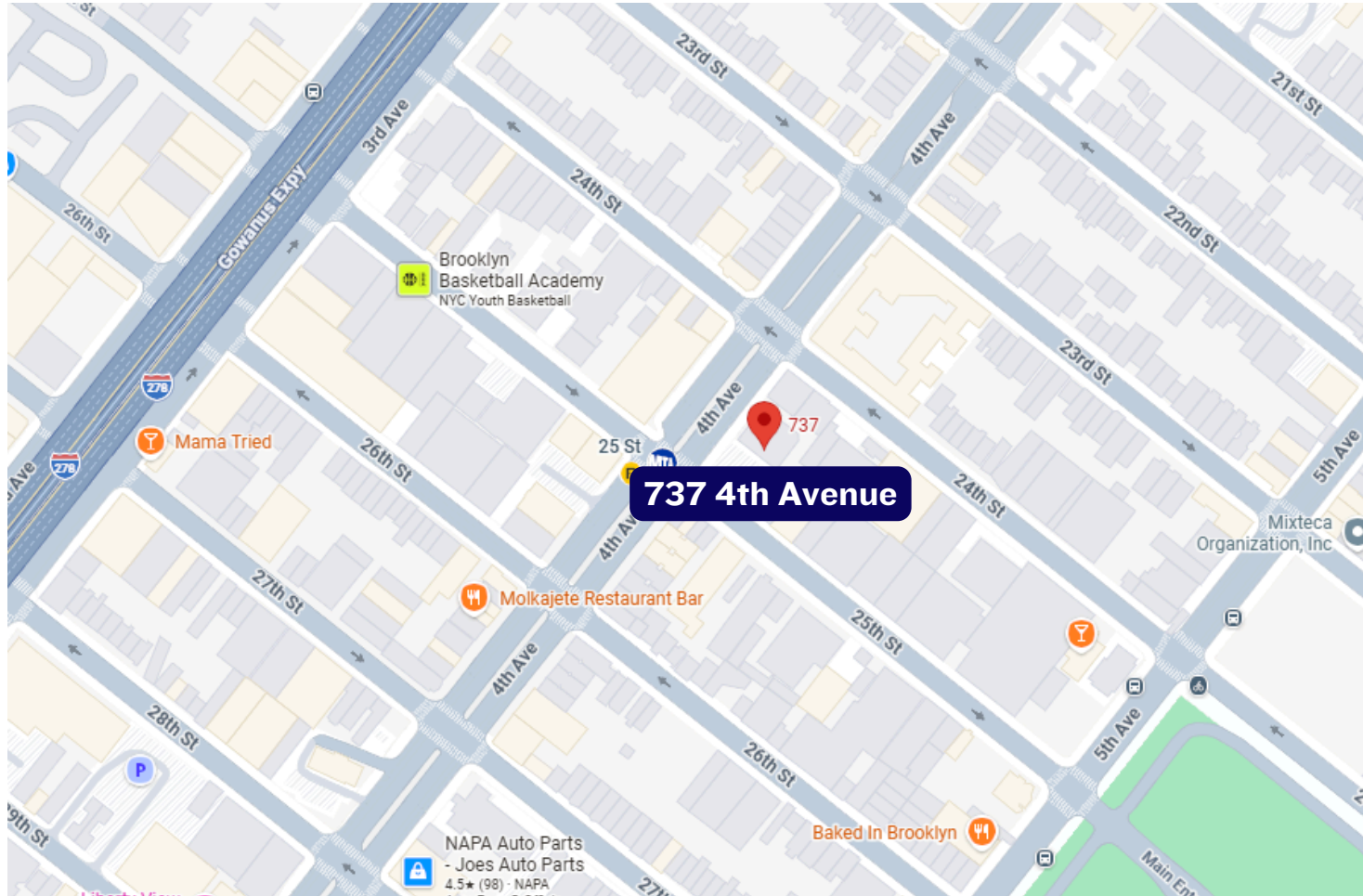

CONTACTS

MEYER DAGMY

718-249-3613

m@modcre.com

EDDIE MAMIYE

917-379-6719

e@modcre.com

ISAAC BIJOU

718-594-6377

ib@modcre.com



2774 CONEY ISLAND AVE, BROOKLYN, NY 11235

©2026MODCommercialRealtyLLC.Allinformationprovidedis deemed reliable, but is not guaranteed and should be independently verified.