

**AVAILABLE FOR LEASE**  
**200 RITTENHOUSE CIR**  
**BRISTOL, PENNSYLVANIA**



**FOUR (4) BUILDING INDUSTRIAL**

**5,400 - 11,353 SF AVAILABLE**



**CONTACT**

**JEFF LICHT, SIOR**  
+1 215 396 2900 ext 101  
jeff.licht@naimertz.com

**JARED LICHT**  
+1 215 396 2900 ext 105  
jared.licht@naimertz.com

**SCOTT MERTZ, SIOR**  
+1 609 413 5647  
scott.mertz@naimertz.com



OWNED BY



# CURRENT AVAILABILITIES

200 RITTENHOUSE CIRCLE BRISTOL, PA

## NORTH BUILDING

	SF	CEILING HEIGHT	LOADING	OFFICE AREA
UNIT 1	5,953	13'3" - 14'6"	2 DI	510 SF
UNIT 2	5,400	13'3" - 14'6"	1 DI	745 SF

\* Units can be combined for 11,353 SF contiguous space

## WEST BUILDING

	SF	CEILING HEIGHT	LOADING	OFFICE AREA
UNIT 1 & 2	7,812	18'	2 TG, 2 DI	

## EAST BUILDING

FULLY LEASED

## SOUTH BUILDING

FULLY LEASED



## CONTACT

**JEFF LICHT, SIOR**  
+1 215 396 2900 ext 101  
jeff.licht@naimertz.com

**JARED LICHT**  
+1 215 396 2900 ext 105  
jared.licht@naimertz.com

**SCOTT MERTZ, SIOR**  
+1 609 413 5647  
scott.mertz@naimertz.com



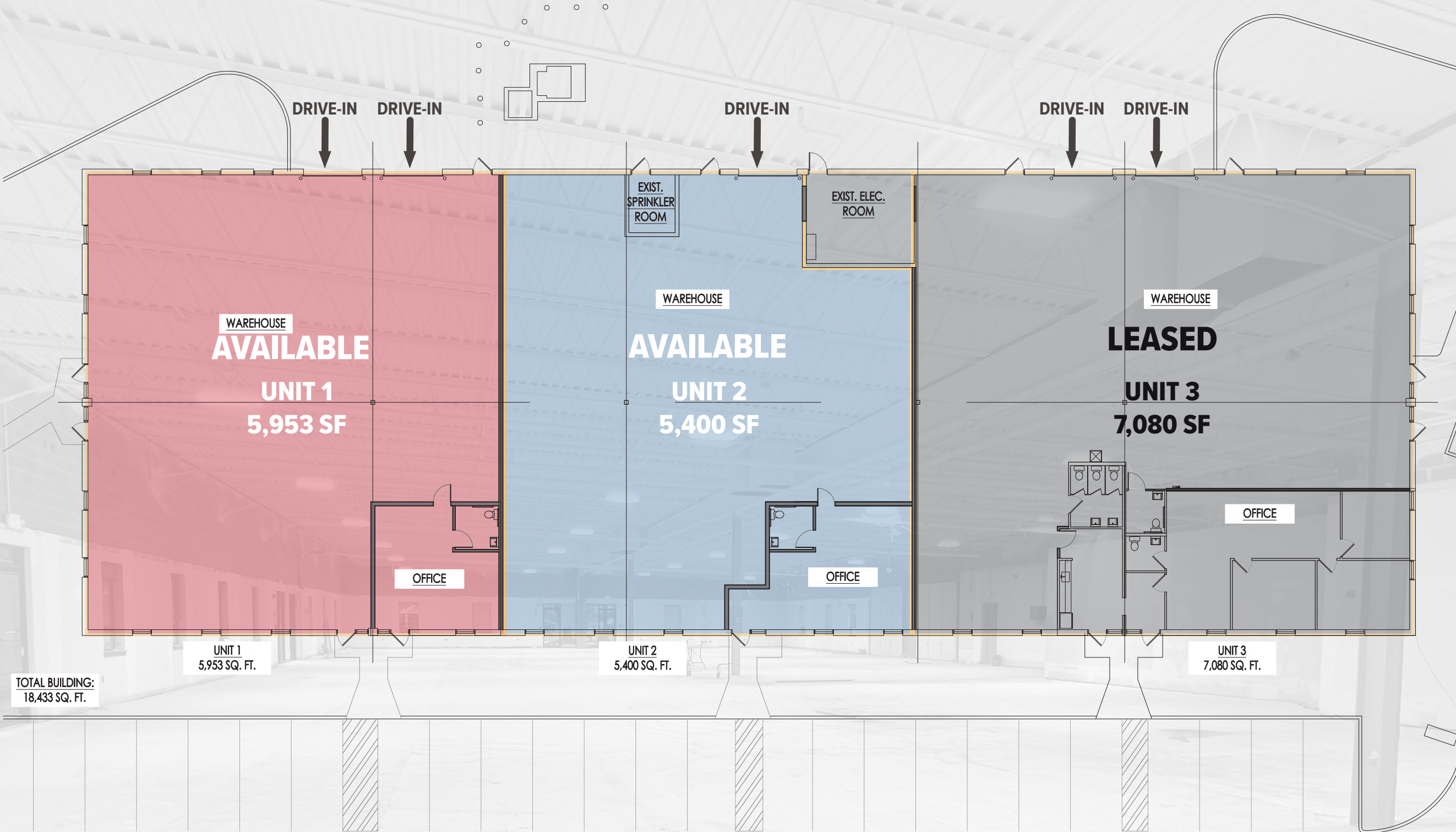

**CONTACT**

**JEFF LICHT, SIOR**  
+1 215 396 2900 ext 101  
jeff.licht@naimertz.com

**JARED LICHT**  
+1 215 396 2900 ext 105  
jared.licht@naimertz.com

**SCOTT MERTZ, SIOR**  
+1 609 413 5647  
scott.mertz@naimertz.com



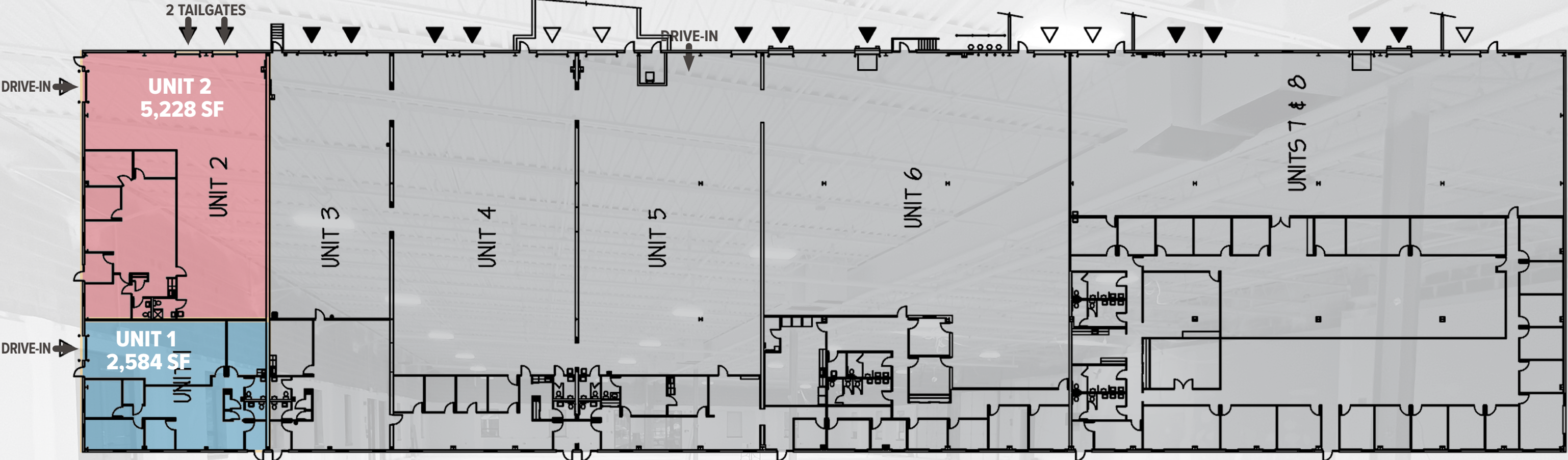

**CONTACT**  
**JEFF LICHT, SIOR**  
 +1 215 396 2900 ext 101  
 jeff.licht@naimertz.com

**JARED LICHT**  
 +1 215 396 2900 ext 105  
 jared.licht@naimertz.com

**SCOTT MERTZ, SIOR**  
 +1 609 413 5647  
 scott.mertz@naimertz.com



# LOCATION INFORMATION

200 RITTENHOUSE CIRCLE BRISTOL, PA



## DISTANCE TO:

I-95	0.7 mi	PA Turnpike (West)	4.4 mi
Route 13	1.8 mi	NJ Turnpike	5.2 mi
PA Turnpike (East)	2.6 mi	Center City Philadelphia	20 mi

## CONTACT

**JEFF LICHT, SIOR**

+1 215 396 2900 ext 101  
jeff.licht@naimertz.com

**JARED LICHT**

+1 215 396 2900 ext 105  
jared.licht@naimertz.com

**SCOTT MERTZ, SIOR**

+1 609 413 5647  
scott.mertz@naimertz.com



OWNED BY

**Camber  
Real Estate  
Partners**

**MP** **MARCUS  
PARTNERS**