

# OFFICE/MEDICAL FOR LEASE

## VICTORIA MEDICAL ARTS BUILDING

701-703 E. MAIN STREET, MOORESTOWN, NJ



**TWO BUILDING MEDICAL OFFICE COMPLEX**

**SUITES AVAILABLE FROM 750-1,950 SF**

### CONTACT

REBECCA TING, SIOR  
+1 856 234 9600  
rebecca.ting@naimertz.com

JULIE KRONFELD  
+1 856 802 6516  
julie.kronfeld@naimertz.com



# PROPERTY DETAILS

701-703 E. MAIN STREET MOORESTOWN, NJ

## CURRENT AVAILABILITIES

### 701 E. MAIN STREET

SUITE 2 764± SF

SUITE 4\* 748± SF

SUITE 5\* 1,220± SF

SUITE 9 1,088± SF

\* Can be combined for 1,968± SF

- 20,000± SF, two building office / medical complex
- Suites available for lease from 748 - 1,968± SF
- Easily accessible from Route 38 and I-295
- Close proximity to Centerton Square shopping center featuring numerous retailers and restaurants

### 703 E. MAIN STREET

**FULLY LEASED**



## CONTACT

REBECCA TING, SIOR  
+1 856 234 9600  
rebecca.ting@naimertz.com

JULIE KRONFELD  
+1 856 802 6516  
julie.kronfeld@naimertz.com



# FLOOR PLAN

701-703 E. MAIN STREET MOORESTOWN, NJ

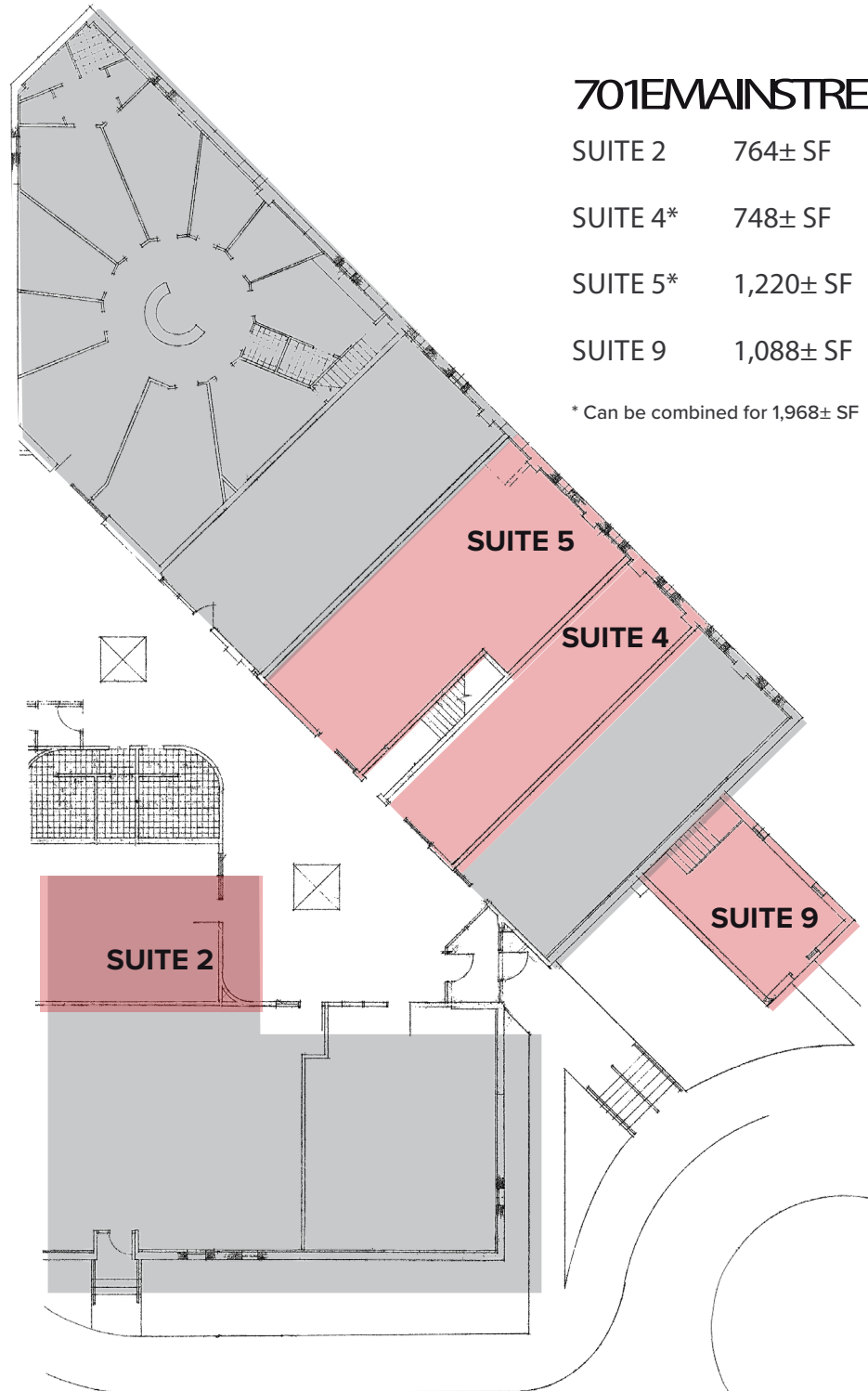

## 701 E MAIN STREET

SUITE 2 764± SF

SUITE 4\* 748± SF

SUITE 5\* 1,220± SF

SUITE 9 1,088± SF

\* Can be combined for 1,968± SF

SUITE 5

SUITE 4

SUITE 9

SUITE 2

## CONTACT

REBECCA TING, SIOR

+1 856 234 9600

rebecca.ting@naimertz.com

JULIE KRONFELD

+1 856 802 6516

julie.kronfeld@naimertz.com



# SUITE 5

701-703 E. MAIN STREET MOORESTOWN, NJ



Reception Area



Exam Room



Exam Room



Private Office

## CONTACT

REBECCA TING, SIOR  
+1 856 234 9600  
rebecca.ting@naimertz.com

JULIE KRONFELD  
+1 856 802 6516  
julie.kronfeld@naimertz.com



# LOCATION INFORMATION

701-703 E. MAIN STREET MOORESTOWN, NJ



## DISTANCE TO:

Route 38	0.5 mi
Centerton Square	0.5 mi
I-295 (Exit 40)	1.0 mi
NJ Turnpike (Exit 4)	5.3 mi
Center City Philadelphia	13.5 mi



## CONTACT

REBECCA TING, SIOR  
+1 856 234 9600  
rebecca.ting@naimertz.com

JULIE KRONFELD  
+1 856 802 6516  
julie.kronfeld@naimertz.com

