

# 110

**COPPER CREEK DR, MARKHAM**  
**UPPER-LEVEL COMMERCIAL SPACE AVAILABLE FOR LEASE**



# Property Highlights



## High-Traffic Strategic Location

Well-located medical office space within a purpose-built, multi-story facility serving the growing Box Grove community. Situated in a dense, rapidly growing residential neighborhood with a built-in patient base and long-term service demand.



## Established Healthcare Community

Features a strong roster of healthcare tenants, including 24/7 urgent care and diagnostic services, providing excellent referral synergy.



## Superior Branding & Visibility

Exceptional visibility and easy access for patients and practitioners at the corner of Copper Creek Drive and Ninth Line.



## Strategic Daily-Needs Destination

Located in a prominent plaza with ample surface parking, the site features a premier mix of established name-brand tenants, including Longo's, LCBO, and Mandarin, alongside pharmacies such as Guardian and Rexall.



# Property Detail



Available Unit	Unit Size	Net Rent	TMI (2026)	Possession Date	Parking
Unit 203	2,853 Sq. Ft.	\$19.50 Per Sq. Ft.	\$14.32 Per Sq. Ft.	Immediate	Surface
Unit 301	5,704 Sq. Ft.				
Unit 400	9,394 Sq. Ft.				
Unit 401	1,482 Sq. Ft.				

# Unit 203 - Floor Plan

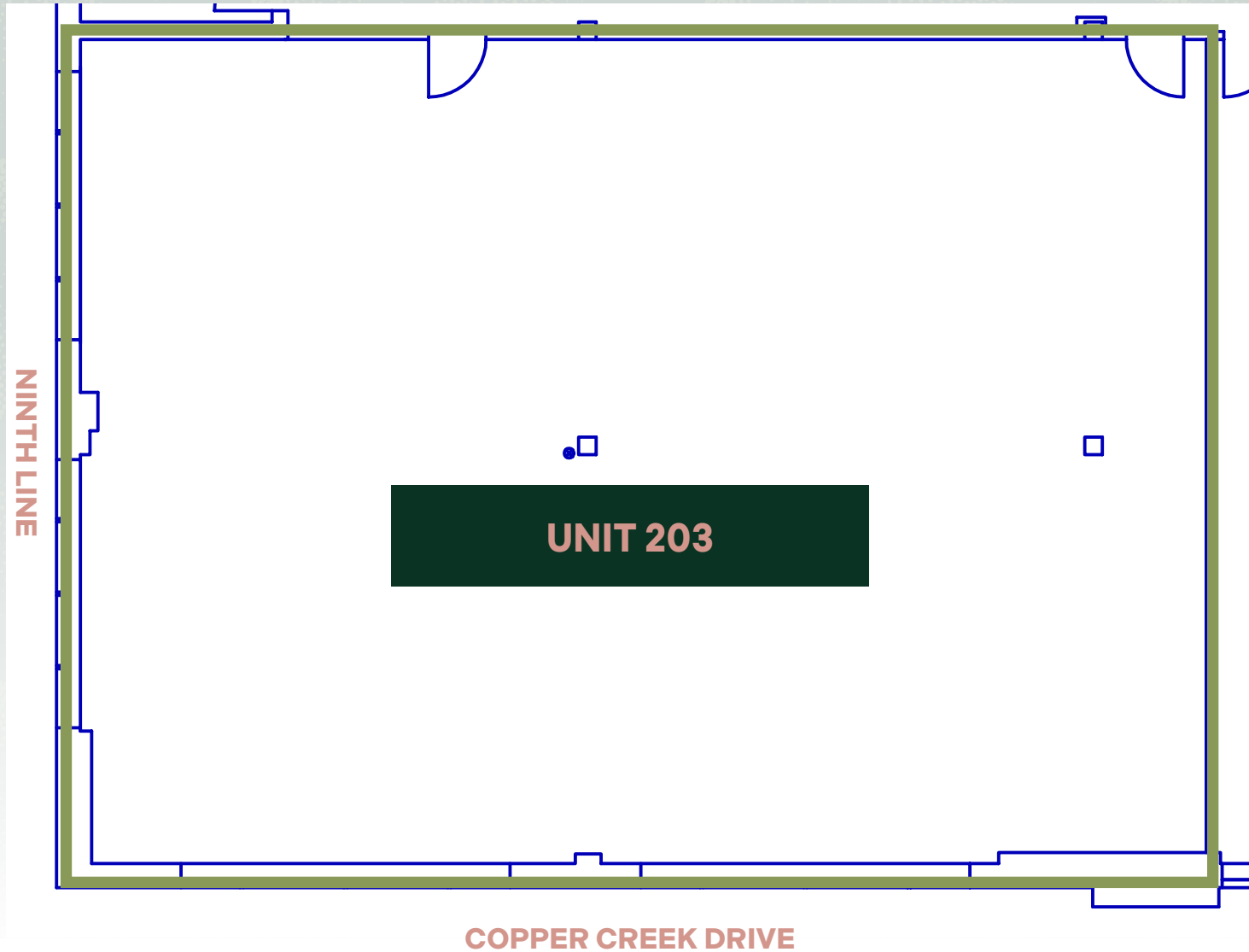

# Unit 301 - Floor Plan

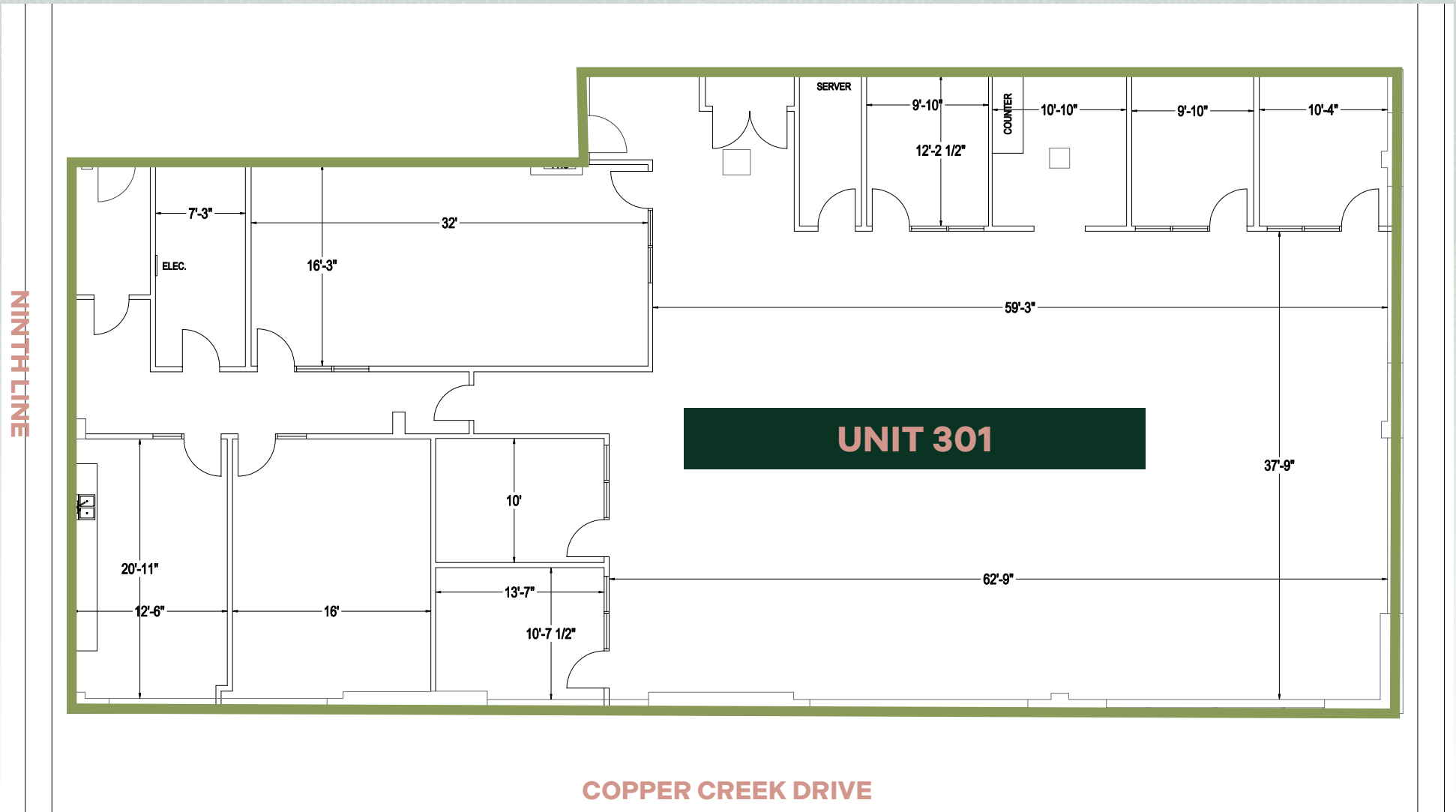

# Unit 400&401 - Floor Plan

NINTH LINE

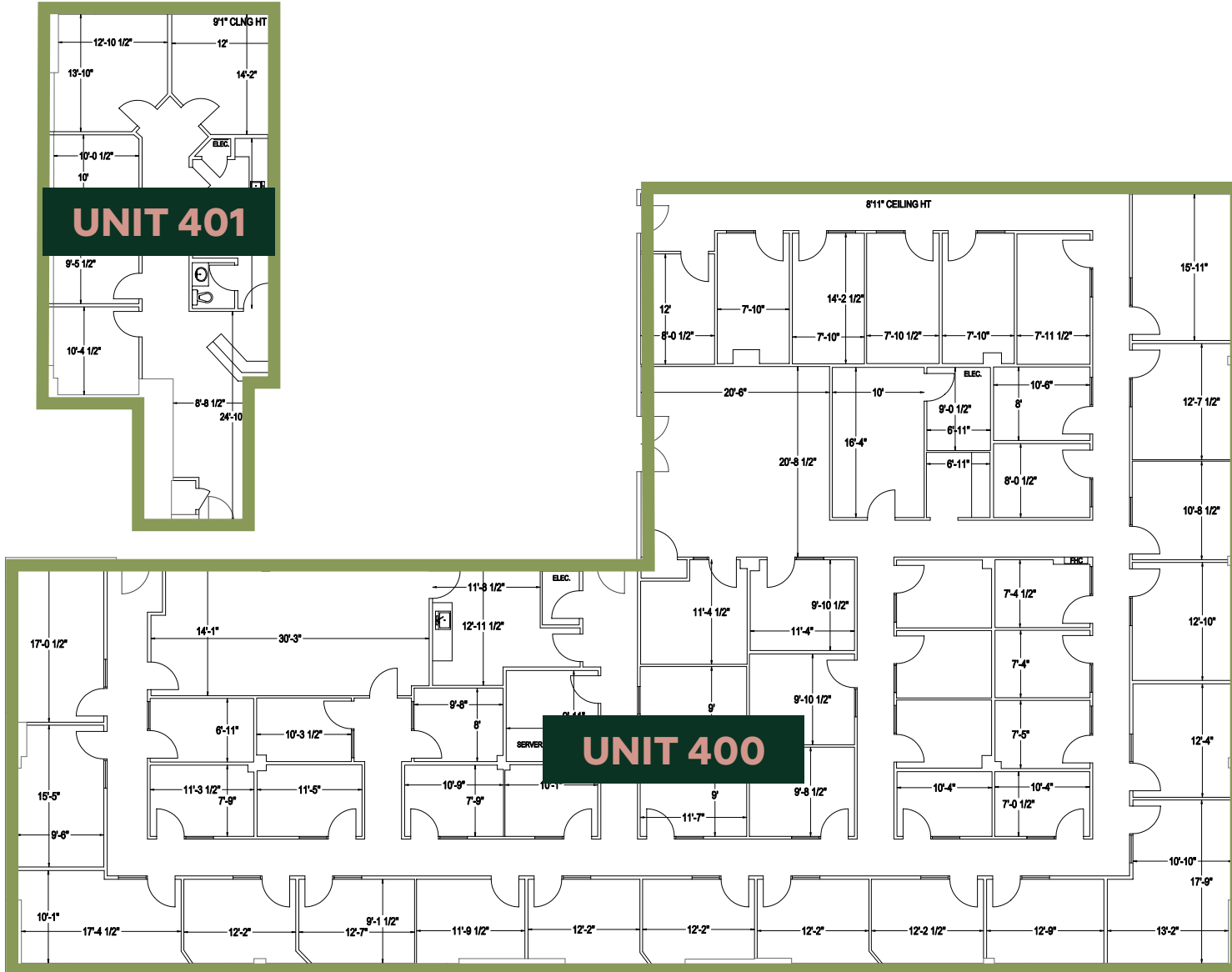

COPPER CREEK DRIVE

# Site Plan

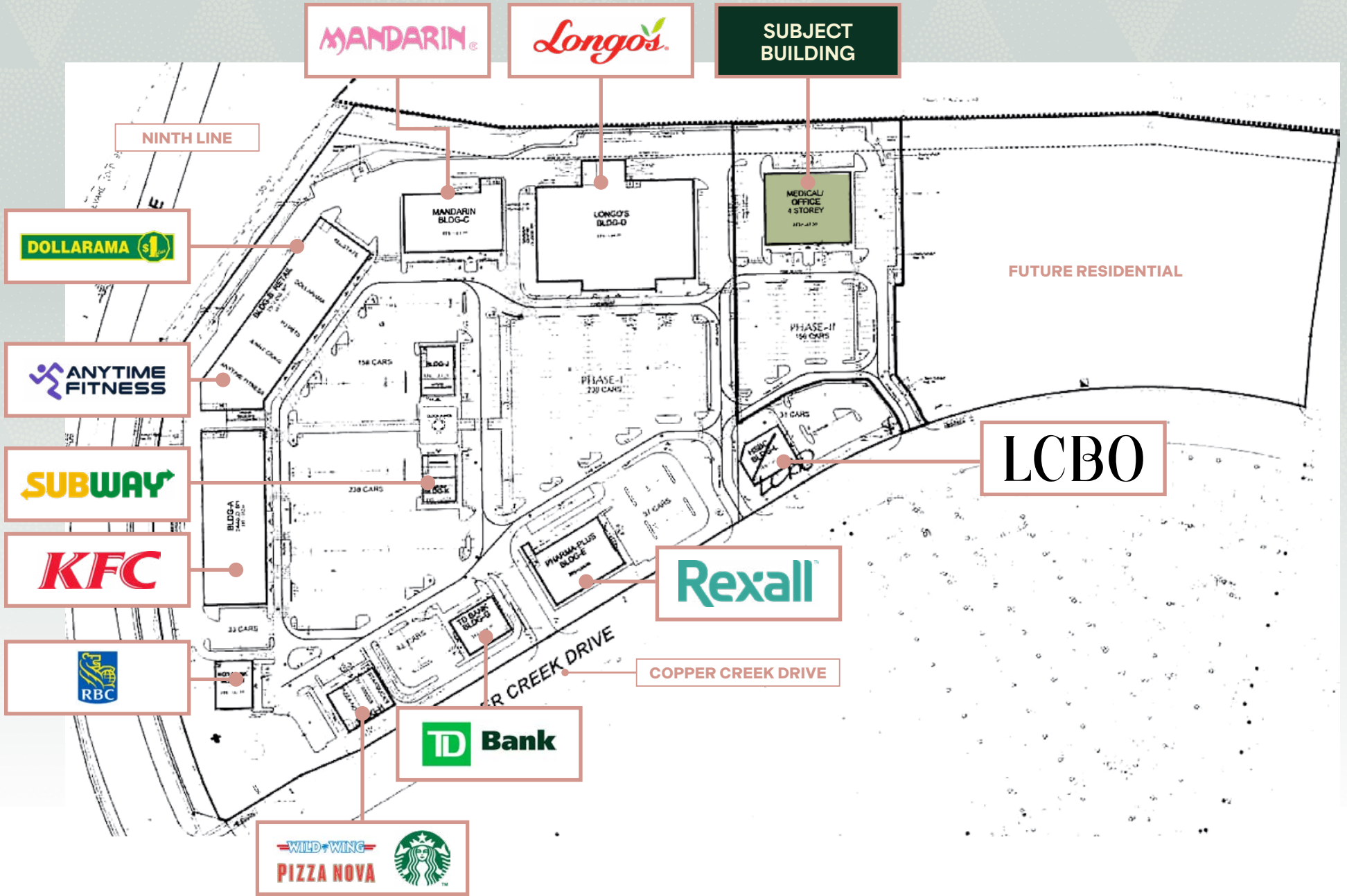



**SITE PHOTOS**



# Amenities & Location



DAILY TRAFFIC COUNT

**6,592,173**

Hwy 407 (2025 December Est.)

**17,457**

Ninth Line

Major Street

MARKHAM RD

HWY 407

NINTH LINE



Walmart  

 **DOLLAR TREE**

The UPS Store 

 **CANADIAN TIRE**  **SHOPPERS DRUG MART**

 **PHARMASAVE** **WINNERS**

 **SUNNY FOODMART**  **Mark's**



 **SWISS CHALET ROTISSERIE & GRILL**  **Boston Pizza**

  **TD Bank**



## SUBJECT SITE

 

# Permitted Uses & Zoning

# Demographics

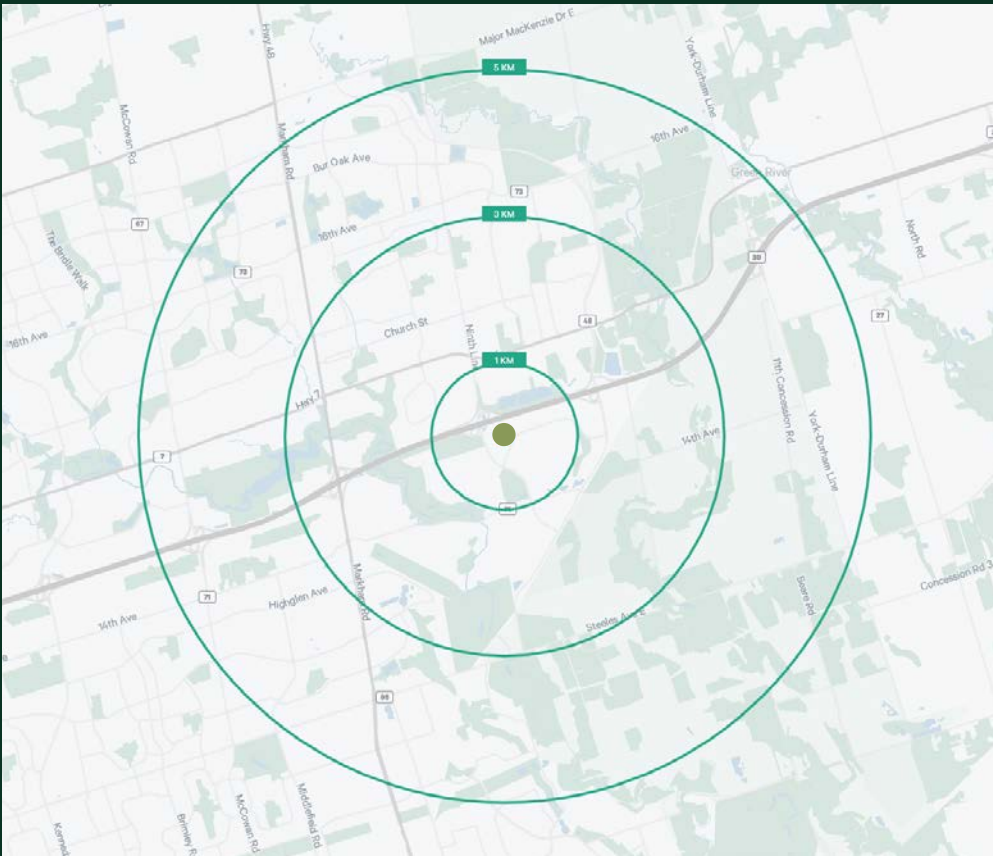
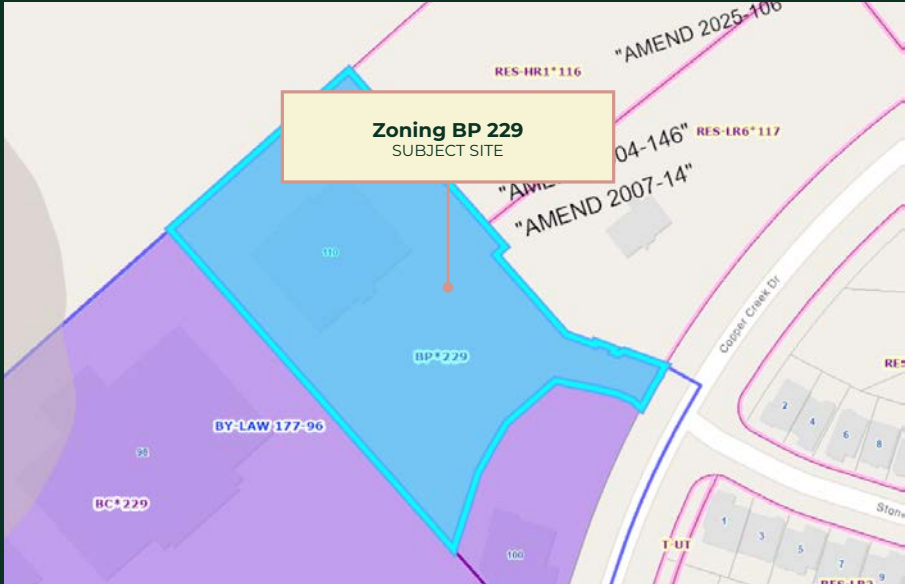

- PERMITTED COMMERCIAL USES INCLUDING, BUT NOT LIMITED TO:**
- Banquet Halls
  - Business Offices
  - Commercial Parking Lots
  - Financial Institutions
  - Hotels
  - Industrial Uses
  - Medical Offices
  - Municipal Parking Lots
  - Parking Garages
  - Parks, Public
  - Personal Service Shops
  - Restaurants
  - Retail Stores
  - Trade and Convention Centres

[CLICK TO VIEW PERMITTED USES ZONE BP 229](#)

	TOTAL POPULATION 2025	POPULATION GROWTH 2025-2030	DAYTIME POPULATION 2025	HOUSEHOLD INCOME 2025
<b>1 KM</b>	<b>9,959</b>	<b>6.8%</b>	<b>1,692</b>	<b>\$177,965</b>
<b>3 KM</b>	<b>57,284</b>	<b>3.9%</b>	<b>37,201</b>	<b>\$174,285</b>
<b>5 KM</b>	<b>149,150</b>	<b>2.5%</b>	<b>124,860</b>	<b>\$159,377</b>

\*BUYERS/TENANTS ARE RESPONSIBLE FOR CONFIRMING ZONING AND PERMITTED USES.

## FOR MORE INFORMATION, PLEASE CONTACT:

### Nicholas Regan\*

Senior Sales Associate  
416 801 1658  
nicholas.regan@cbre.com

### Matt Gunning\*

Senior Vice President  
416 495 6231  
matt.gunning@cbre.com

### Matthew Pieszchala\*

Vice President  
905 234 0376  
matthew.pieszchala@cbre.com

### Adam Occhipinti\*

Vice President  
416 798 6265  
adam.occhipinti@cbre.com

### Karlyn Knafo\*

Associate Vice President  
905 234 0381  
karlyn.knafo@cbre.com

CBRE Limited, Real Estate Brokerage | 5935 Airport Road, Suite 700, Mississauga, ON, L4V 1W5 | \*Sales Representative

This disclaimer shall apply to CBRE Limited, Real Estate Brokerage, and to all other divisions of the Corporation ("CBRE"). The information set out herein, including, without limitation, any projections, images, opinions, assumptions and estimates obtained from third parties (the "Information") has not been verified by CBRE, and CBRE does not represent, warrant or guarantee the accuracy, correctness and completeness of the Information. CBRE does not accept or assume any responsibility or liability, direct or consequential, for the Information or the recipient's reliance upon the Information. The recipient of the Information should take such steps as the recipient may deem necessary to verify the Information prior to placing any reliance upon the Information. The Information may change and any property described in the Information may be withdrawn from the market at any time without notice or obligation to the recipient from CBRE. CBRE and the CBRE logo are the service marks of CBRE Limited and/or its affiliated or related companies in other countries. All other marks displayed on this document are the property of their respective owners. All Rights Reserved. Mapping Sources: Canadian Mapping Services [canadamapping@cbre.com](mailto:canadamapping@cbre.com); DMTI Spatial, Environics Analytics, Microsoft Bing, Google Earth. All rates, measurements, plans and specifications subject to change E. & O. E