

FOR LEASE

16601 N May Ave., Suite B



- ±2,938 SF
- ±509 SF PATIO
- \$53 SF
- NNN LEASE
- TI ALLOWANCE
- FRONTAGE SUITE

ROSE CREEK PLAZA

The vision of Rose Creek Plaza is to create a lifestyle destination, including a unique blend of national and local retail, restaurants, services, boutique fitness, and entertainment. This combined with design ambiance and amenities that are conducive to gathering, casual browsing, and creating positive experiences.

HEATHER RAINER

Broker Associate-Skybridge
Real Estate

405-922-0809

COREY HALE

Sales Associate-Skybridge Real
Estate

405--365-6990





SPACE DETAILS

Position your business in one of North OKC's most sought-after mixed-use developments at Rose Creek Plaza. This $\pm 2,938$ SF frontage suite along N. Main Avenue offers exceptional visibility and accessibility within a high-income, high-growth area.

The space is delivered in shell condition, providing a blank canvas to bring your vision to life, complemented by a generous \$30/SF tenant improvement allowance. A standout feature includes an expansive ± 509 SF patio, ideal for restaurants, cafés, or experiential retail looking to capitalize on indoor-outdoor atmosphere.

This location is surrounded by national and local tenants and anchored by Homeland, with strong daily traffic along North May Avenue. It benefits from consistent consumer flow and built-in customer demand.

With limited availability in this premier development, this suite represents a rare opportunity to secure frontage in a thriving, affluent corridor.

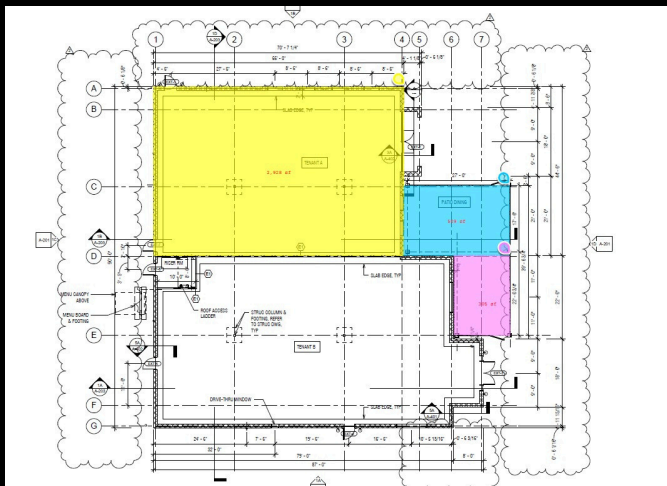

LOCATION

