

# 600 S DEARBORN

South Loop | Chicago



FOR LEASE

# 600 S DEARBORN

## The Opportunity

1,769 SF Available

## Area Retailers



SPECIAL BLEND  
COFFEE



JUICE & SHACK



TOTTO'S  
MARKET



CLUB PILATES

puregreen

## Features

- Ideally located in Printers Row within the South Loop neighborhood
- Retail space sits at the base of a 296-unit residential condo building
- Corner space with excellent visibility and 32' of frontage along Dearborn
- Public parking lot located directly across the street
- Walking distance to the Loop and the Jackson Blue Line station, serving more than 2.3M riders annually

## Demographics

	1 Mile	3 Miles	5 Miles
POPULATION	63,915	370,343	790,509
AVG HOUSEHOLD INCOME	\$189,170	\$175,841	\$162,390
DAYTIME POPULATION	421,917	872,999	1,240,694



# SITE PLAN



600 S Dearborn | Chicago, IL

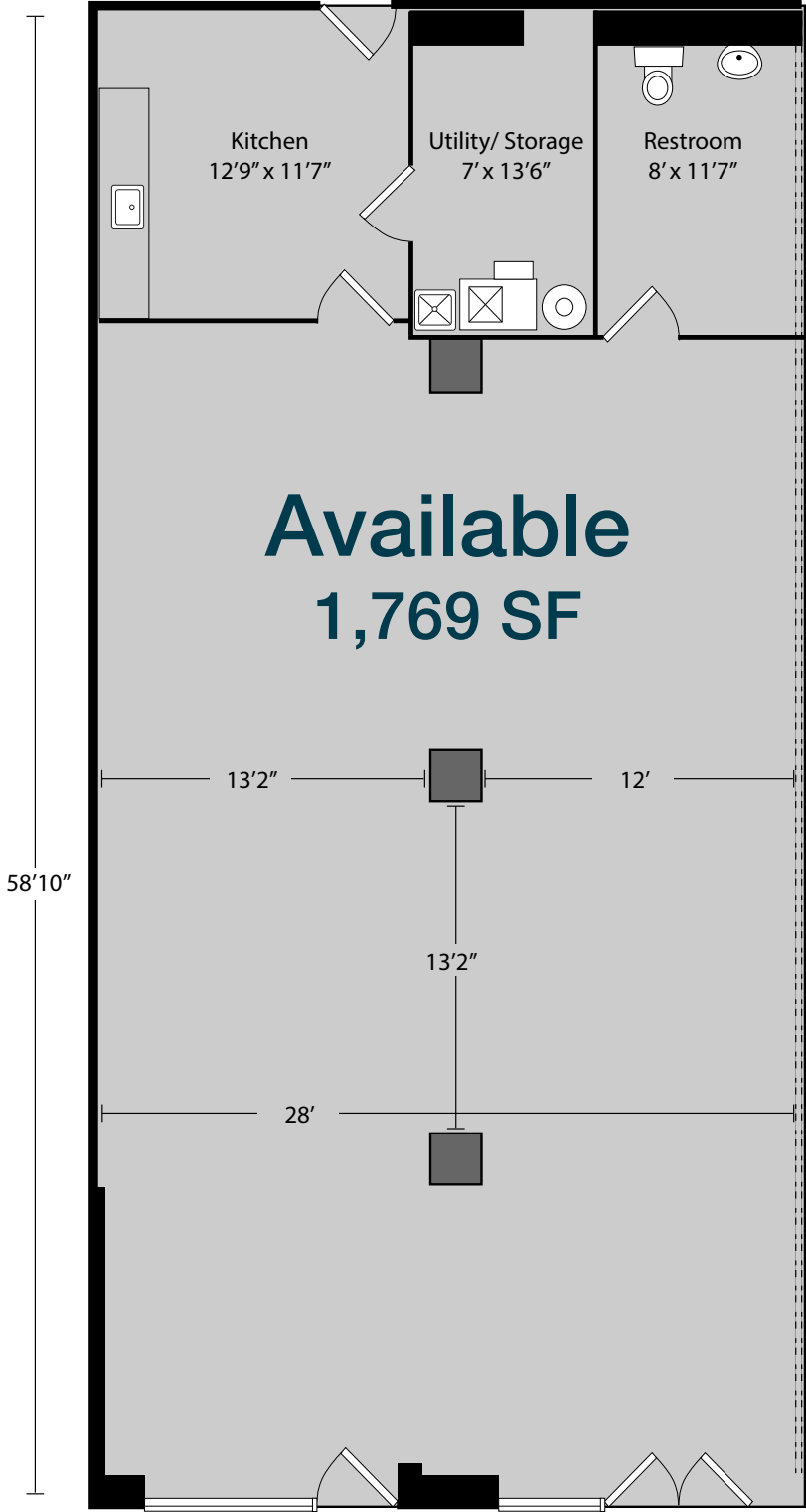

# TRADE AREA



600 S Dearborn | Chicago, IL



# 600 S DEARBORN

Chicago, IL

Jaime  
Bertsche

630.954.7223

[JBertsche@MidAmericaGrp.com](mailto:JBertsche@MidAmericaGrp.com)

Abby  
Waldvogel

630.954.7378

[AWaldvogel@MidAmericaGrp.com](mailto:AWaldvogel@MidAmericaGrp.com)



One Parkview Plaza, 9th Floor  
Oakbrook Terrace, Illinois 60181  
630.954.7300

[MidAmericaGrp.com](http://MidAmericaGrp.com)

A MEMBER OF **CHAINLINKS** RETAIL ADVISORS

*The information contained herein has either been given to us by the owner of the property or obtained from sources that we deem reliable. We have no reason to doubt its accuracy but we do not guarantee it.*

