



R&R Commercial Realty, Inc.



WATERFRONT PROPERTY

FOR SALE  
SOUTH STATE STREET, DOVER DE 19901

# THE SPACE

Location **South State Street  
Dover , DE 19901**

County **Kent**

# HIGHLIGHTS

- ❖ 2.20+/- Acres
- ❖ Waterfront Property
- ❖ Zoning: RS1
- ❖ Tax ID: 2-00-086.13-02-64.00-000
- ❖ List Price: \$500,000

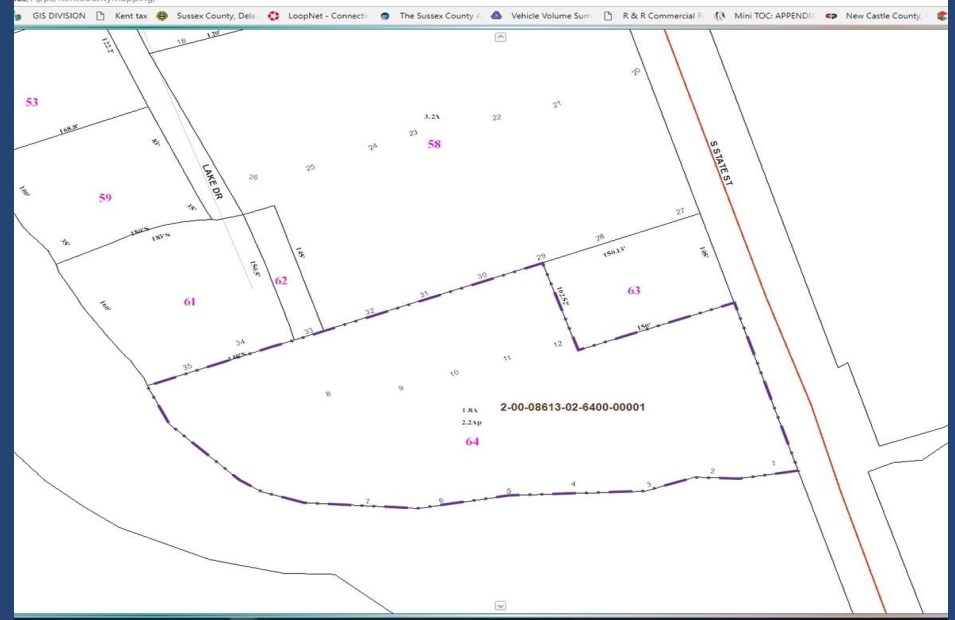

## POPULATION

1.00 MILE	3.00 MILE	5.00 MILE
7,094	47,152	82,864

## AVERAGE HOUSEHOLD INCOME

1.00 MILE	3.00 MILE	5.00 MILE
\$102,139	\$90,500	\$91,638

## NUMBER OF HOUSEHOLDS

1.00 MILE	3.00 MILE	5.00 MILE
2,629	18,285	31,132





# Waterfront Property

## CONFIDENTIALITY and DISCLAIMER

All information contained herein is believed to be accurate, however was obtained from third parties and R & R Commercial Realty, Inc. does not warrant as to the accuracy submitted, subject to changes or modification without notice. Listing Broker represents the sellers interest.

*Exclusively Marketed by:*

**Carl Kaplan**  
R&R Commercial Realty  
Agent  
(302) 670-5698  
cbkaplan@verizon.net



<http://www.randrcommercialrealty.com>

46 S. State Street, Dover, DE 19901

powered by CREOP