

FOR LEASE

SOUTH END INDUSTRIAL SPACE

94
**BESSEMER
COURT**
LONDON, ONTARIO



PROPERTY HIGHLIGHTS

- + Various sizes available between 5,000 SF to 35,000 SF for lease in South London
- + Easy access to Highway 401
- + Landlord will invest in unit upgrades for the right deal

LEASE RATE: \$3.50 PSF Net



FOR MORE INFORMATION PLEASE CONTACT

RANDY FISHER

Broker
Vice President
D 519.286.2009
C 519.872.3494
randy.fisher@cbre.com

LARIN SHOULDICE, SIOR

Sales Representative
Associate Vice President
D 519.286.2019
C 519.851.7654
larin.shouldice@cbre.com

CBRE

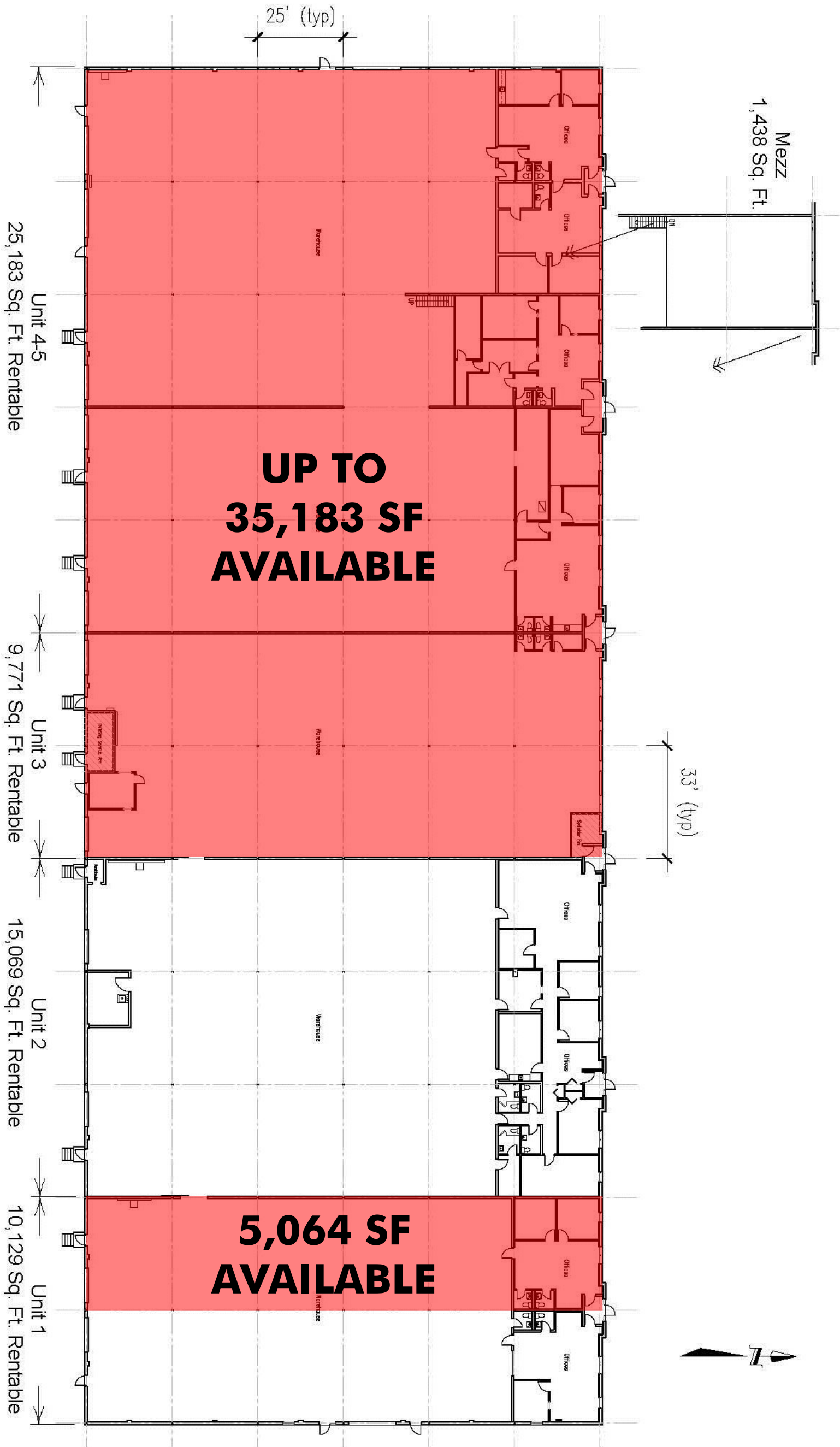

FOR MORE INFORMATION PLEASE CONTACT

RANDY FISHER

Broker
 Vice President
 D 519.286.2009
 C 519.872.3494
 randy.fisher@cbre.com

LARIN SHOULDICE, SIOR

Sales Representative
 Associate Vice President
 D 519.286.2019
 C 519.851.7654
 larin.shouldice@cbre.com



FOR LEASE SOUTH END INDUSTRIAL SPACE

94
**BESSEMER
COURT**
LONDON, ONTARIO



BUILDING FEATURES

TOTAL SQUARE FOOTAGE:	5,064 SF to 35,183 SF
CLEAR HEIGHT:	16'
SHIPPING:	6 truck level docks 3 drive-in doors
ZONING:	LI1, LI2 & LI7
POSSESSION:	15 days
FIRE PROTECTION:	Fully sprinklered
ADDITIONAL RENT:	\$3.25 PSF

LEASE RATE: \$3.50 PSF Net



FOR MORE INFORMATION PLEASE CONTACT

RANDY FISHER

Broker
Vice President
D 519.286.2009
C 519.872.3494
randy.fisher@cbre.com

LARIN SHOULDICE, SIOR

Sales Representative
Associate Vice President
D 519.286.2019
C 519.851.7654
larin.shouldice@cbre.com

CBRE Limited | 380 Wellington Street | Suite 30 | London, Ontario N6A 5B5

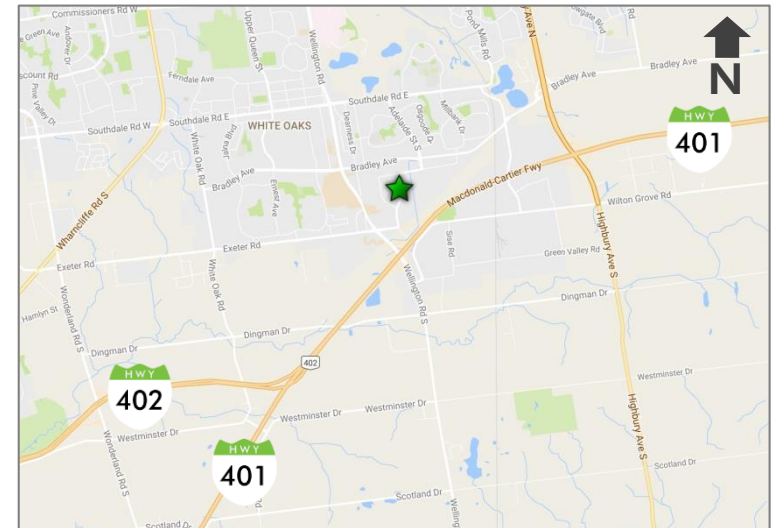

This disclaimer shall apply to CBRE Limited, Real Estate Brokerage, and to all other divisions of the Corporation; to include all employees and independent contractors ("CBRE"). The information set out herein, including, without limitation, any projections, images, opinions, assumptions and estimates obtained from third parties (the "Information") has not been verified by CBRE, and CBRE does not represent, warrant or guarantee the accuracy, correctness and completeness of the Information. CBRE does not accept or assume any responsibility or liability, direct or consequential, for the Information or the recipient's reliance upon the Information. The recipient of the Information should take such steps as the recipient may deem necessary to verify the Information prior to placing any reliance upon the Information. The Information may change and any property described in the Information may be withdrawn from the market at any time without notice or obligation to the recipient from CBRE. CBRE and the CBRE logo are the service marks of CBRE Limited and/or its affiliated or related companies in other countries. All other marks displayed on this document are the property of their respective owners. All Rights Reserved.

Mapping Sources: Google Earth

CBRE