

3801

OCEAN RANCH BLVD
Ste 107, Oceanside, CA 92056



FOR SUBLEASE | 8,525 SF INDUSTRIAL SUITE

PROPERTY FEATURES

3801



Property Address 3801 Ocean Ranch Blvd, Suite 107, Oceanside, CA 92056

Suite Size 8,525 SF

Office SF Approx. 1,000 SF

Dock High Positions 2

Grade Level Doors 2

Zoning IL – Limited Industrial District

Clear Height 25'

Power 400 amps @ 277 / 480 (to be verified by subtenant)

Parking 1.75/1,000 SF

Sprinklered Yes

Sublease Expiration 8/31/2028

\$.99 NNN

Ⓢ LEASE RATE | ~~\$1.24/SF NNN~~ (\$0.39/SF NNN FEES)

FLOOR PLAN

3801

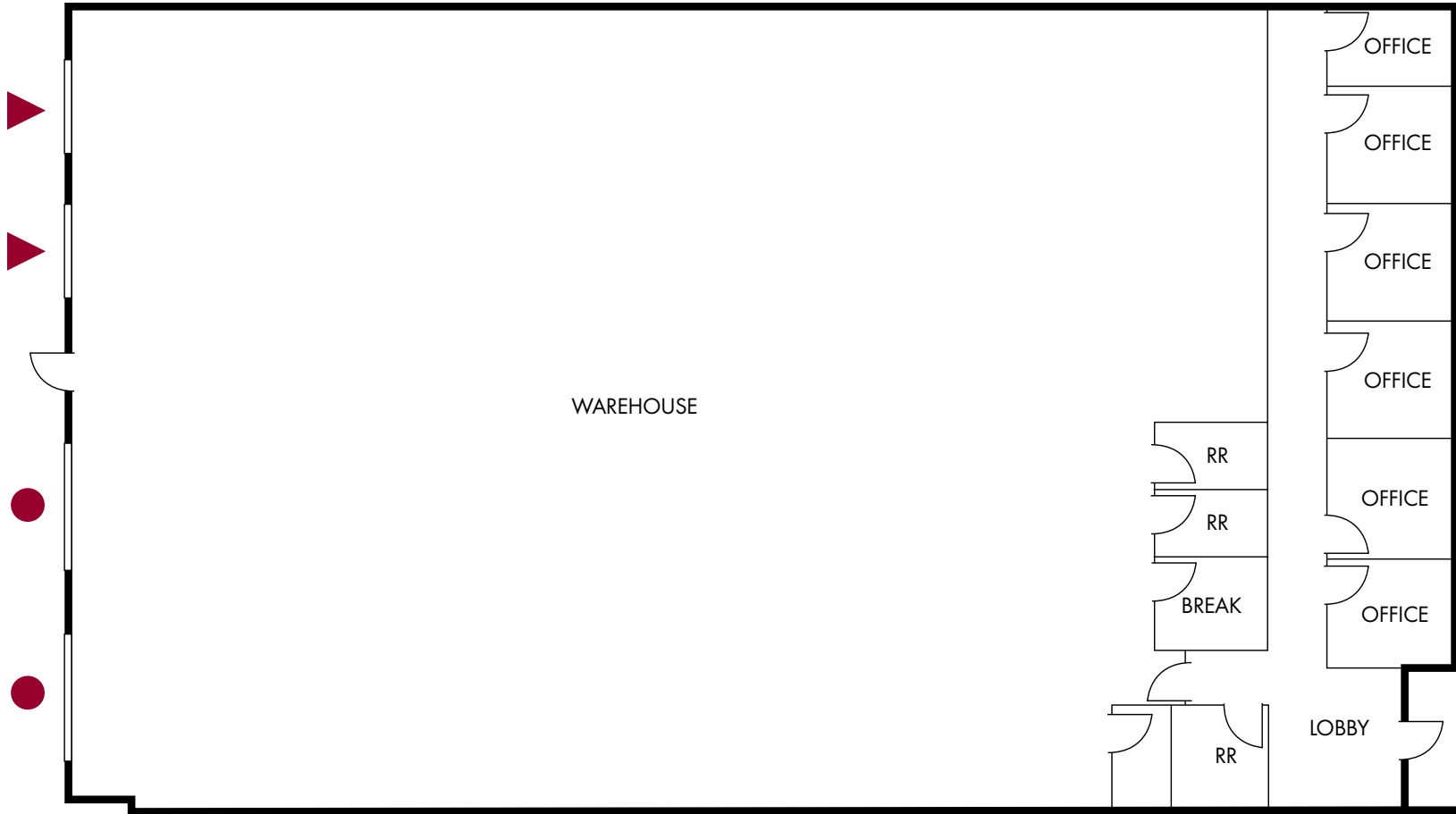

*NOT TO SCALE

▲ = DOCK HIGH POSITIONS

● = GRADE LEVEL DOORS

PROPERTY PHOTOS

3801

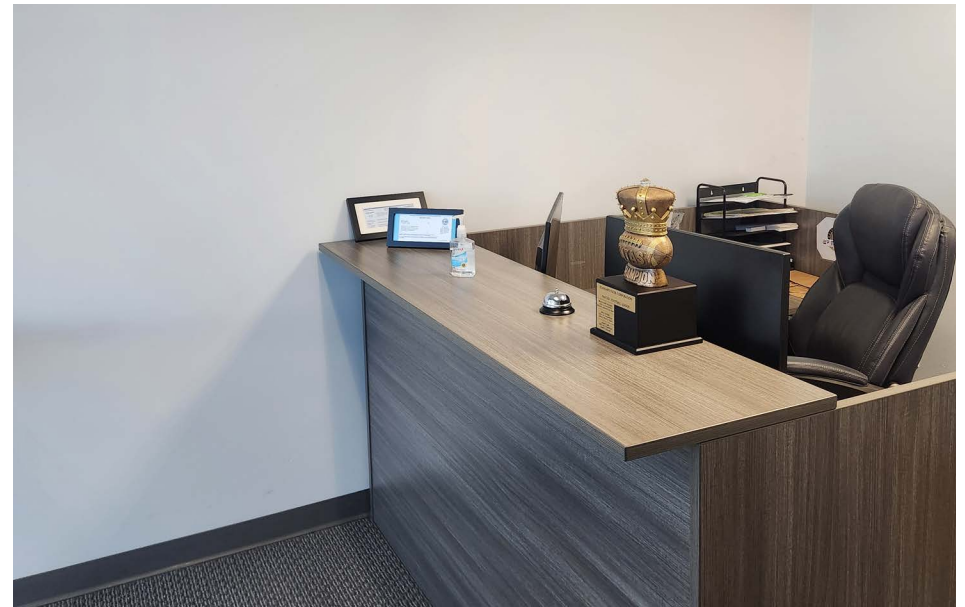
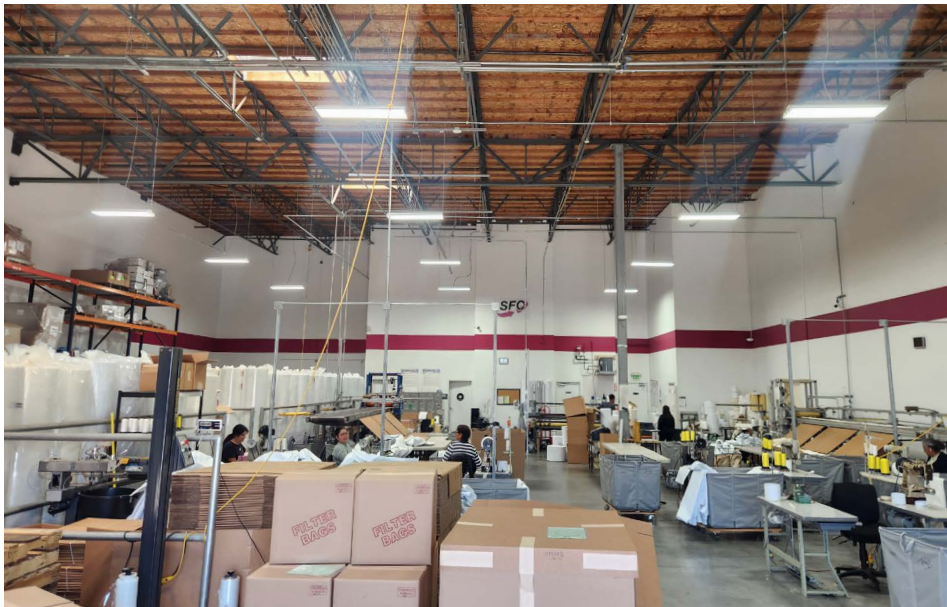

AERIAL MAP

3801



NEARBY RETAIL & AMENITIES

3801



3801 OCEAN RANCH BLVD

CORPORATE NEIGHBORS

1 PLAZA RANCHO DEL ORO

3 RANCHO DEL ORO GATEWAY

2 DEL ORO MARKETPLACE

4 RANCHO DEL ORO RD

FRONTWAVE ARENA

SOCAL SPORTS COMPLEX

WILLIAM A. WAGNER AQUATIC CENTER

OCEAN RANCH CORPORATE CENTRE

PACIFIC COAST BUSINESS PARK

RANCHO DEL ORO TECHNOLOGY PARK

Sprinter Line

LOCATION OVERVIEW



3801 OCEAN RANCH BLVD

Oceanside

Centrally located in the heart of the beautiful Southern California coastline, Oceanside, California is among the region's best places to escape the hustle and bustle of the crowded cities.

Considered the gateway city between metropolitan San Diego and Los Angeles, Oceanside's near-perfect climate invites visitors to revel and relax at the 3.5 miles of white sandy beaches Oceanside offers.

30 city parks

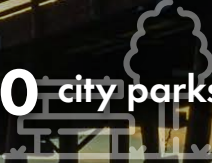

1,954 foot-long pier



3.5 miles of public beaches



1,000 slip public marina



MEDIAN
HOUSEHOLD
INCOME

\$93,724

POPULATION

167,266

BUSINESSES

8,012

OCEANSIDE'S LOCAL INDUSTRIES

LIFE SCIENCE
MEDTECH
PHARMA
TOURISM

ADVANCED
MANUFACTURING
MILITARY
SPORTS & ACTIVE
LIFESTYLES

3801

OCEAN RANCH BLVD
Ste 107, Oceanside, CA 92056

RUSTY WILLIAMS, SIOR
(760) 448-2453
rwilliams@lee-associates.com
DRE Lic#01390702

CHRIS ROTH, SIOR
(760) 448-2448
croth@lee-associates.com
DRE Lic#01789067

JAKE RUBENDALL, SIOR
(760) 448-1369
jrubendall@lee-associates.com
DRE Lic#02037365



Lee & Associates Commercial Real Estate Services, Inc. - NSDC
1902 Wright Place, Suite 180, Carlsbad, CA 92008 | P: (760) 929-9700 | F: (760) 929-9977

No warranty or representation is made to the accuracy of the foregoing information. Terms of sale or lease and availability are subject to change or withdrawal without notice.
Any of the foregoing information will need to be separately verified by Buyer.