



Z A L L
COMMERCIAL
REAL ESTATE

ANB Plaza | Cherry Creek North
155 St. Paul Street, Denver, CO 80206



Prime Retail Opportunity in Cherry Creek North

4,850 SF FOR LEASE

- Space available in the prestigious ANB Plaza in Cherry Creek
- High-end retail space offers prime location on St. Paul Street
- Surrounded by luxury retailers and vibrant local businesses including YETI, Tecovas Boots, Rag & Bone, Vineyard Vines, Rhone and many more
- Nearly 2M SF of new office space under construction or delivering soon, ±1,400 new high-end residential units, and more than 250,000 SF of retail under development in this sought-after neighborhood

For leasing information, contact

Stuart Zall
szall@zallcompany.com
303.888.9040

Stacey Glenn DePalma
sglenn@zallcompany.com
303.909.2745

Kyle Framson
kframson@zallcompany.com
301.807.1421

This information has been obtained from sources believed reliable. We have not verified it and make no guarantee about it.

ZALL COMPANY
2946 Larimer Street
Denver, CO 80205
zallcompany.com

ANB Plaza | Cherry Creek North
 155 St. Paul Street, Denver, CO 80206

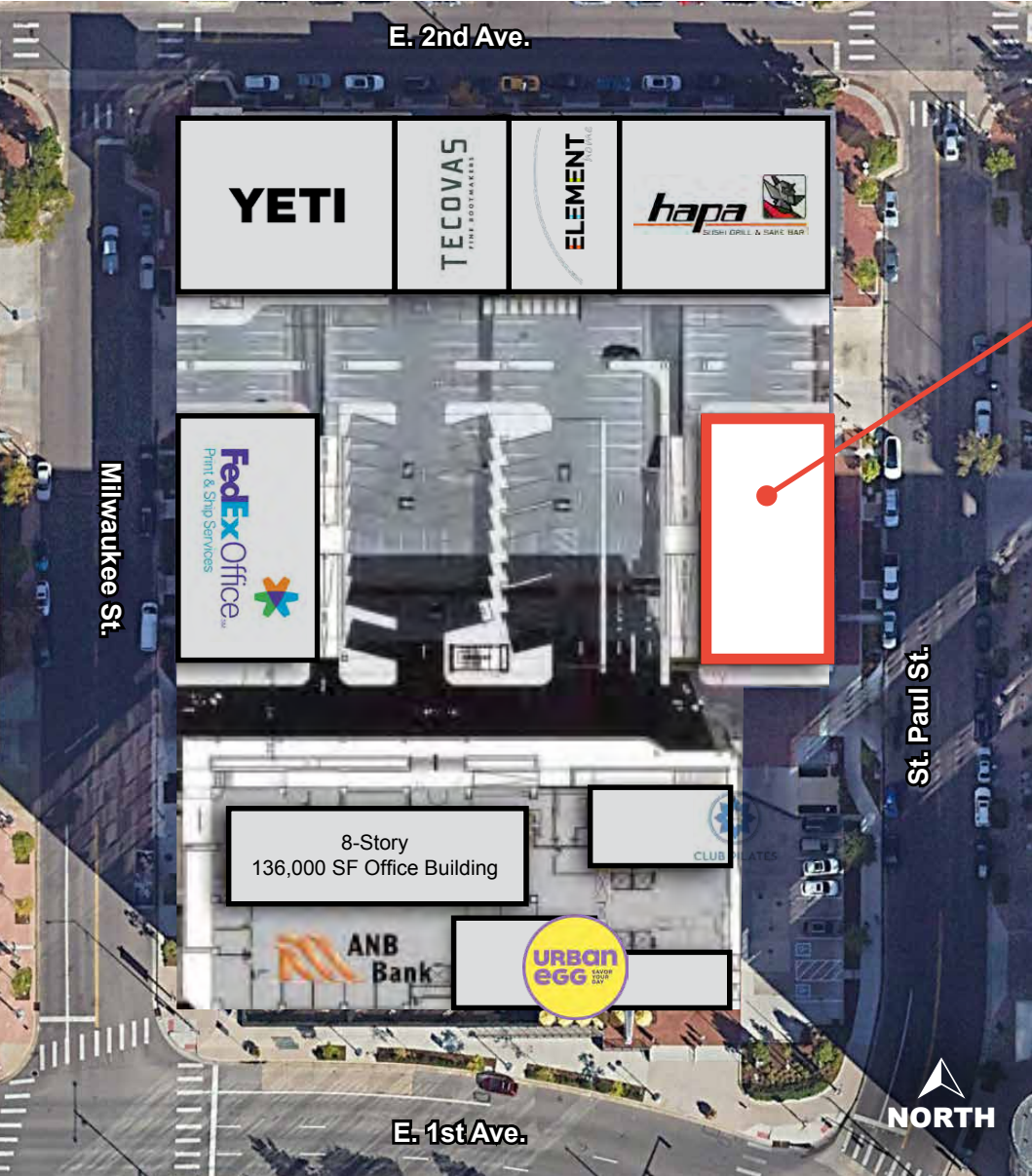

4,850 SF FOR LEASE

- AVAILABLE
- LEASED

Demographics

	1 Mile	3 Miles	5 Miles
2024 Population	18,470	225,688	551,347
2024 Households	9,801	118,024	259,657
Average HH Income	\$163,160	\$120,309	\$109,889
Bachelor's Degree or Higher	79%	64%	52%

Source: CoStar

For leasing information, contact

Stuart Zall
 szall@zallcompany.com
 303.888.9040

Stacey Glenn DePalma
 sglenn@zallcompany.com
 303.909.2745

Kyle Framson
 kframson@zallcompany.com
 301.807.1421

This information has been obtained from sources believed reliable. We have not verified it and make no guarantee about it.



zallcompany.com

4,850 SF FOR LEASE

ANB Plaza | Cherry Creek North
155 St. Paul Street, Denver, CO 80206

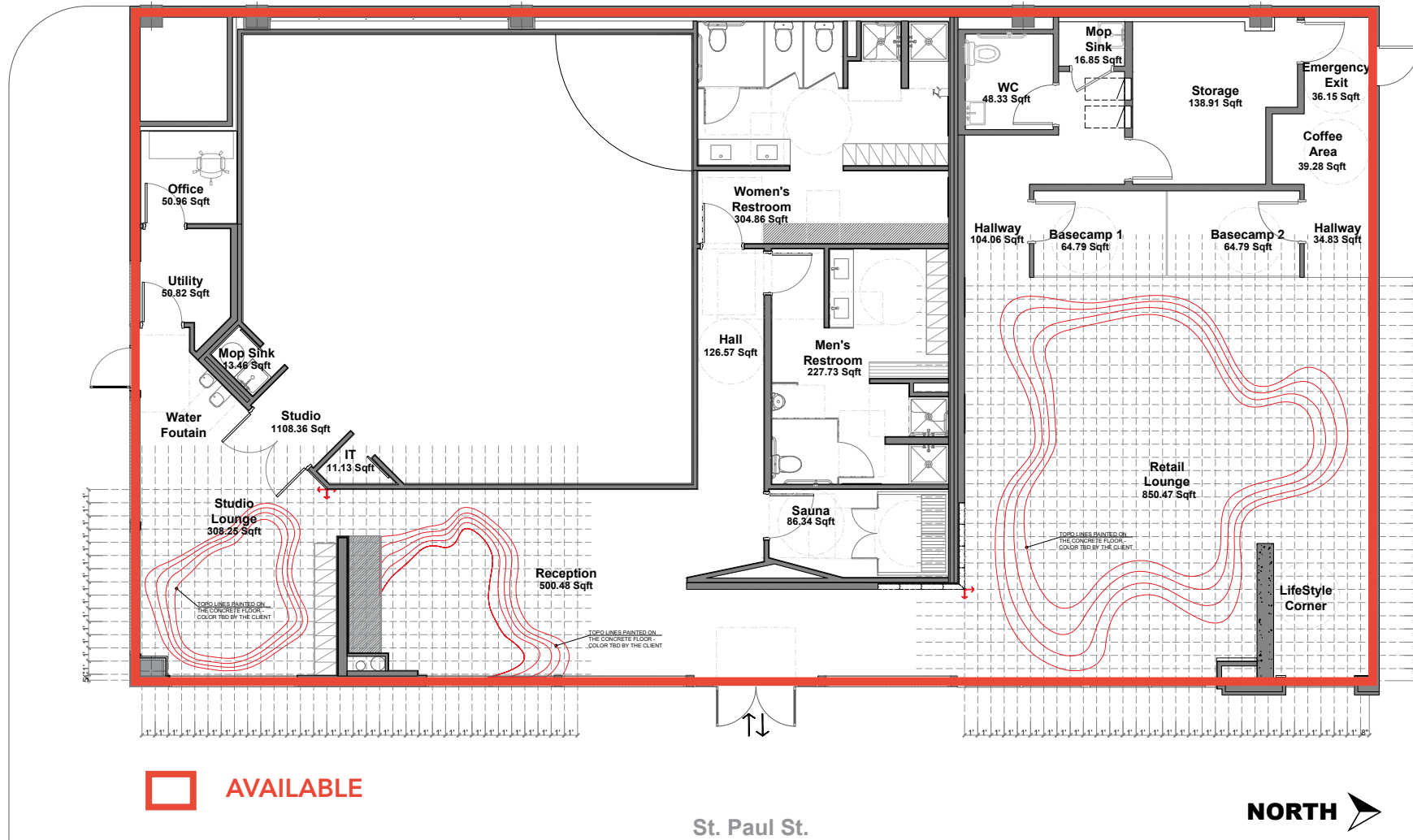

For leasing information, contact

Stuart Zall
szall@zallcompany.com
303.888.9040

Stacey Glenn DePalma
sglenn@zallcompany.com
303.909.2745

Kyle Framson
kframson@zallcompany.com
301.807.1421

This information has been obtained from sources believed reliable. We have not verified it and make no guarantee about it.



zallcompany.com



Cherry Creek North offers retailers an unparalleled opportunity with its prime location in Denver's most vibrant mixed-use district, boasting over **16 walkable blocks**, a high concentration of affluent residents and visitors, and **unmatched foot traffic** from more than **300 retail shops** and **boutique hotels**.

ANB Plaza | Cherry Creek North

155 St. Paul Street, Denver, CO 80206



Map Legend

- RETAILERS
- ◆ DINING
- * LODGING

**4,850 SF
FOR LEASE**

For leasing information, contact

Stuart Zall
szall@zallcompany.com
303.888.9040

Stacey Glenn DePalma
sglenn@zallcompany.com
303.909.2745

Kyle Framson
kframson@zallcompany.com
301.807.1421



zallcompany.com

This information has been obtained from sources believed reliable. We have not verified it and make no guarantee about it.