

2051 RAYMER AVENUE, UNIT B

FULLERTON, CALIFORNIA



±39,139
SQUARE FEET
FOR LEASE

Voit
REAL ESTATE SERVICES

HV HEFNER
VERNICK
TEAM

A Quality Asset
Owned By:

ALERE



FEATURES

Building Size:	±39,139 Square Feet
Office Space:	±2,967 SF of Office Space
Dock Doors:	9 Dock High Loading Doors
Grade Doors:	1 Grade Level Loading Doors
Power:	3,000 Amps, 277/480 Volt (Verify)
Clear Height:	30'
Truck Court:	180'
Sprinkler:	ESFR

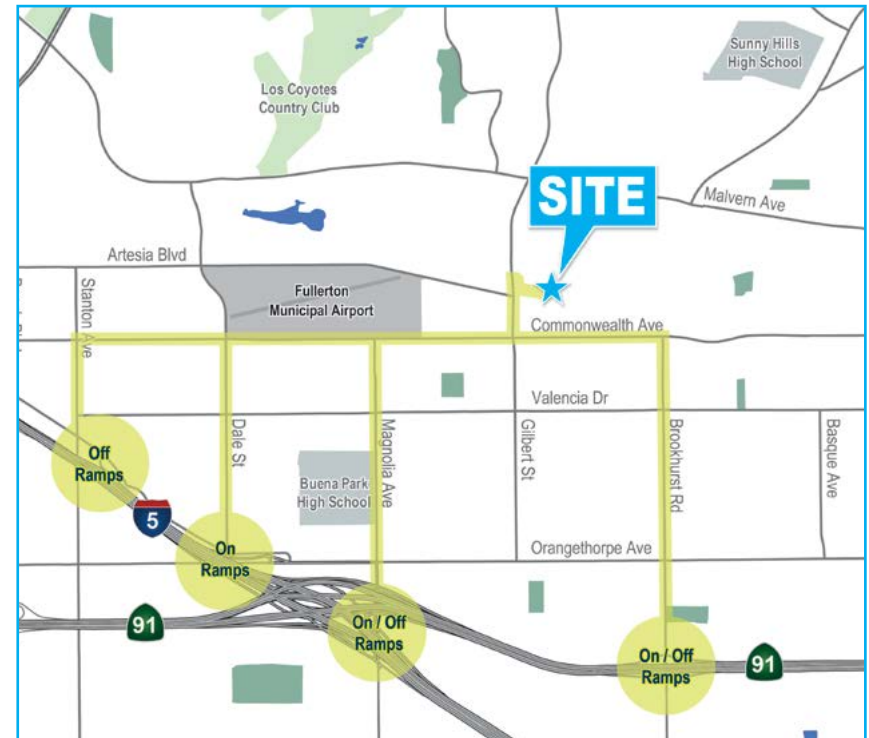

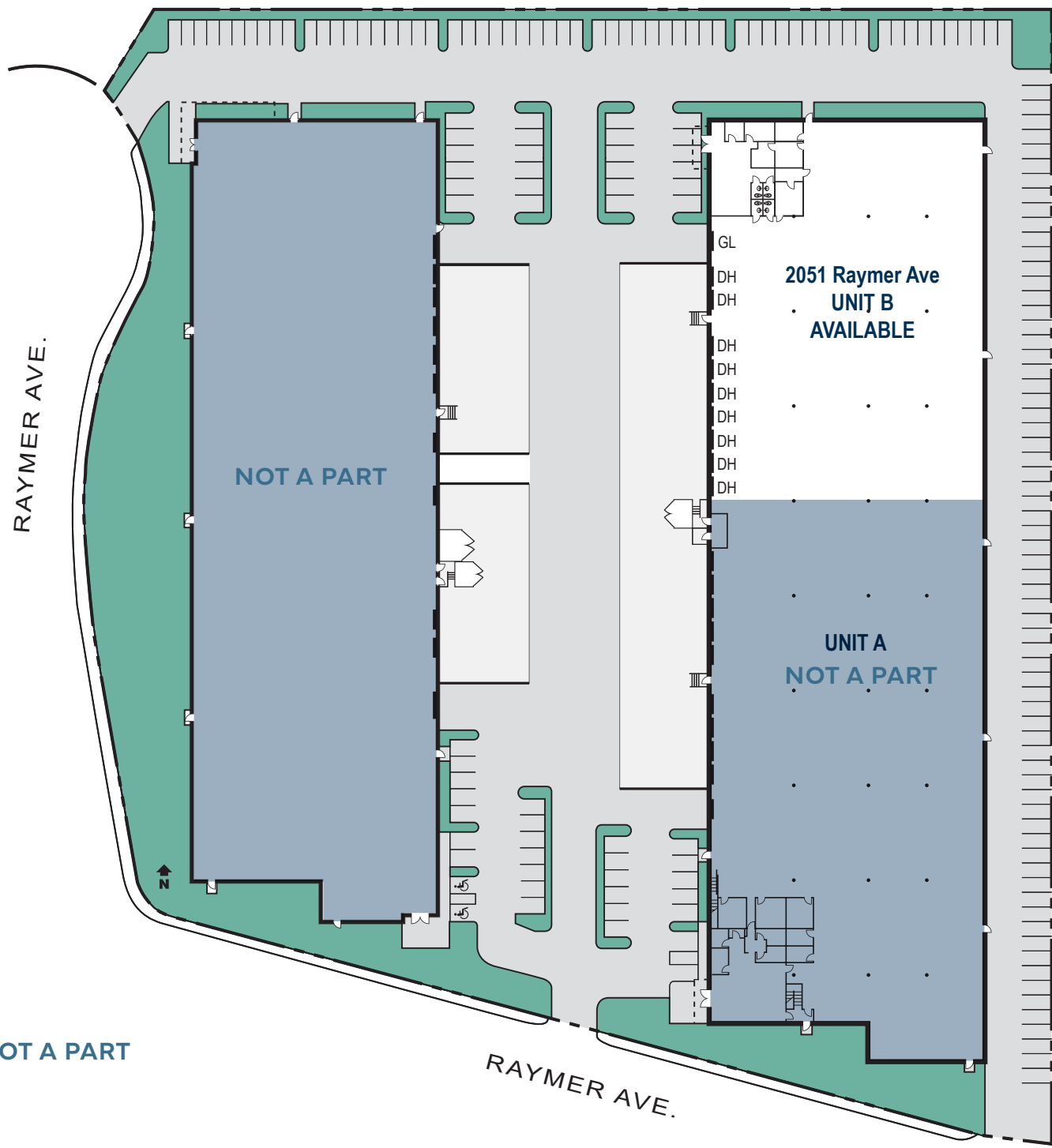

■ NOT A PART

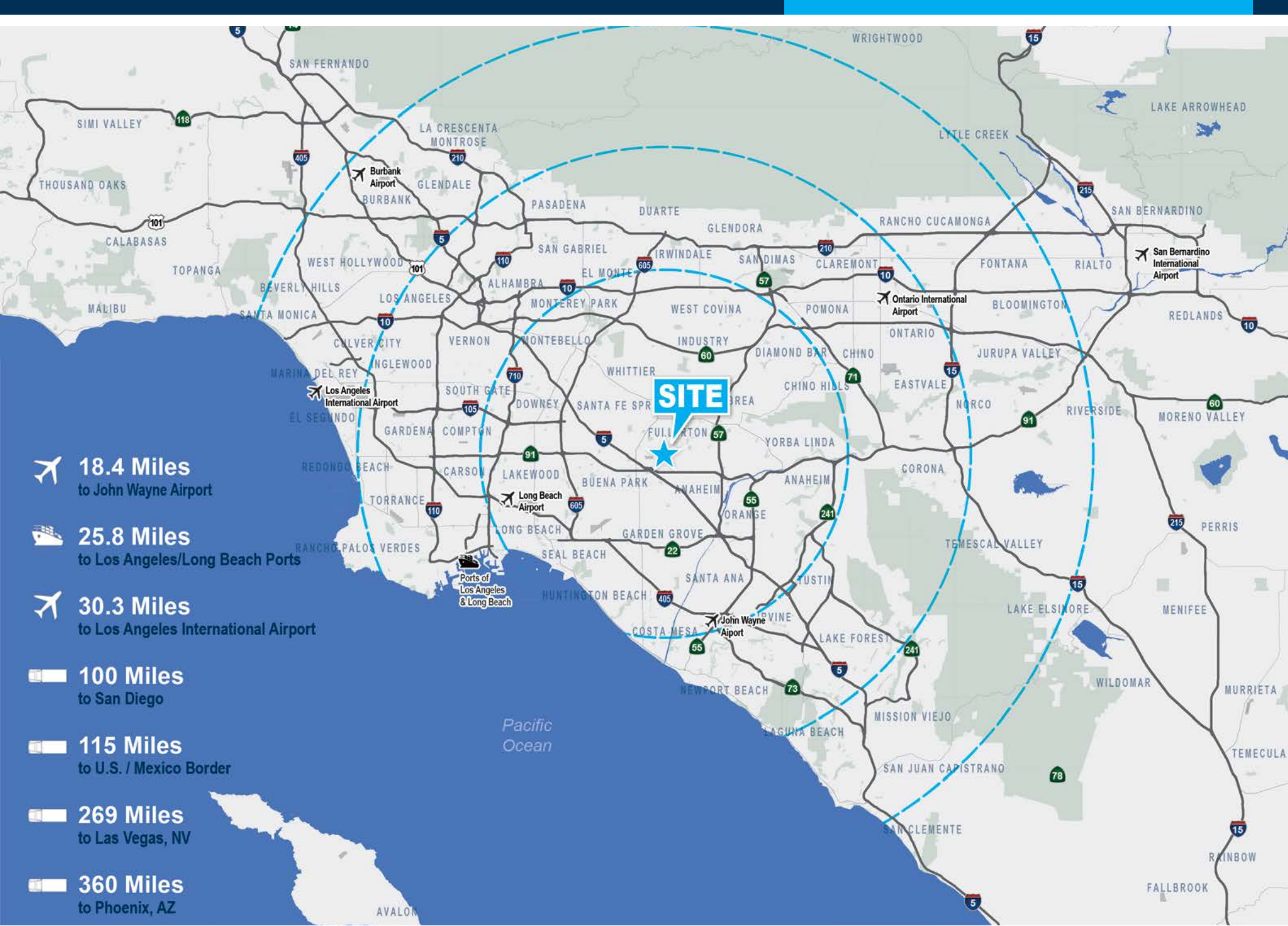

 **18.4 Miles**
to John Wayne Airport

 **25.8 Miles**
to Los Angeles/Long Beach Ports

 **30.3 Miles**
to Los Angeles International Airport

 **100 Miles**
to San Diego

 **115 Miles**
to U.S. / Mexico Border

 **269 Miles**
to Las Vegas, NV

 **360 Miles**
to Phoenix, AZ

2051 RAYMER AVENUE, UNIT B
FULLERTON, CALIFORNIA

MIKE HEFNER, SIOR
EXECUTIVE VICE PRESIDENT

714.935.2331

MHefner@voitco.com

Lic. #00857352

JACK FARIS
SENIOR VICE PRESIDENT

714.935.2318

JFaris@voitco.com

Lic. # 00912766

Voit
REAL ESTATE SERVICES

HV HEFNER
VERNICK
TEAM

A Quality Asset
Owned By:

ALERE