

560 BIRCH STREET, BUILDING 4
LAKE ELSINORE, CALIFORNIA 92530

FOR SALE
±4,018 SF FREESTANDING
INDUSTRIAL BUILDING



FOR MORE INFORMATION, PLEASE CONTACT:

CAREY PASTOR | Senior Vice President

(951) 297-7434 | cpastor@cbsocalgroup.com

CalDRE License # 01403298



COLDWELL BANKER
COMMERCIAL
SC

560 BIRCH STREET, BUILDING 4

LAKE ELSINORE, CALIFORNIA 92530

FOR SALE
±4,018 SF FREESTANDING
INDUSTRIAL BUILDING

PROPERTY HIGHLIGHTS

- 4,018 SF Freestanding Industrial building
- Recent improvements include: Warehouse motion controlled LED lighting- 3 with battery backup, New electrical panel, HVAC system 2022, flooring , permitted break room and additional office replaced in 2024, asphalt resurfacing striping in parking lot 2025, New water heater 2024.
- M-1 Zoning City of Lake Elsinore
- No Owner Association
- Seller will require short-term lease back (Approximately 60-90 days) to relocate after close
- Shown by appointment only. Please do not disturb occupant.
- Offered for Sale at \$950,000.00



560 BIRCH STREET, BUILDING 4

LAKE ELSINORE, CALIFORNIA 92530

FOR SALE
±4,018 SF FREESTANDING
INDUSTRIAL BUILDING

FLOOR PLAN

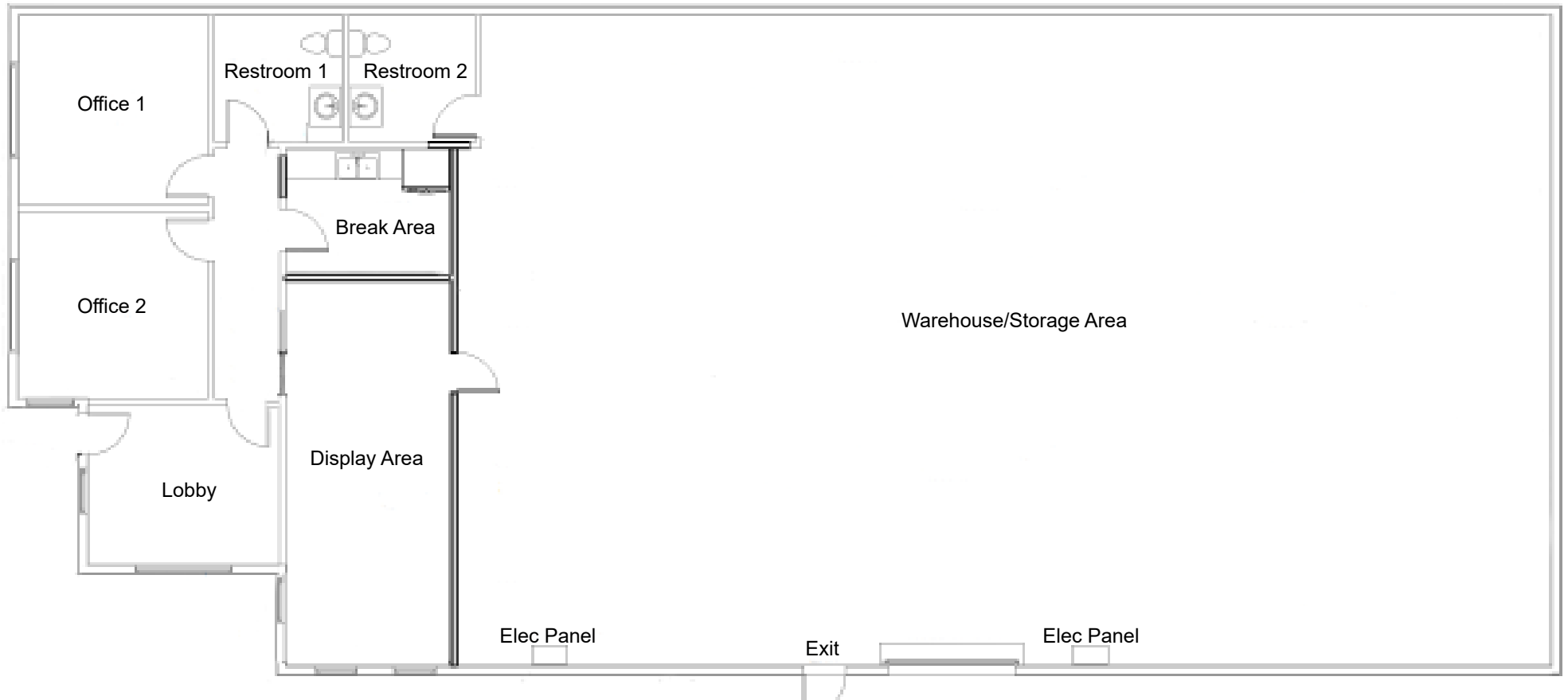

560 BIRCH STREET, BUILDING 4
LAKE ELSINORE, CALIFORNIA 92530

FOR SALE
±4,018 SF FREESTANDING
INDUSTRIAL BUILDING

PROPERTY PHOTOS



560 BIRCH STREET, BUILDING 4

LAKE ELSINORE, CALIFORNIA 92530

FOR SALE
±4,018 SF FREESTANDING
INDUSTRIAL BUILDING



560 BIRCH STREET, BUILDING 4
LAKE ELSINORE, CALIFORNIA 92530

FOR SALE
±4,018 SF FREESTANDING
INDUSTRIAL BUILDING



FOR MORE INFORMATION, PLEASE CONTACT:

CAREY PASTOR
Senior Vice President
951.297.7434
cpastor@cbcsocalgroup.com
CalDRE # 01403298

27368 Via Industria | Suite 102
Temecula | California | 92590
t 951.200.7683 | f 951.239.3147
cbcsocalgroup.com



COLDWELL BANKER
COMMERCIAL
SC