

FOR LEASE

19,376 S.F. Industrial Building



DORIN REALTY
COMPANY, INC.



845 East 60th St., Los Angeles, CA 90001

Outstanding Low Cost, Brick Distribution/Manufacturing Building

HIGHLIGHTS:

- Loading: Four (4) Dock High Positions.
- Power: 600 Amp, 240 Volt, 3 Phase
- Office: 2,028 S.F. - Flexible Layout
- Clearance: 14'-20'
- Two 50' Spans
- Gas Line
- Rear 2,300 S.F. Storage Yard
- Abundant Skylights Provide Great Natural Light.

LOCATION:

- Part of a Business Improvement District with Security Patrols and Monitored Cameras.
- Less than 1 mile from I-110 Freeway Ramps with Great Proximity to Downtown Los Angeles, Ports and LAX
- M-2 Zoning - Great for a Variety of Uses.

This Outstanding Property is Offered for \$14,532/month (\$.75/SF) Gross



Contact exclusive agent:

Mark Whitman

Lic. No. 00918875

mwhitman@dorinrealty.com

213-627-0007 Ext 124

4555 Pacific Blvd., Vernon, CA 90058-2207

Industrial and Commercial Real Estate Specialists
Since 1959

www.dorinrealty.com

The information contained herein is from sources we believe to be reliable but, we do not guarantee its accuracy. All measurements & dimensions are approximations and are not to scale. Clients are encouraged to verify their accuracy.

845 E. 60th Street, Los Angeles, CA 90001

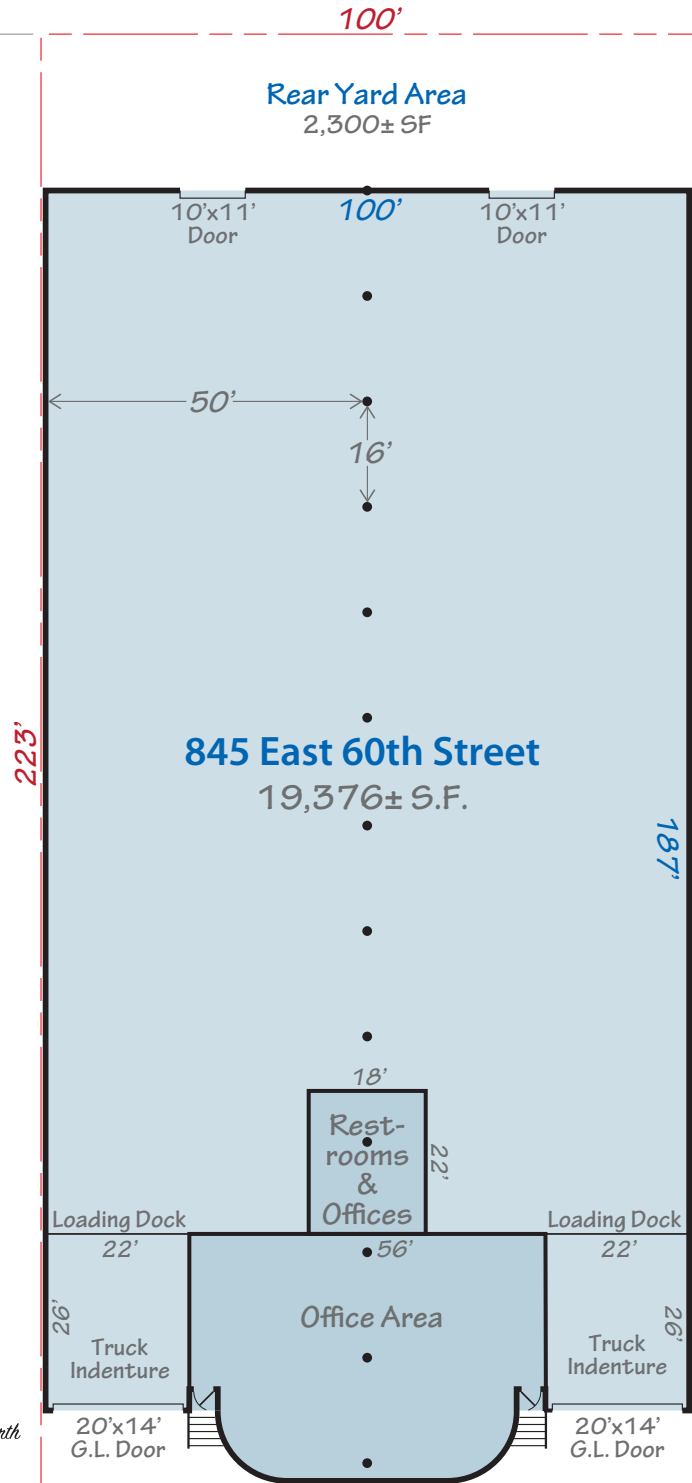

E. 60th Street



DORIN REALTY
COMPANY, INC.
Lic. No. 00531646

Contact exclusive agent:
Mark Whitman
 Lic. No. 00918875
 mwhitman@dorinrealty.com
213-627-0007 Ext 124
 4555 Pacific Blvd., Vernon, CA 90058-2207

Industrial and Commercial Real Estate Specialists
Since 1959
www.dorinrealty.com

The information contained herein is from sources we believe to be reliable but, we do not guarantee its accuracy. All measurements & dimensions are approximations and are not to scale. Clients are encouraged to verify their accuracy.

845 E. 60th Street, Los Angeles, CA 90001

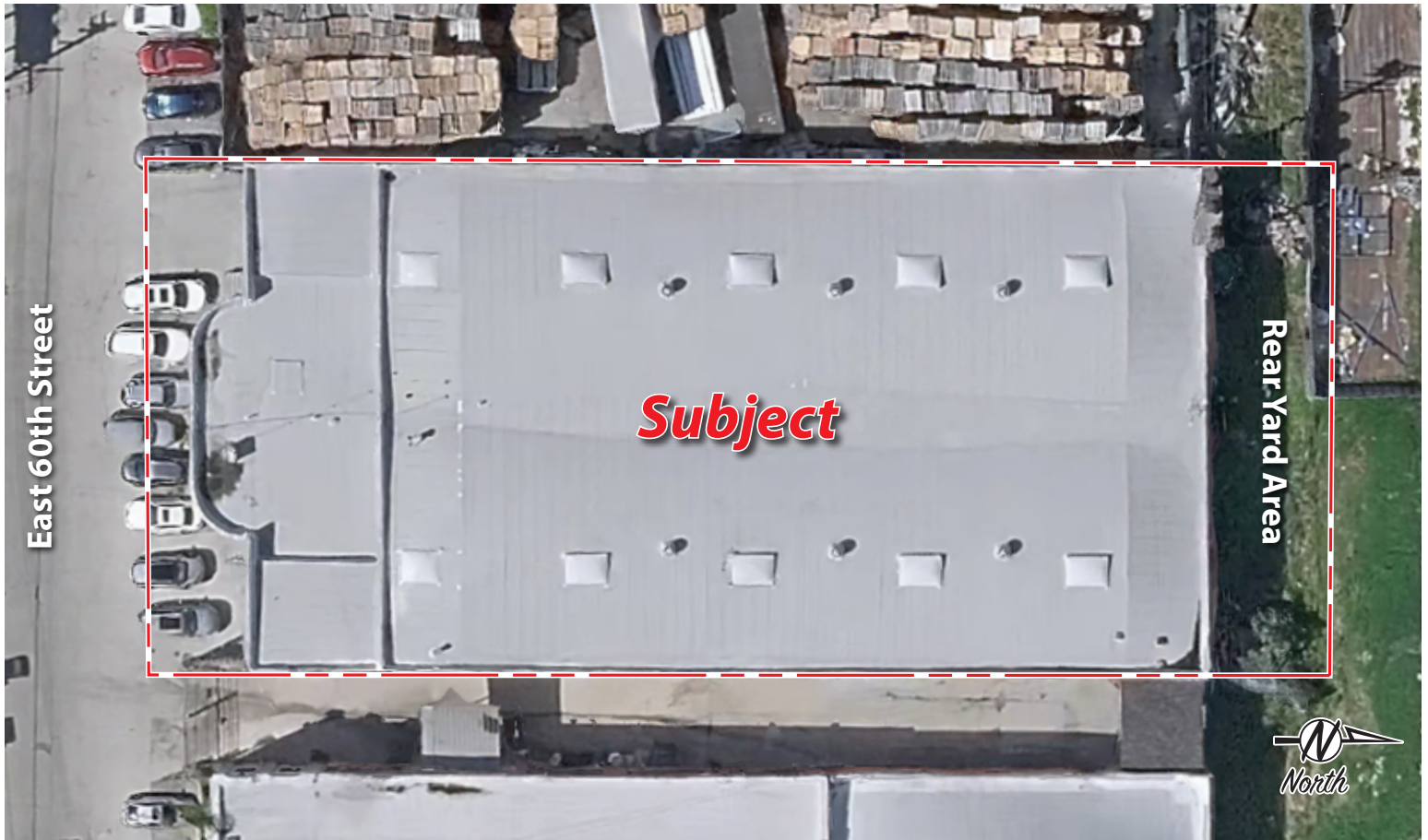

Lease Rate/Mo: \$14,532.00	Sprinklered: No	Office SF / #: 2,028 SF / 3
Lease Rate/SF: \$0.75	Clear Height: 14'-20'	Restrooms: 2
Lease Type: Gross	GL Door/Dim: 0	Office HVAC: None
Available SF: 19,376 SF	DH Door/Dim: 4 / (2) 20'x12'	Finished Off. Mezz: 0 SF
Minimum SF: 19,376 SF	Elec: A: 600 / V: 240 / O: 3 / W: 3	Include In Available: No
Prop Lot Size: 0.51 Ac / 22,337 SF	Construction Type: Masonry	Unfinished Mezz: 0 SF
Term: 305 Years w/Periodic COLA's	Const. Status/ Year Built: Existing / 1948	Include In Available: No
Sale Price: NFS	Warehouse HVAC: No	Possession: Now
Sale Price/SF: NFS	Parking Spaces: 6	Vacant: Yes
Taxes:	Parking Ratio: 0.3:1/	To Show: Call Broker
Yard: No	Rail Service: No	Market/Submarket: Outlying Los Angeles
Zoning: M2	Specific Use: Warehouse/Office	APN#: 6007-004-013
Listing Company: Dorin Realty Company	Listing Date: 01/05/2026	FTCF#: CB250N000S000/AOAA
Agent: Mark Whitman 213-627-0007		
Listing #: 44097365		

Special Features: Free Standing Building. Rear 2,300 SF land can be used. All details must be verified.



Contact exclusive agent:

Mark Whitman

Lic. No. 00918875

mwhitman@dorinrealty.com

213-627-0007 Ext 124

4555 Pacific Blvd., Vernon, CA 90058-2207

Industrial and Commercial Real Estate Specialists

Since 1959

www.dorinrealty.com

The information contained herein is from sources we believe to be reliable but, we do not guarantee its accuracy. All measurements & dimensions are approximations and are not to scale. Clients are encouraged to verify their accuracy.

**845 E. 60th Street
Los Angeles, CA 90001**



Contact exclusive agent:

Mark Whitman

Lic. No. 00918875

mwhitman@dorinrealty.com

213-627-0007 Ext 124

4555 Pacific Blvd., Vernon, CA 90058-2207

Industrial and Commercial Real Estate Specialists

Since 1959

www.dorinrealty.com

The information contained herein is from sources we believe to be reliable but, we do not guarantee its accuracy. All measurements & dimensions are approximations and are not to scale. Clients are encouraged to verify their accuracy.