

LEGEND

	PROPOSED PUBLIC ACCESS EASEMENT
	PROPOSED DETENTION AREA
	CEP SETBACK
	CWQZ LIMITS OF BUFFER ZONE

UNIT TABLE		
BUILDING TYPE	# OF BUILDINGS	TOTAL UNITS
36 UNIT	12	432
24 UNIT	6	144
TOTAL UNIT COUNT		576

PARKING TABLE	
TOTAL SPACES	880
SPACES PER UNIT	1.53

ZONING GUIDE (CD-5)		
CATEGORY	REQUIREMENT	PROPOSED
MAX HEIGHT	5 STORIES / 75'	3 STORIES / 40'
MAX BLOCK LENGTH	2,000'	1,990 LF
MAX IMP. COVER	100%	APPROX. 70%

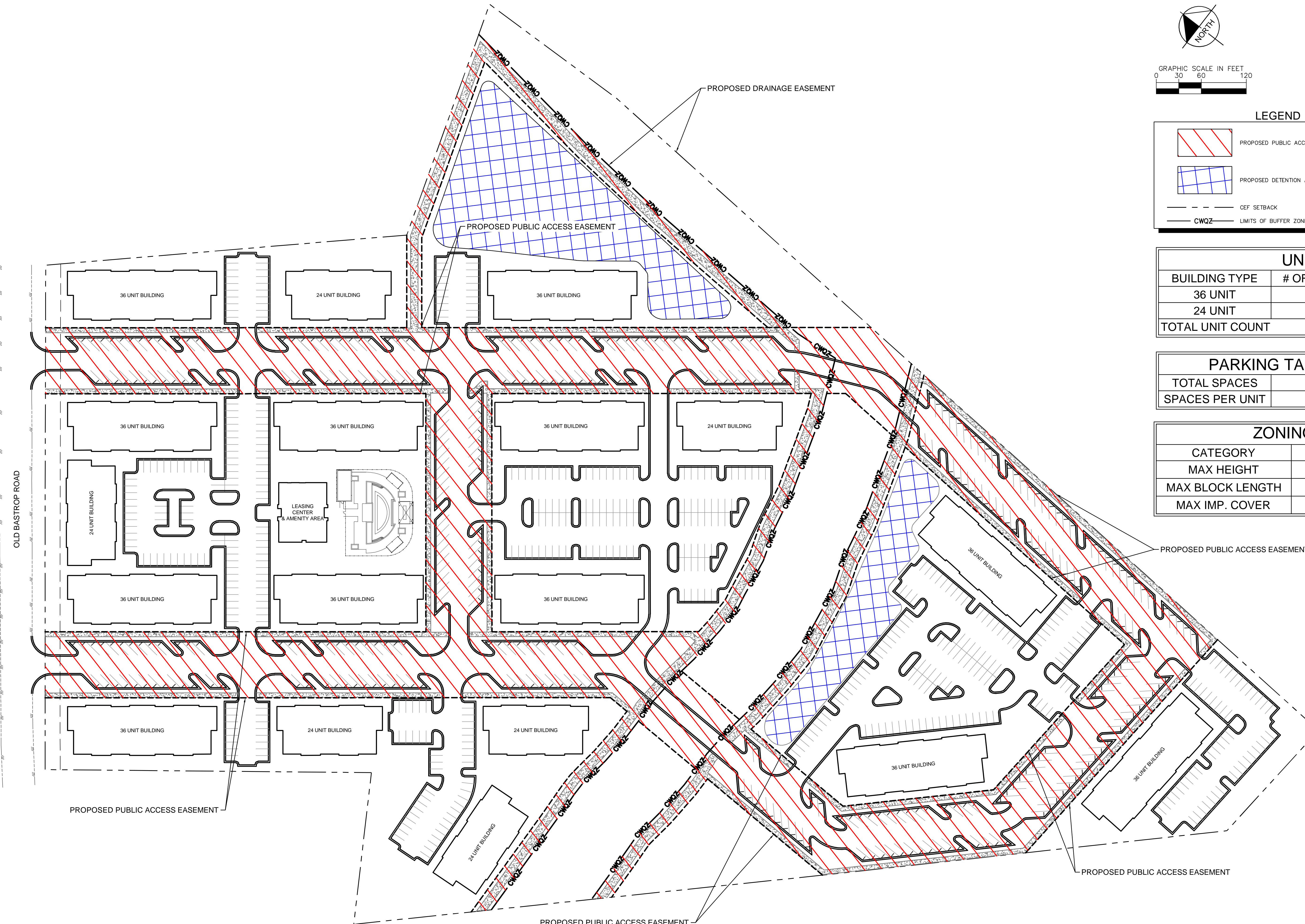

Yarrington Land - San Marcos

San Marcos, Texas



1251 Sadler Road
 Building K, Suite 1200
 San Marcos, Texas 78666
 State of Texas Registration No. F-928

NOTE: THIS PLAN IS CONCEPTUAL IN NATURE AND HAS BEEN PRODUCED WITHOUT THE BENEFIT OF A SURVEY, TOPOGRAPHY, UTILITIES, CONTACT WITH THE CITY, ETC.