



**FOR LEASE**  
**202 SPAULDING ST**

**385,506 SF**  
**DOWAGIAC, MI**

**JEFF KILBORN** | 414-214-0613 | [JKILBORN@PHOENIXINVESTORS.COM](mailto:JKILBORN@PHOENIXINVESTORS.COM)



**PHOENIX**  
**INVESTORS**

*Opportunity. Execution. Value Creation.*

This document has been prepared by Phoenix Investors for advertising and general information only. Phoenix Investors makes no guarantees, representations, or warranties of any kind, expressed or implied, regarding the information including, but not limited to, warranties of content, accuracy, and reliability.



## **PROPERTY HIGHLIGHTS**



**INTERIOR RAIL SPUR**



**A/C IN OFFICE  
PORTION**



**1,480 KVA POWER**



# PROPERTY DETAILS

202 SPAULDING ST | DOWAGIAC, MI

AVAILABLE SPACE	385,506 SF
DOCK DOORS	2
DRIVE-IN DOORS	15
FREIGHT ELEVATOR	(1) 5,000-lb Capacity
CLEAR HEIGHT	19' in Newer Section, 16' on Average
COLUMN SPACING	30' x 42', 18' x 20'
ROOF	Varies: Membrane & Tar, Rubber
WALLS	Steel Frame with Block Exterior Wood Frame with Block Exterior
FLOORS	8" - 10" Reinforced Concrete
YEAR BUILT	1900 - 1980
FIRE SUPPRESSION	Wet
LIGHTING	LED, Motion Sensored
POWER	4,180 KVA   10 On-Site Transformers
ELECTRIC & GAS	AEP
HVAC	Boiler 300 HP   Max BTU: 12,186,000
PARKING	15 Trailer   175 Auto
LAND AREA	28.69 Acres
ZONING	I-2: Heavy Industrial
PARCEL ID	14-160-300-069-00, 14-1660-200-068-00
RAIL	Norfolk Southern Rail Line



# FLOOR PLAN

202 SPAULDING ST | DOWAGIAC, MI

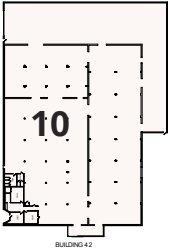

VIEW A VIDEO OF THIS PROPERTY

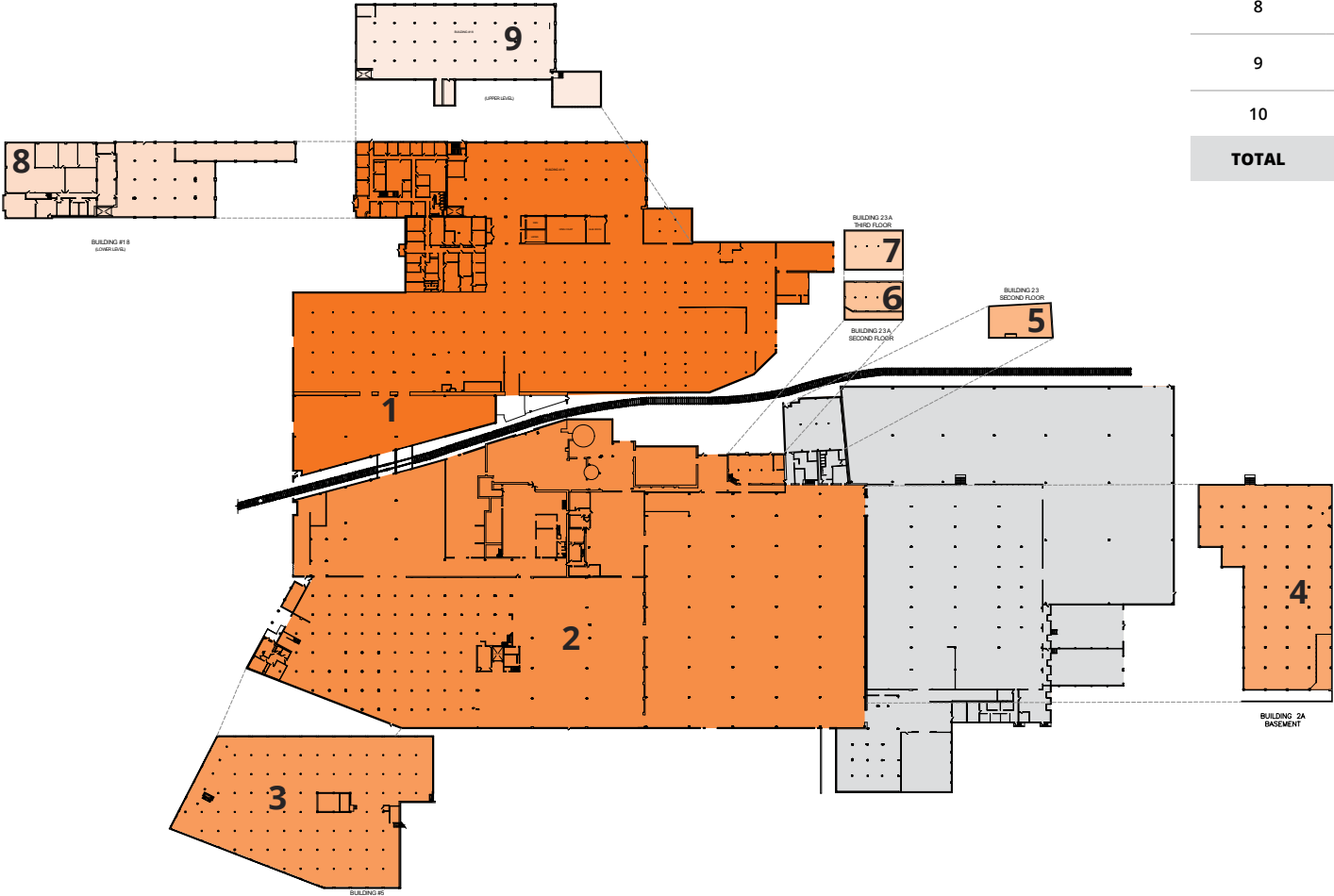

NUMBER	SPACE DESIGNATION	SQUARE FEET
1	MULTIPLE BUILDINGS	109,153 SF
2	MULTIPLE BUILDINGS	151,847 SF
3	BUILDING 5 SECOND FLOOR	30,236 SF
4	BUILDING 2A BASEMENT	22,350 SF
5	BUILDING 23 SECOND FLOOR	2,145 SF
6	BUILDING 23A SECOND FLOOR	2,281 SF
7	BUILDING 23A THIRD FLOOR	2,345 SF
8	BUILDING 18 BASEMENT	17,425 SF
9	BUILDING 18 SECOND FLOOR	17,324 SF
10	BUILDING 42	30,400 SF
<b>TOTAL</b>		<b>385,506 SF</b>

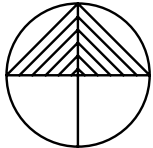

# LOCATION MAP

202 SPAULDING ST | DOWAGIAC, MI

<b>FORT WAYNE, IN</b>	101 MILES
<b>CHICAGO, IL</b>	113 MILES
<b>INDIANAPOLIS, IN</b>	172 MILES
<b>DETROIT, MI</b>	181 MILES

