

Two Union Square for Sublease

601 Union Street
Suite 2217
Seattle, WA 98101

Space highlights

- Floor 22: 6,150 RSF
- Fully furnished
- Lease Expiration Date: November 30, 2027
- 30 workstations
- 2 private offices
- 3 conference rooms
- Kitchen

Charlie Malley

+1 206 849-6062

Charlie.Malley@jll.com

Bode Maurer

+1 425 647-1140

Bode.Maurer@jll.com

 **JLL** SEE A BRIGHTER WAY

Although information has been obtained from sources deemed reliable, Owner, Jones Lang LaSalle, and/or their representatives, brokers or agents make no guarantees as to the accuracy of the information contained herein and offer the Property without express or implied warranties of any kind. The Property may be withdrawn without notice. If the recipient of this information has signed a confidentiality agreement regarding this matter, this information is subject to the terms of that agreement. ©2026. Jones Lang LaSalle. All rights reserved.

Office Space for Sublease

Floor 22: 6,150 RSF

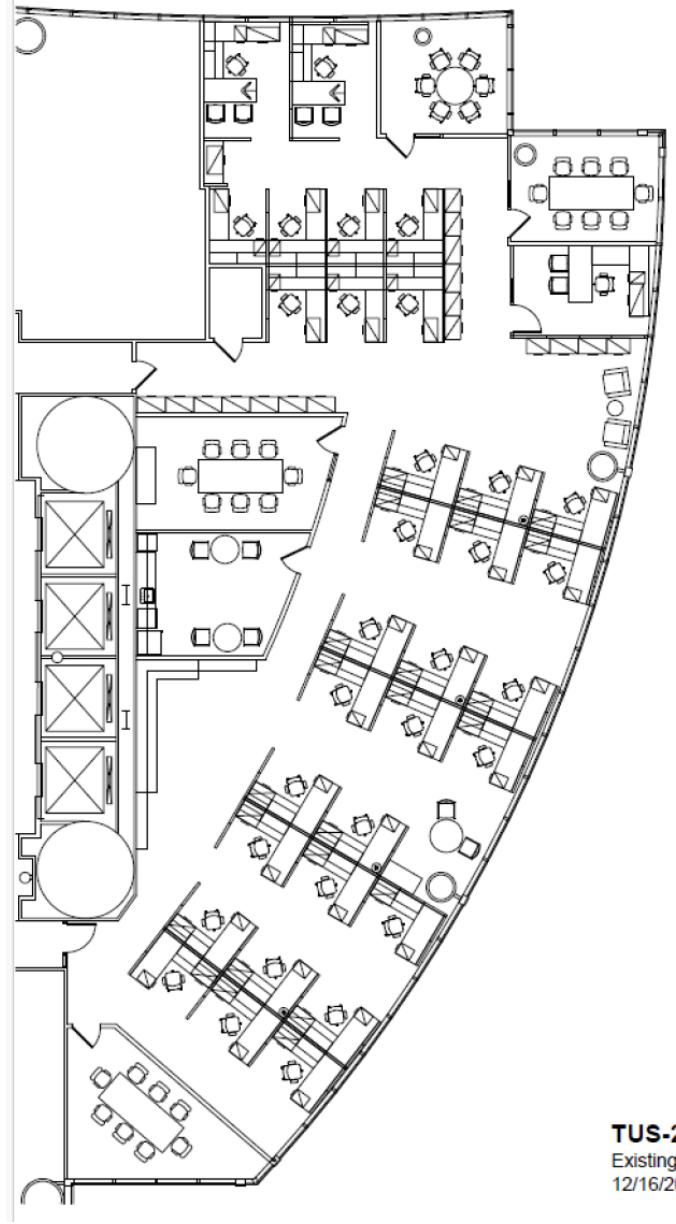

TUS-22
Existing Layout
12/16/2024



Charlie Malley

+1 206 849-6062

Charlie.Malley@jll.com

Bode Maurer

+1 425 647-1140

Bode.Maurer@jll.com

 **JLL** SEE A BRIGHTER WAY

Although information has been obtained from sources deemed reliable, Owner, Jones Lang LaSalle, and/or their representatives, brokers or agents make no guarantees as to the accuracy of the information contained herein and offer the Property without express or implied warranties of any kind. The Property may be withdrawn without notice. If the recipient of this information has signed a confidentiality agreement regarding this matter, this information is subject to the terms of that agreement. ©2026. Jones Lang LaSalle. All rights reserved.