



INDUSTRIAL WAREHOUSE

6001 ERDMAN AVENUE | BALTIMORE, MARYLAND 21205

FOR
SALE



MACKENZIE

COMMERCIAL REAL ESTATE SERVICES, LLC

PROPERTY OVERVIEW

HIGHLIGHTS:

- 50,995 SF \pm industrial/warehouse building situated on 2.4 acres \pm (paved)
- Hard to find industrial building with dock and drive-in loading
- New 120/240v 800 amp split service with 200 amps 120/240v 3 phase power
- Newly updated wet sprinkler system
- Located in Maryland Enterprise Zone and Opportunity Zone which offer financial incentives to qualified buyers.
- Superior access to I-95, I-895 and I-695
- Close proximity to the Port of Baltimore (4 miles) and Downtown

BUILDING SIZE:	50,995 SF \pm
LOT SIZE:	2.4 ACRES \pm
DOCKS:	4 (FRONT)
DRIVE-INS:	2 (OVERSIZED, REAR)
ZONING:	I-2 (GENERAL INDUSTRIAL DISTRICT)
SALE PRICE:	NEGOTIABLE



GOOGLE STREET VIEW



AERIAL / PARCEL OUTLINE

△ DRIVE-IN

|| DOCK

151

ERDMAN AVE

151

247' ±

404' ±

371' ±

251' ±



FLOOR PLAN

Not to scale.
Changes have been made.

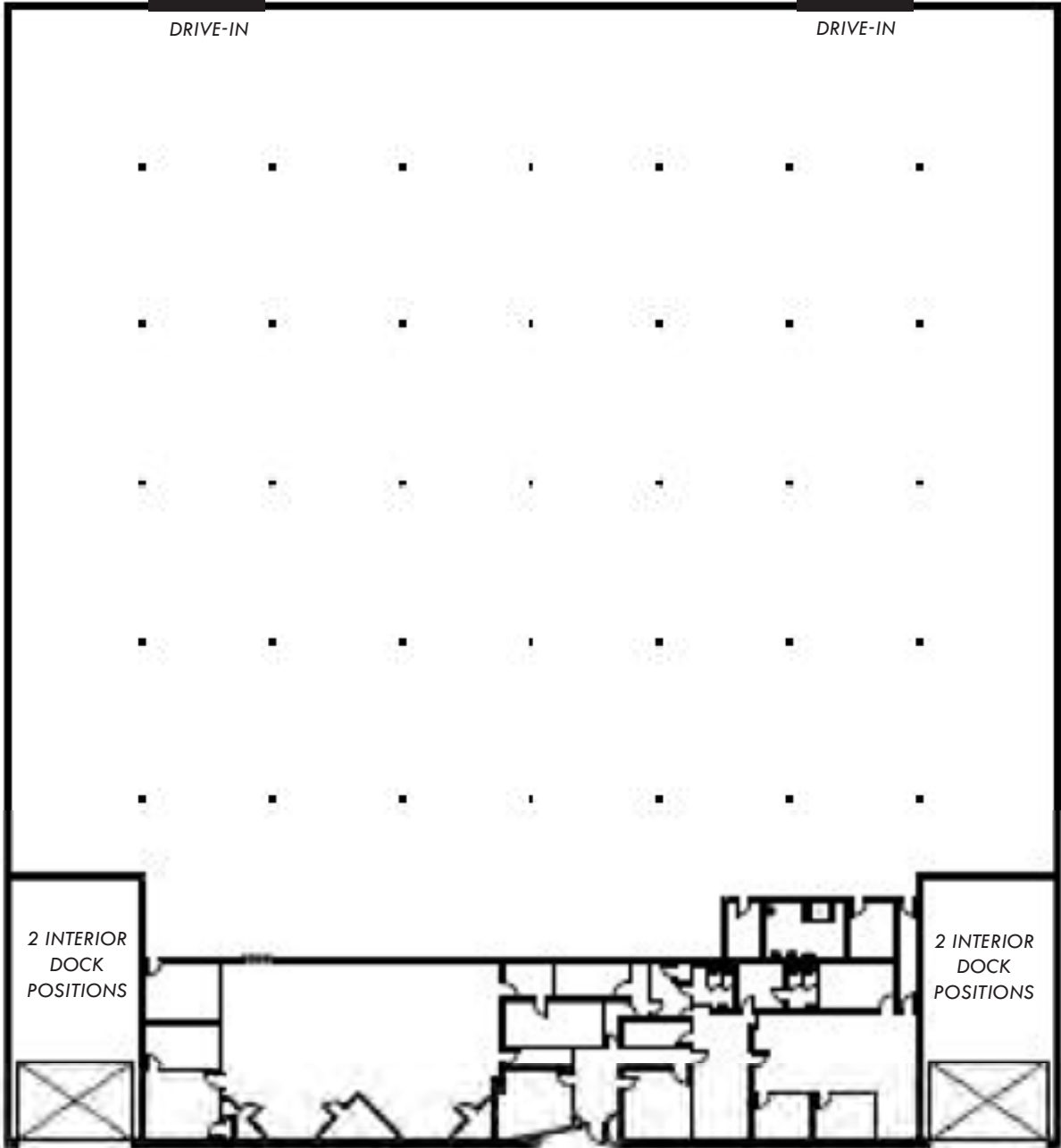

ADDITIONAL PHOTOS



LOCAL BIRDSEYE

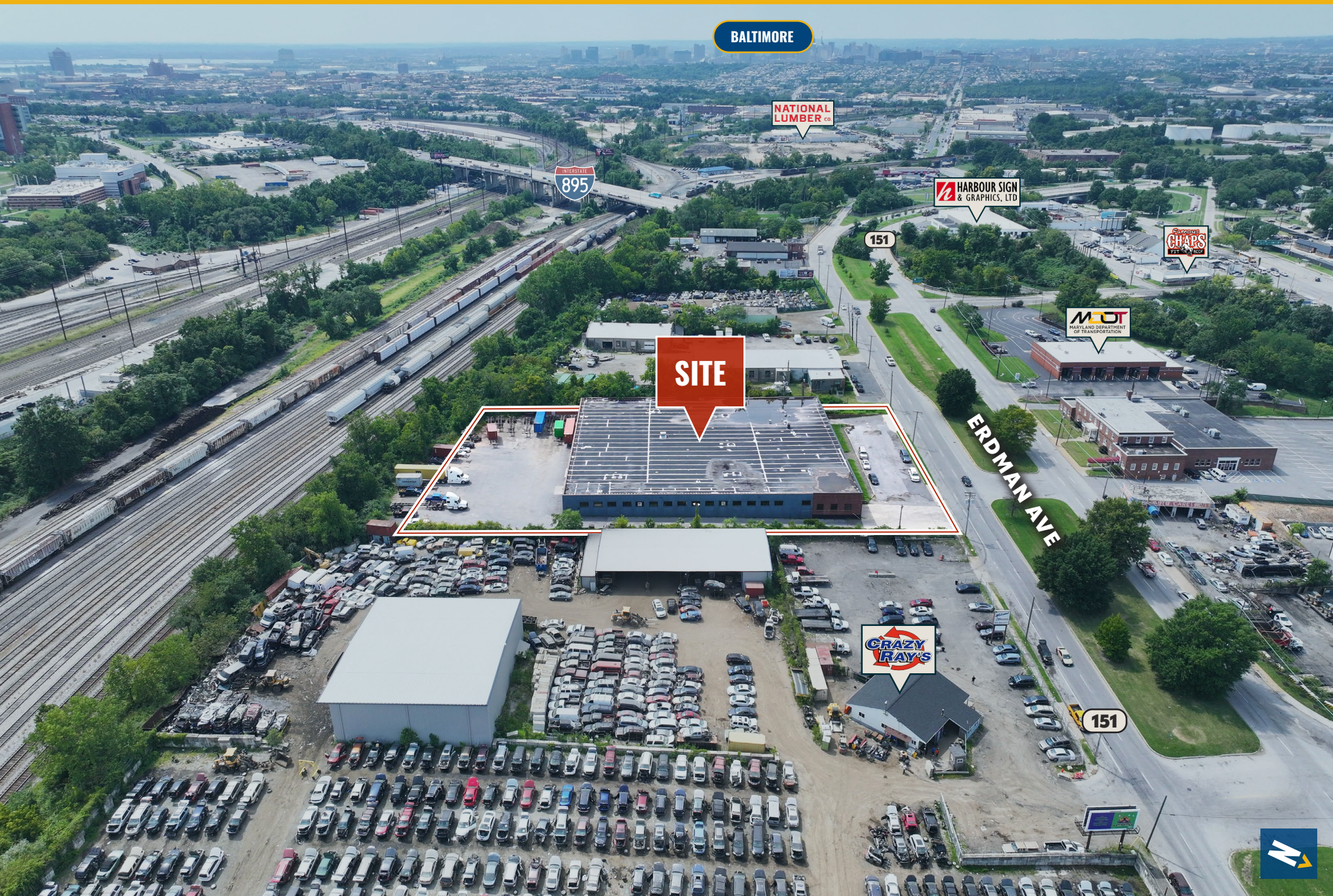

BALTIMORE

NATIONAL LUMBER CO.

INTERSTATE 895

HARBOUR SIGN & GRAPHICS, LTD.

151

CRAZY RAY'S

SITE

MDOT
MARYLAND DEPARTMENT OF TRANSPORTATION

ERDMAN AVE

CRAZY RAY'S

151



FOR MORE INFO CONTACT:



ANDREW MEEDER, SIOR

SENIOR VICE PRESIDENT & PRINCIPAL

410.494.4881

AMEEDER@mackenziecommercial.com



MATTHEW CURRAN, SIOR

SENIOR VICE PRESIDENT & PRINCIPAL

443.573.3203

MCURRAN@mackenziecommercial.com



DANIEL HUDAK, SIOR

SENIOR VICE PRESIDENT & PRINCIPAL

443.573.3205

DHUDAK@mackenziecommercial.com



KETCH SECOR

SENIOR VICE PRESIDENT

410.409.0990

KSECOR@mackenziecommercial.com

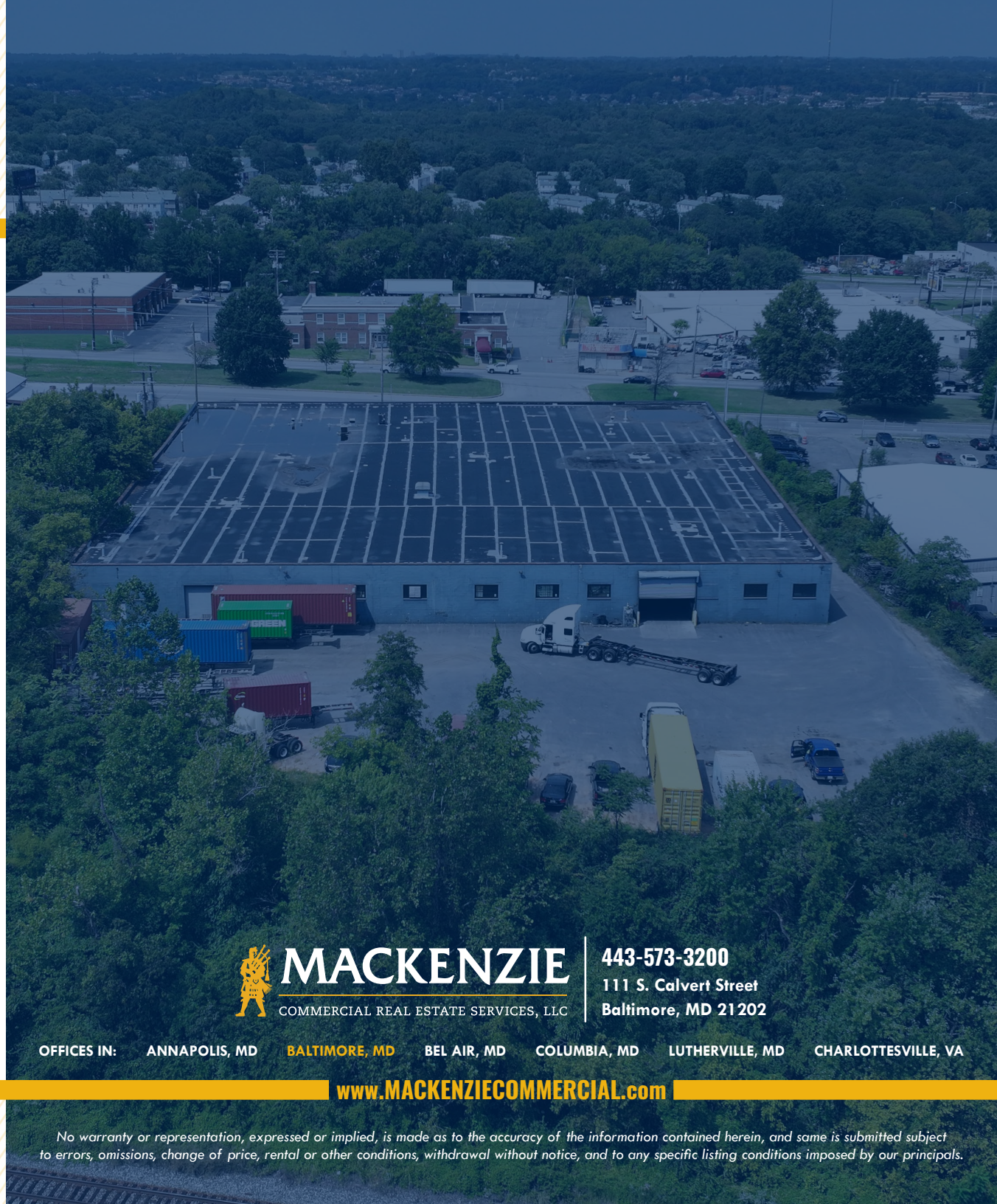

MACKENZIE

COMMERCIAL REAL ESTATE SERVICES, LLC

443-573-3200

111 S. Calvert Street
Baltimore, MD 21202

OFFICES IN: ANNAPOLIS, MD **BALTIMORE, MD** BEL AIR, MD COLUMBIA, MD LUTHERVILLE, MD CHARLOTTESVILLE, VA

www.MACKENZIECOMMERCIAL.com



VISIT **PROPERTY PAGE** FOR MORE INFORMATION

No warranty or representation, expressed or implied, is made as to the accuracy of the information contained herein, and same is submitted subject to errors, omissions, change of price, rental or other conditions, withdrawal without notice, and to any specific listing conditions imposed by our principals.