

WAREHOUSE SPACE FOR LEASE



18,250 SF - 48,350 SF HIGH BAY WAREHOUSE

4 Energy Way, West Warwick, RI 02893

GEORGE PASKALIS, SIOR

Partner
401.751.3200 x3303
george@mgcommercial.com

JULIE FRESHMAN, SIOR

Vice President
401.751.3200 x3309
julie@mgcommercial.com

MG COMMERCIAL

365 Eddy Street, Penthouse Suite
Providence, RI 02903
401.751.3200 | mgcommercial.com

PROPERTY SUMMARY



PROPERTY DESCRIPTION

The subject building consists of 82,000 square feet +/- of total space, including approximately 8,000 square feet of highly functional mezzanine space and is situated on approximately 7.5 acres of land. The building is subdivided into 4 units, each with its own separate meters. The subject space comes with ample truck circulation and offers multiple docks.

PROPERTY HIGHLIGHTS

- 18,250 SF - 48,350 SF High Bay Warehouse Space
- 14 Loading Docks
- 29' Clear Ceiling Height
- Close to I-95 On/Off Ramps at Exit 24

LOCATION DESCRIPTION

Well located in the West Warwick Business Park, with convenient truck access in and out of the park on James P Murphy Highway and easily accessible to I-95 at Exit 24. The industrial park is well established and includes two hotels immediately within the business park. T.F. Green Airport is 8.5 miles away and Downtown Providence is 30 minutes away.

OFFERING SUMMARY

Lease Rate:	\$7.95 SF/yr (NNN)
Available SF:	18,250 - 48,350 SF
Lot Size:	7.8 Acres
Building Size:	82,000 SF +/-

GEORGE PASKALIS, SIOR
Partner
401.751.3200 x3303
george@mgcommercial.com

JULIE FRESHMAN, SIOR
Vice President
401.751.3200 x3309
julie@mgcommercial.com

365 Eddy Street, Penthouse Suite
Providence, RI 02903
mgcommercial.com



BUILDING/SPACE SPECIFICATIONS

BUILDING/SPACE INFORMATION

Total Building Size:	82,000 SF +/-	Ceiling Height:	29' Clear
Available Space:	18,250 SF - 48,350 SF	Column Spacing:	50' x 30'
Warehouse:	18,250 SF - 41,950 SF	Loading Docks:	14
Mezzanine:	4,800 SF	Fire Safety System:	Dry Sprinkler System
1st Floor Office:	850 SF	Roof:	Rubber Membrane
2nd Floor Office:	750 SF	Lighting:	Motion Sensors
Land Area:	7.8 Acres	Floor:	Concrete
Construction:	Insulated Metal & Steel	Zoning:	BP (Business Park)



GEORGE PASKALIS, SIOR
Partner
401.751.3200 x3303
george@mgcommercial.com

JULIE FRESHMAN, SIOR
Vice President
401.751.3200 x3309
julie@mgcommercial.com

365 Eddy Street, Penthouse Suite
Providence, RI 02903
mgcommercial.com



18,250 SF - 48,350 SF HIGH BAY WAREHOUSE

4 Energy Way, West Warwick, RI 02893

WAREHOUSE SPACE FOR LEASE

ADDITIONAL PHOTOS



GEORGE PASKALIS, SIOR
Partner
401.751.3200 x3303
george@mgcommercial.com

JULIE FRESHMAN, SIOR
Vice President
401.751.3200 x3309
julie@mgcommercial.com

365 Eddy Street, Penthouse Suite
Providence, RI 02903
mgcommercial.com



This information has been secured from sources we believe to be reliable, but we make no representation or warranties, expressed or implied, as to the accuracy of the information. All references to age, sq. footage, income, and expenses are approximate. Buyers should conduct their own independent investigations and rely only on those results.

FLOOR PLANS

TOTAL VACANCY = 48,350 SF

- 41,950 SF of Warehouse Space
 - 29' Clear
 - 13 Loading Docks

- 4,800 SF Mezzanine

- 1600 SF Office

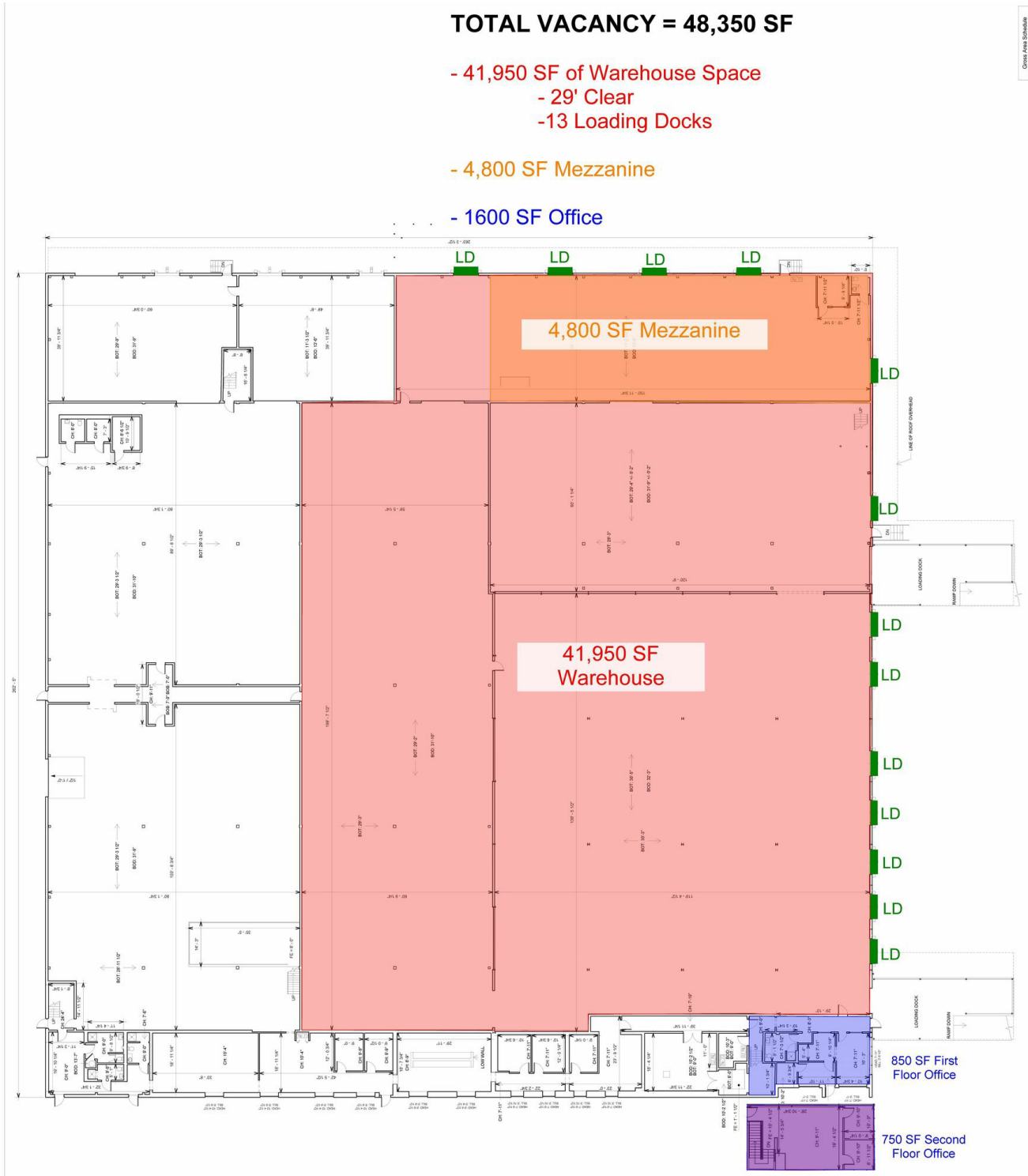

GEORGE PASKALIS, SIOR
 Partner
 401.751.3200 x3303
 george@mgcommercial.com

JULIE FRESHMAN, SIOR
 Vice President
 401.751.3200 x3309
 julie@mgcommercial.com

365 Eddy Street, Penthouse Suite
 Providence, RI 02903
 mgcommercial.com



FLOOR PLANS

Subdivision #1 = 30,100 SF

- 23,700 SF of Warehouse Space
- 29' Clear
- 8 Loading Docks

- 4,800 SF Mezzanine

- 1,600 SF Office

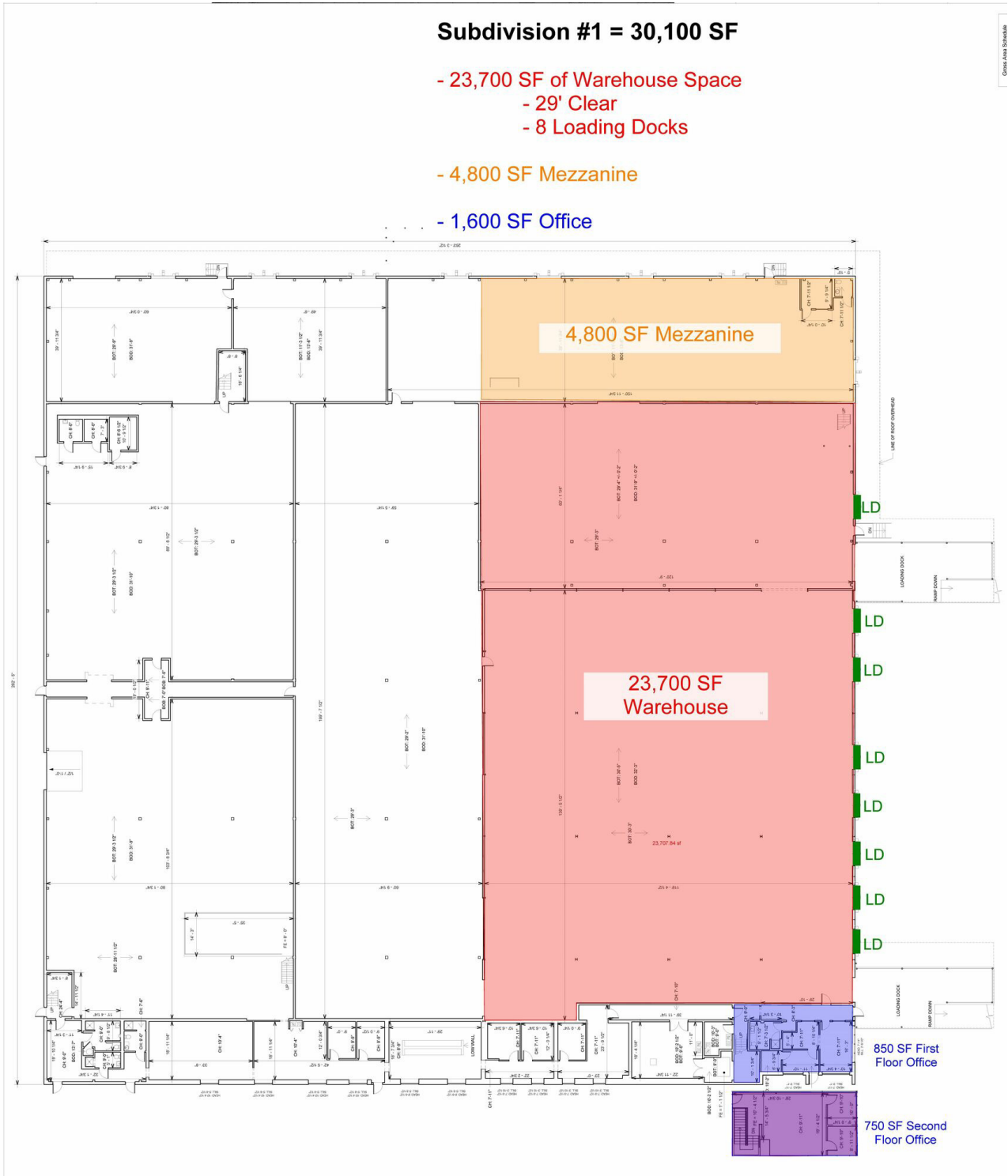

GEORGE PASKALIS, SIOR
 Partner
 401.751.3200 x3303
 george@mgcommercial.com

JULIE FRESHMAN, SIOR
 Vice President
 401.751.3200 x3309
 julie@mgcommercial.com

365 Eddy Street, Penthouse Suite
 Providence, RI 02903
 mgcommercial.com



FLOOR PLANS

Subdivision #2 = 18,250 SF

- 18,250 SF of Warehouse Space
- 5 Loading Docks

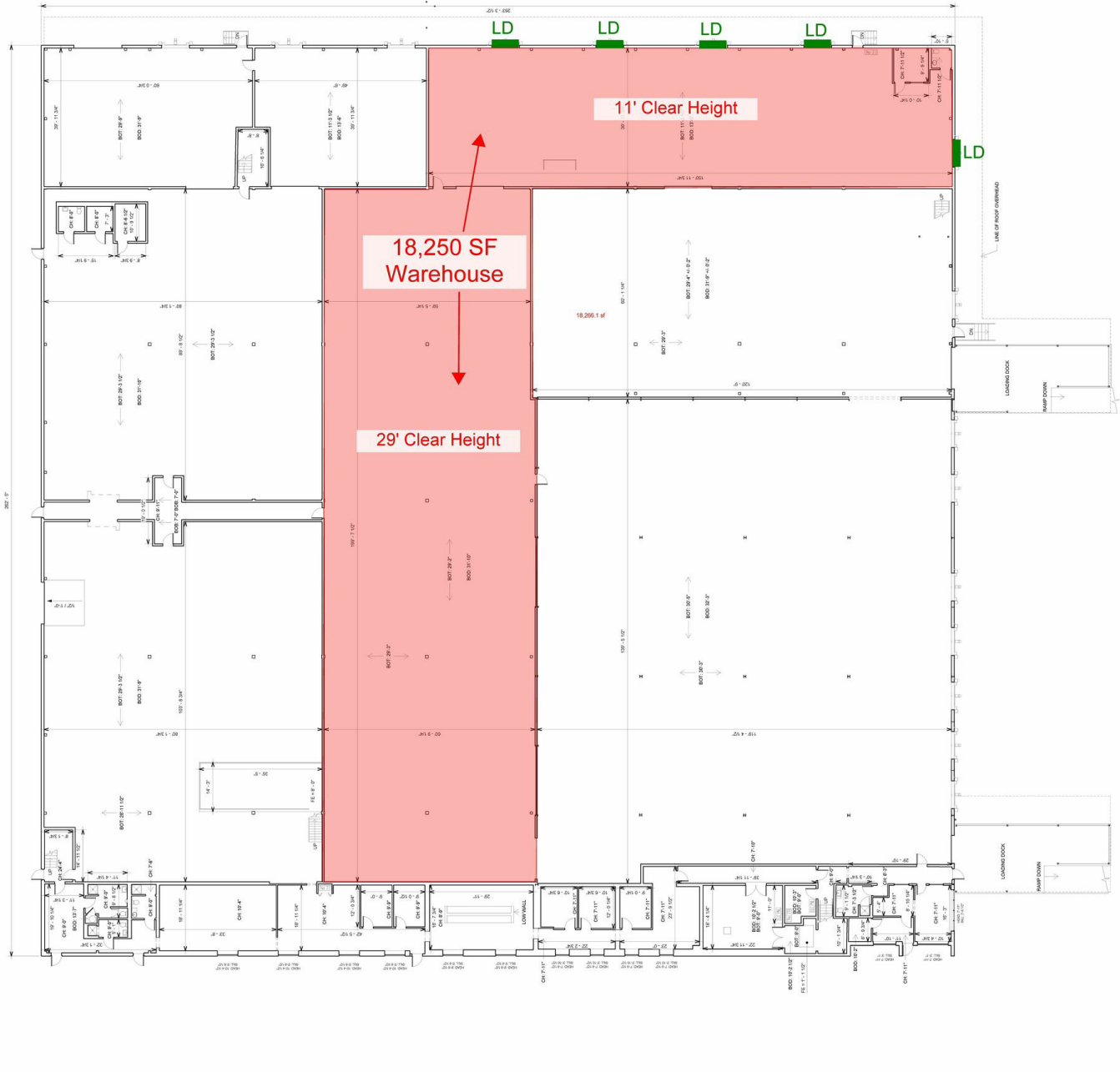

1 Existing Level 1 Floor Plan

GEORGE PASKALIS, SIOR
 Partner
 401.751.3200 x3303
 george@mgcommercial.com

JULIE FRESHMAN, SIOR
 Vice President
 401.751.3200 x3309
 julie@mgcommercial.com

365 Eddy Street, Penthouse Suite
 Providence, RI 02903
 mgcommercial.com



18,250 SF - 48,350 SF HIGH BAY WAREHOUSE

4 Energy Way, West Warwick, RI 02893

WAREHOUSE SPACE FOR LEASE

AERIAL MAP



GEORGE PASKALIS, SIOR
Partner
401.751.3200 x3303
george@mgcommercial.com

JULIE FRESHMAN, SIOR
Vice President
401.751.3200 x3309
julie@mgcommercial.com

365 Eddy Street, Penthouse Suite
Providence, RI 02903
mgcommercial.com



This information has been secured from sources we believe to be reliable, but we make no representation or warranties, expressed or implied, as to the accuracy of the information. All references to age, sq. footage, income, and expenses are approximate. Buyers should conduct their own independent investigations and rely only on those results.