

FOR LEASE //////////////// New Building

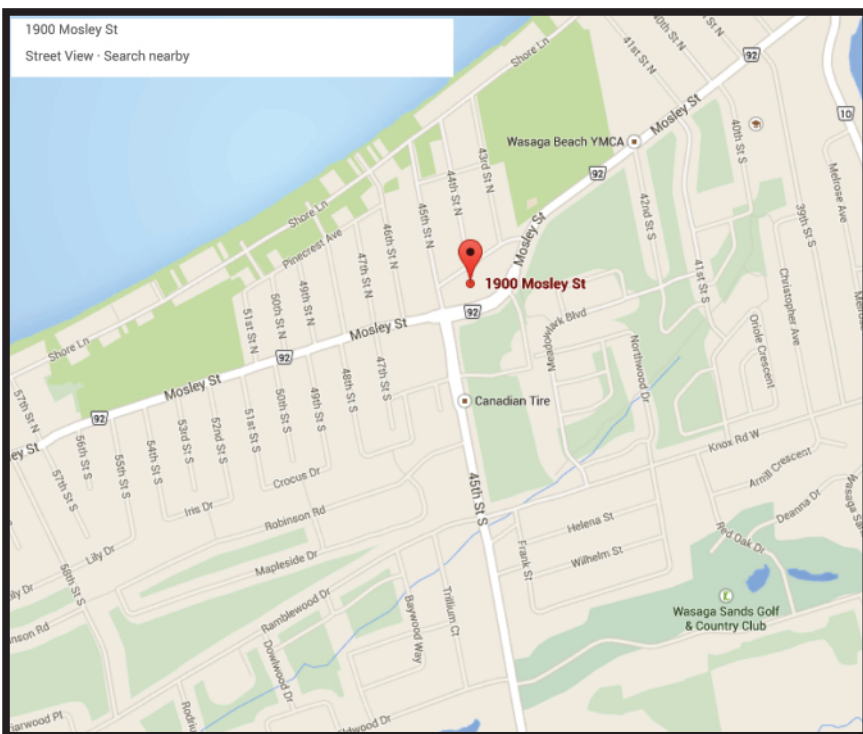

Building Details

Total Building Area:
8,000 Sq. Ft.

Comments:

Great Corner Exposure
on busy street.

Ample Parking
with Approx 36 Spots

Can be divided to suit.
Unit sizes from 1150 Sq. Ft.

Suitable for many Retail
& Commercial uses.

Neighbouring plaza with
LCBO, Shoppers Drug Mart
& Tim Hortons

Asking price: \$22 net PSF
Estimated TMI: \$8 PSF

For more information

please contact:

Jason Karametch
Broker
(416) 729-2899
jk@mfsrealty.com



REALTY SERVICES INC.
BROKERAGE

8920 Woodbine Ave. Suite 403
Markham, Ontario L3R 9W9

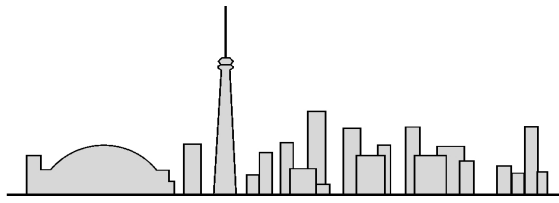

Tel: (905) 940-0073
Fax: (905) 940-0079

The information contained herein has been given to us by the owner of the property or other sources we deem reliable.

We have no reason to doubt its accuracy, but we do not guarantee it.

All information should be verified prior to purchase or lease. MFS Realty Services Inc.



1890 Mosley Tenant Areas

1/16" = 1'-0" Imperial Plan

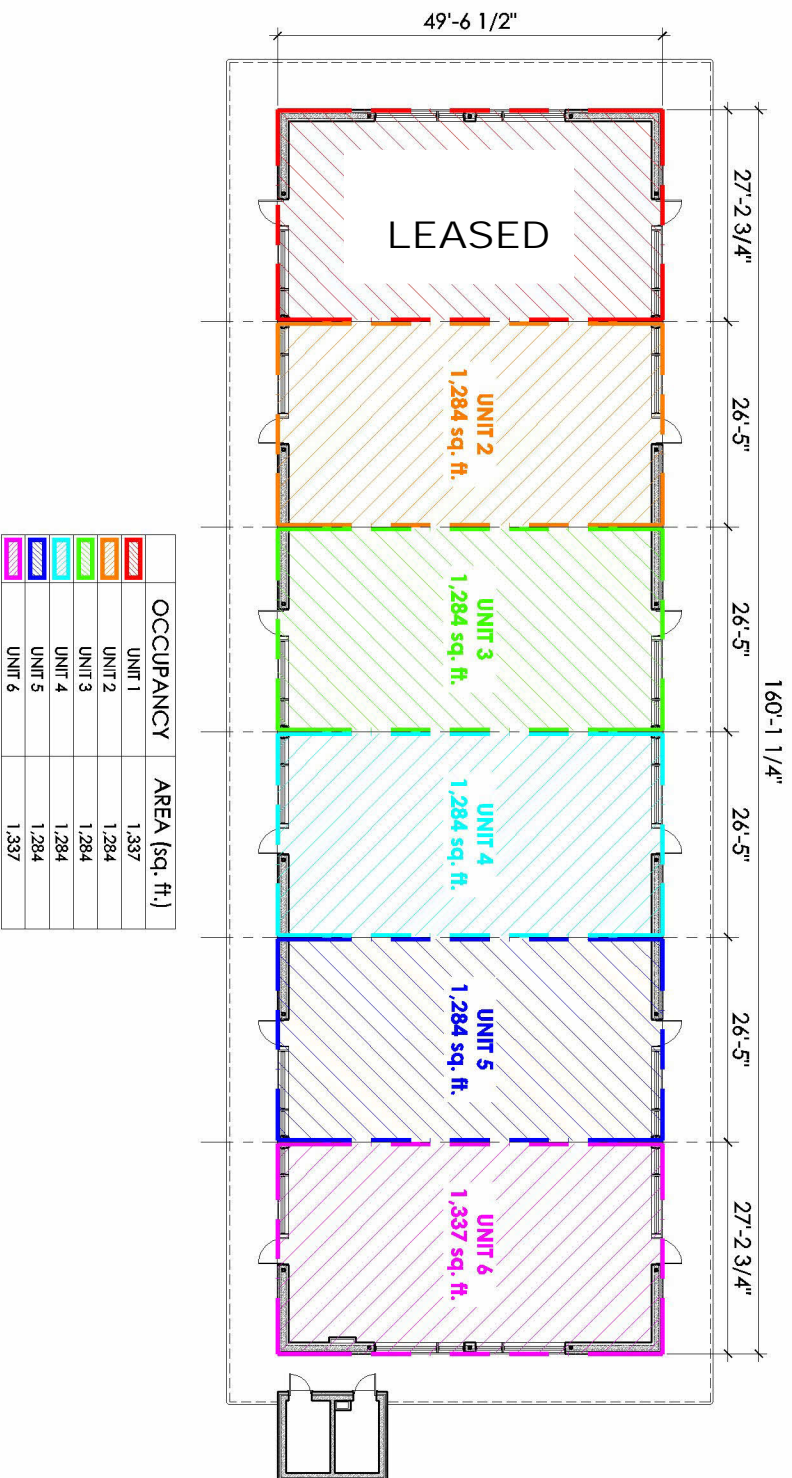

1890 Mosley Tenant Areas

1/8" = 1'-0" Imperial Plan

160'-1 1/4"

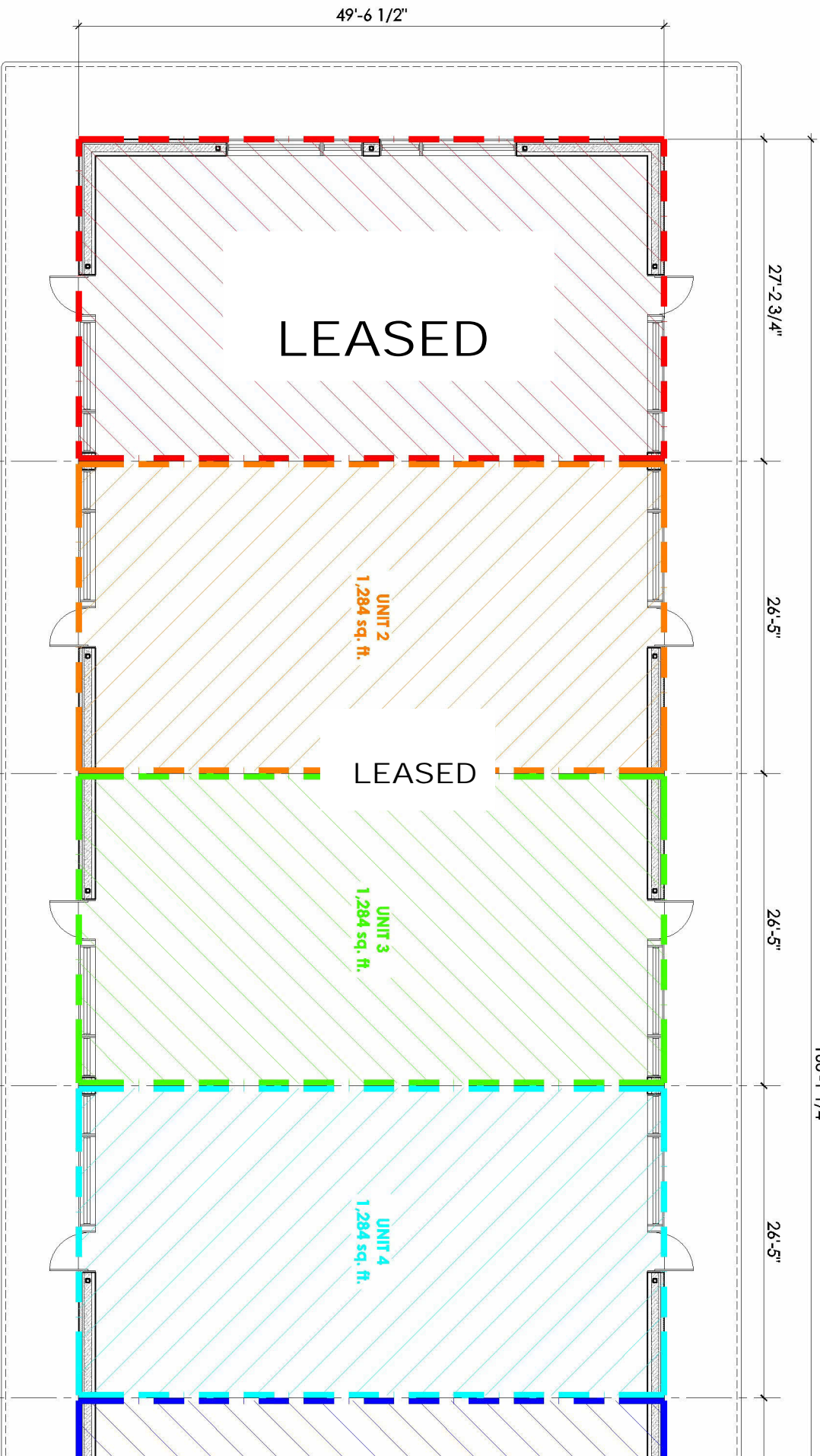

1890 Mosley Tenant Areas

1/8" = 1'-0" Imperial Plan

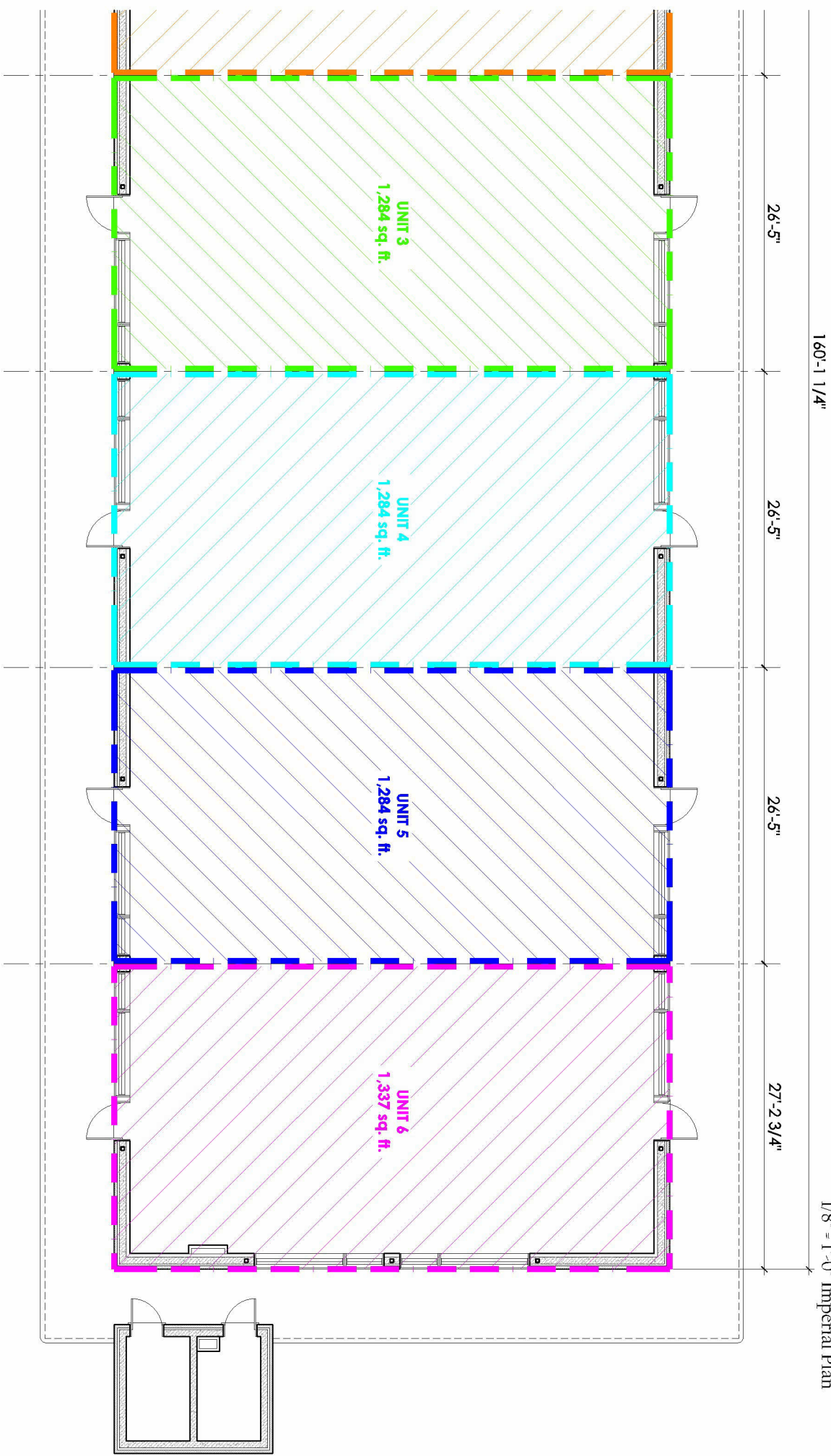

Nottawasaga Bay

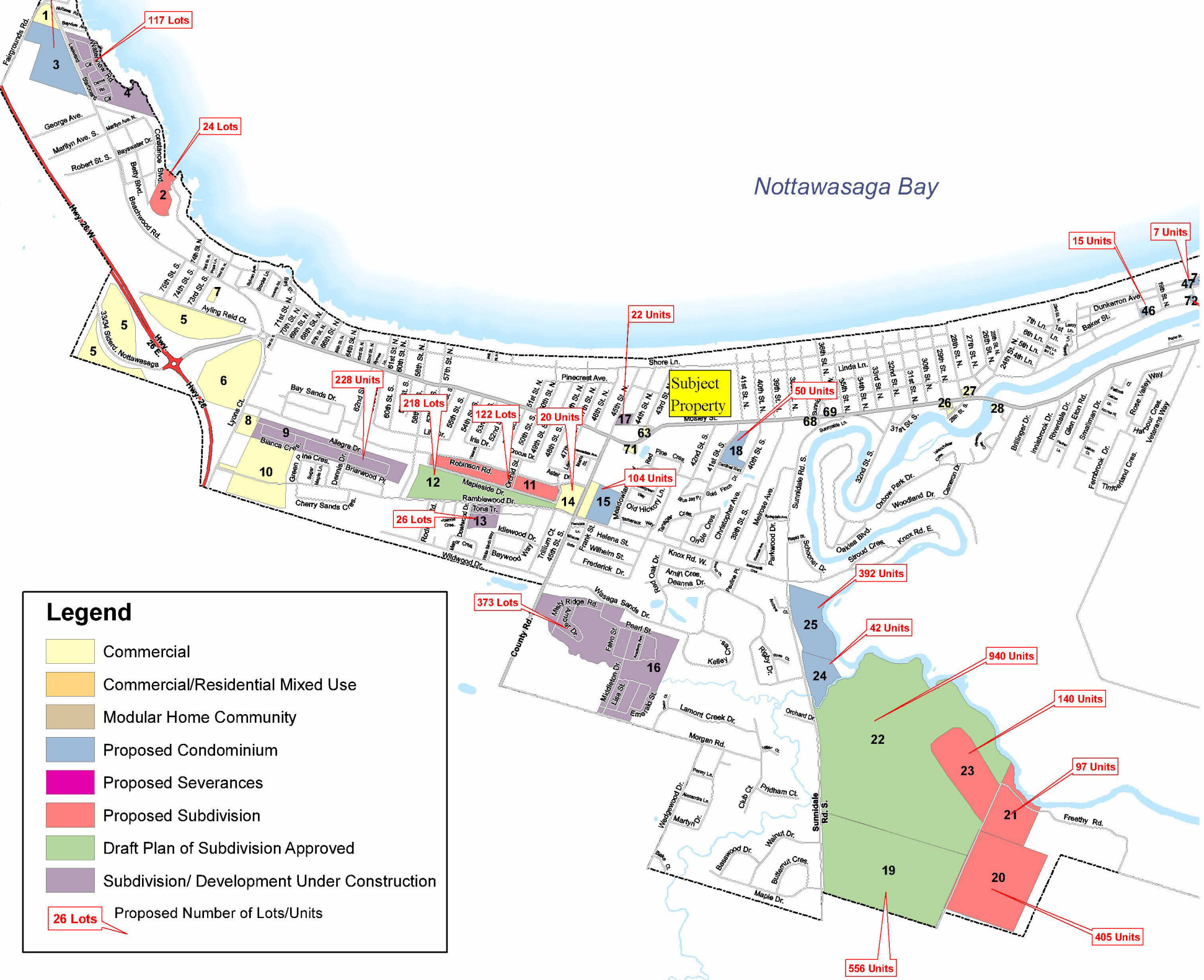

Legend

- Commercial
- Commercial/Residential Mixed Use
- Modular Home Community
- Proposed Condominium
- Proposed Severances
- Proposed Subdivision
- Draft Plan of Subdivision Approved
- Subdivision/ Development Under Construction

26 Lots Proposed Number of Lots/Units