



FLEX/OFFICE/RETAIL FOR LEASE

# THE PARK AT WILLOW RIDGE - BLDG. E

12328 134TH COURT NE, REDMOND, WA 98052



## BUILDING E | 11,252 SF

SUITE 12310/12328: 11,252 SF (5,539 SF OFFICE/5,713 SF WH)

SUITE 12310 5,491 SF (3,602 SF OFFICE/ 1,889 SF WH)

SUITE 12328 5,761 SF (2,111 SF OFFICE/ 3,650 SF WH)

## AVAILABLE NOW

## AMENITIES

- Grade level loading doors
- 3 parking stalls per 1,000 SF
- Quick access to I-405, Willows Road, the Village at Totem Lake retail, Woodinville wine country with close proximity to Kirkland, Redmond & Bellevue with views of Mt. Rainier and the Cascade Mountains
- Well established hub for technology, aerospace, & innovation and an ideal destination for a variety of tenants

# BUILDING E

**TOTAL AVAILABLE  
11,252 SF**

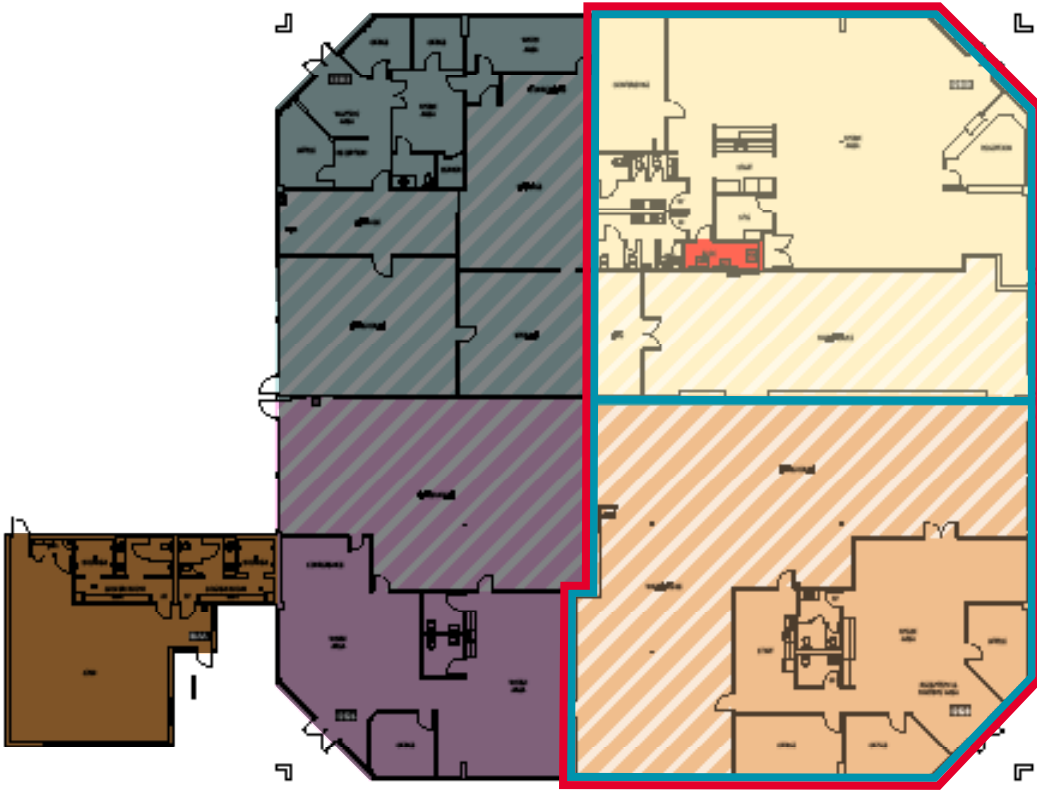

**SUITE 12310  
AVAILABLE  
5,491 SF**

**SUITE 12328  
AVAILABLE  
5,761 SF**



**BUILDING E  
11,252 SF  
Available Space**

**Suite 12328  
AVAILABLE  
5,761 SF**

**Suite 12310  
AVAILABLE  
5,491 SF**

## FOR MORE INFORMATION PLEASE CONTACT:

**Jim Reed, DUAL SIOR**  
Executive Managing Director  
+1 206 215 9815  
jim.reed@cushwake.com

**Carson Scott**  
Senior Associate  
+1 425 736 3752  
carson.scott@cushwake.com

11235 SE 6th Street Suite 140 | Bellevue, WA 98004 | +1 425 455 4500

