

**SAN LUIS PLAZA**  
**911 - 963 W PACHECO BLVD**  
**1435 - 1451 WEST I STREET**  
**LOS BANOS, CA**  
FOR LEASE  
776 SF - 23,628 SF RETAIL SUITES

**ETHAN CONRAD**  
PROPERTIES INC.



**MAJOR REMODEL COMPLETE**

FOR MORE INFORMATION CONTACT:

**Ravjeet Basi**  
DRE: #02087094  
basi@ethanconradprop.com

**Ethan Conrad**  
DRE: #01298662  
ethan@ethanconradprop.com

**916.779.1000**

ETHAN CONRAD PROPERTIES, INC  
1300 NATIONAL DRIVE, SUITE 100 | SACRAMENTO CA, 95834 | 916.779.1000  
www.ethanconradprop.com

**FEATURES:**

- 23,628 SF bowling/entertainment space
- Located in the main traffic and retail corridor of Los Banos
- Situated on the new side of the trade area with other major traffic generators including Walmart and Target
- Close proximity to Los Banos Municipal Airport and Merced College, Los Banos Campus
- Dense Hispanic population - 68% within 10 miles

**PROPERTY DETAILS:**

San Luis Plaza is a ±151,514 SF retail center anchored by La Esperanza located on State Hwy 152/33, one of the heaviest traveled routes between the Central Valley and Central Coast. Hwy 152 also serves as a popular lateral connection to major North/South CA routes including Highways 99, 101 and I-5. The center is home to national tenants including: Black Bear Diner, and Wienerschnitzel.

Neighboring retailers include: Walmart, Target, Tractor Supply, Petco, McDonald's and Starbucks.



**LEASE RATES:**

923	23,628 SF	\$29,535.00 (\$1.25 PSF, NNN)
947B*	776 SF	1,552.00 (\$2.00 PSF, NNN)

NNN costs are approximately \$0.22 PSF.

\*Available with 30 days' notice.

**DEMOGRAPHICS:**

	<b>1 Mile</b>	<b>3 Mile</b>	<b>5 Mile</b>
2023 Total Population (est):	11,188	46,716	50,711
2023 Average HH Income:	\$86,418	\$84,293	\$83,878
Traffic Count @ W Pacheco Blvd:		51,000	

**ETHAN CONRAD PROPERTIES, INC.**

1300 NATIONAL DRIVE, SUITE 100 | SACRAMENTO CA, 95834 | 916.779.1000

www.ethanconradprop.com

The information contained herein has been obtained from sources we believe to be reliable. However, we cannot guarantee, warrant or represent its accuracy and all information is subject to error, change or withdrawal. An interested party and their advisors should conduct an independent investigation of the property to determine to your satisfaction the suitability of the property for your needs.

FLOOR PLAN  
923 W PACHECO BLVD

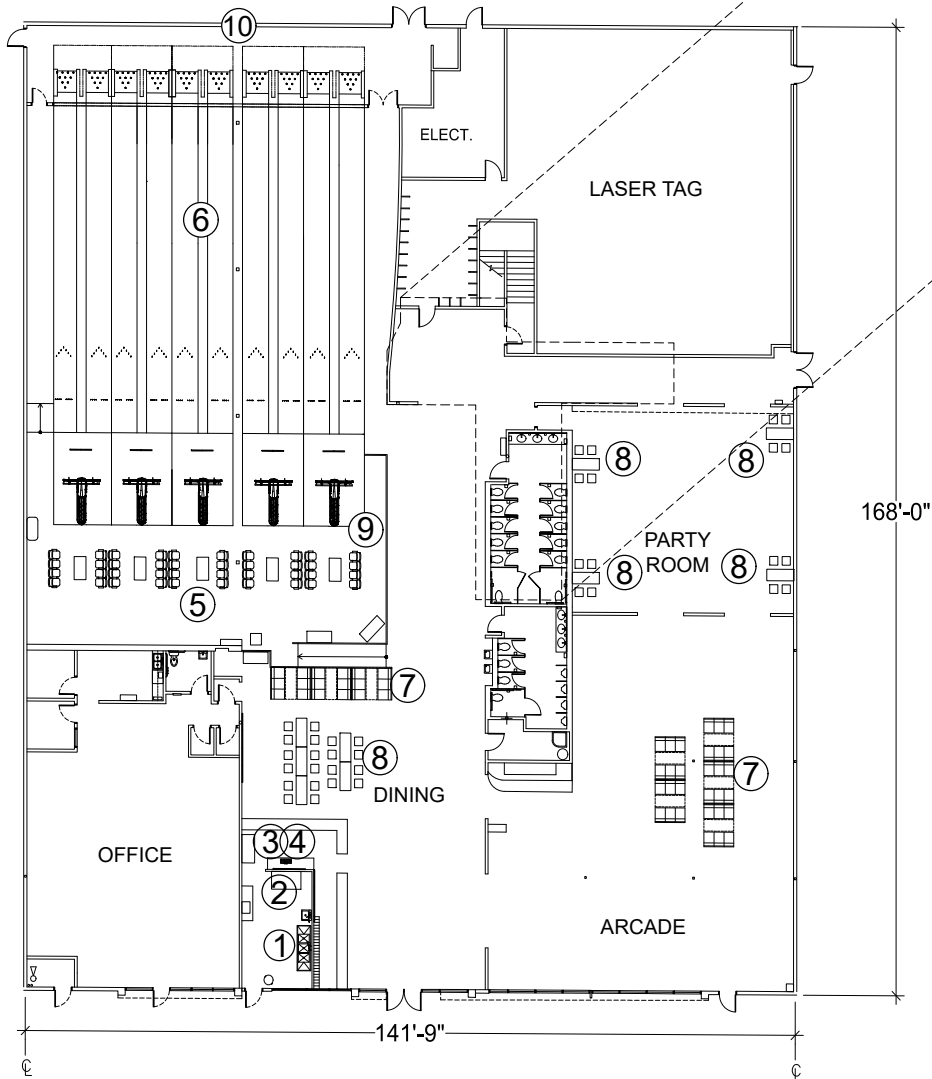

FFE List			
Attached		Non Attached	
1	3-Basin Sink	7	Booth
2	Hand Sink	8	High Top Table/Chairs
3	Draft Beer System		
4	Draft Beer Cooler/Taps		
5	Stadium Seats		
6	10-Bowling Lanes		
9	5-Bowling Ball Machines		
10	10-Sets of Pins		

FLOOR PLAN

**AVAILABLE**  
**947B\***  
**776 SF**

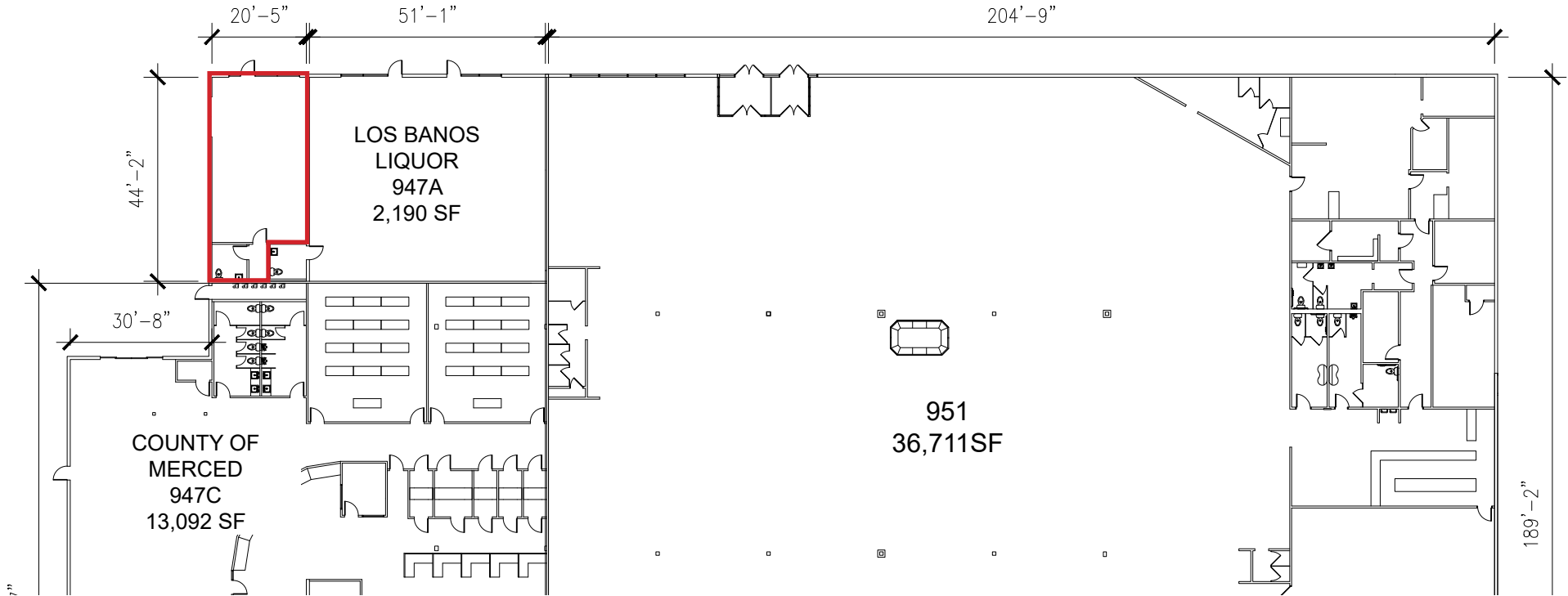

Suite	SF	Lease Rate	Monthly Rent
947B*	776	\$2.00 PSF, NNN	\$1,552.00
NNN costs are approximately \$0.22 PSF. *Available with 30 days' notice.			

**ETHAN CONRAD PROPERTIES, INC.**

1300 NATIONAL DRIVE, SUITE 100 | SACRAMENTO CA, 95834 | 916.779.1000

[www.ethanconradprop.com](http://www.ethanconradprop.com)

The information contained herein has been obtained from sources we believe to be reliable. However, we cannot guarantee, warrant or represent its accuracy and all information is subject to error, change or withdrawal. An interested party and their advisors should conduct an independent investigation of the property to determine to your satisfaction the suitability of the property for your needs.

FOR LEASE

**SAN LUIS PLAZA**  
911-963 W PACHECO BLVD & 1435-1451 W I STREET  
LOS BANOS, CA

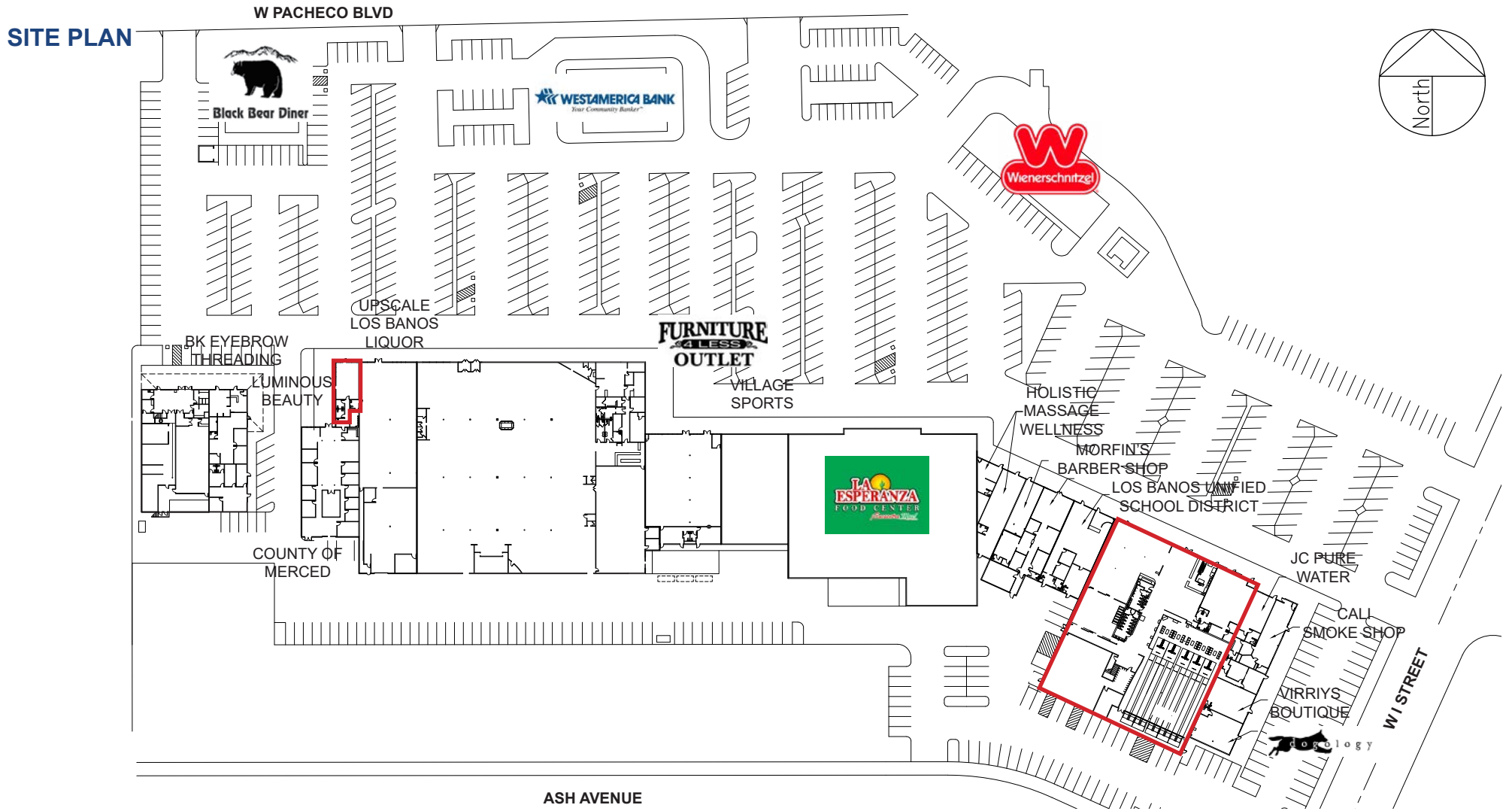

**ETHAN CONRAD PROPERTIES, INC.**

1300 NATIONAL DRIVE, SUITE 100 | SACRAMENTO CA, 95834 | 916.779.1000

[www.ethanconradprop.com](http://www.ethanconradprop.com)

The information contained herein has been obtained from sources we believe to be reliable. However, we cannot guarantee, warrant or represent its accuracy and all information is subject to error, change or withdrawal. An interested party and their advisors should conduct an independent investigation of the property to determine to your satisfaction the suitability of the property for your needs.

FOR LEASE

SAN LUIS PLAZA  
911-963 W PACHECO BLVD & 1435-1451 W I STREET  
LOS BANOS, CA



ETHAN CONRAD PROPERTIES, INC.  
1300 NATIONAL DRIVE, SUITE 100 | SACRAMENTO CA, 95834 | 916.779.1000  
www.ethanconradprop.com

The information contained herein has been obtained from sources we believe to be reliable. However, we cannot guarantee, warrant or represent its accuracy and all information is subject to error, change or withdrawal. An interested party and their advisors should conduct an independent investigation of the property to determine to your satisfaction the suitability of the property for your needs.

FOR LEASE

**SAN LUIS PLAZA**  
**911-963 W PACHECO BLVD & 1435-1451 W I STREET**  
LOS BANOS, CA



The information contained herein has been obtained from sources we believe to be reliable. However, we cannot guarantee, warrant or represent its accuracy and all information is subject to error, change or withdrawal. An interested party and their advisors should conduct an independent investigation of the property to determine to your satisfaction the suitability of the property for your needs.

**ETHAN CONRAD PROPERTIES, INC.**

1300 NATIONAL DRIVE, SUITE 100 | SACRAMENTO CA, 95834 | 916.779.1000

[www.ethanconradprop.com](http://www.ethanconradprop.com)

FOR LEASE

**SAN LUIS PLAZA**  
**911-963 W PACHECO BLVD & 1435-1451 W I STREET**  
LOS BANOS, CA



**ETHAN CONRAD PROPERTIES, INC.**

1300 NATIONAL DRIVE, SUITE 100 | SACRAMENTO CA, 95834 | 916.779.1000

[www.ethanconradprop.com](http://www.ethanconradprop.com)

The information contained herein has been obtained from sources we believe to be reliable. However, we cannot guarantee, warrant or represent its accuracy and all information is subject to error, change or withdrawal. An interested party and their advisors should conduct an independent investigation of the property to determine to your satisfaction the suitability of the property for your needs.