

# FOR LEASE

## 20819 N 25TH PL

UNIT 107B, PHOENIX, AZ 85050



**ZACH OLIVET**  
Vice President

602.885.5583  
[zolivet@novodevelops.com](mailto:zolivet@novodevelops.com)

# OFFERING



## PROPERTY DETAILS

Property Type	Flex/Industrial
Lease Rate	\$1.45/SF NNN
Lot size	2,407 SF
Available SF	+/- 2,300 SF
Zoning	CP/GCP City of Phoenix
Parcel No	213-11-151

## PROPERTY HIGHLIGHTS

- Year Built: 2005
- Easy access off Cave Creek & 101 Hwy
- Potential Building Signage
- End Cap Unit
- 30% Office | 70% Warehouse
- Evap Cooled Warehouse
- 18' Clear Height
- Sprinklered
- 12'x14' Grade Level Roll up Door
- Sky Lights
- 200 amps 120/208v 3 Phase Power
- Renovated Restroom (April of 2024)
- Roof Replacement Scheduled



# PROPERTY PHOTOS

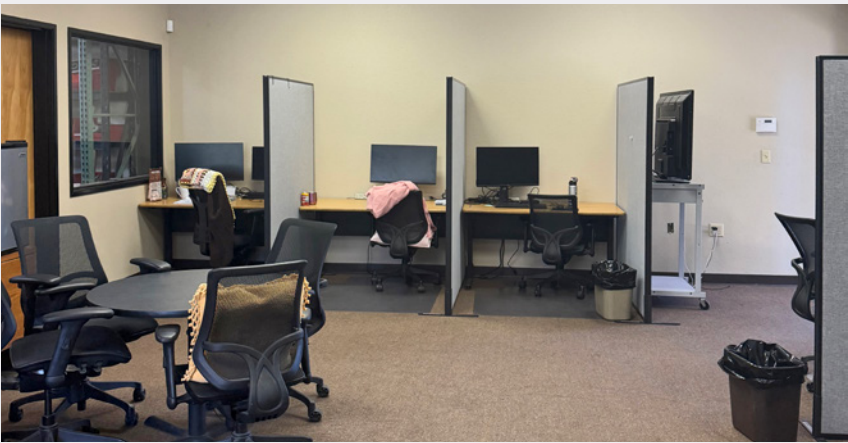

# FLOOR/SITE PLAN

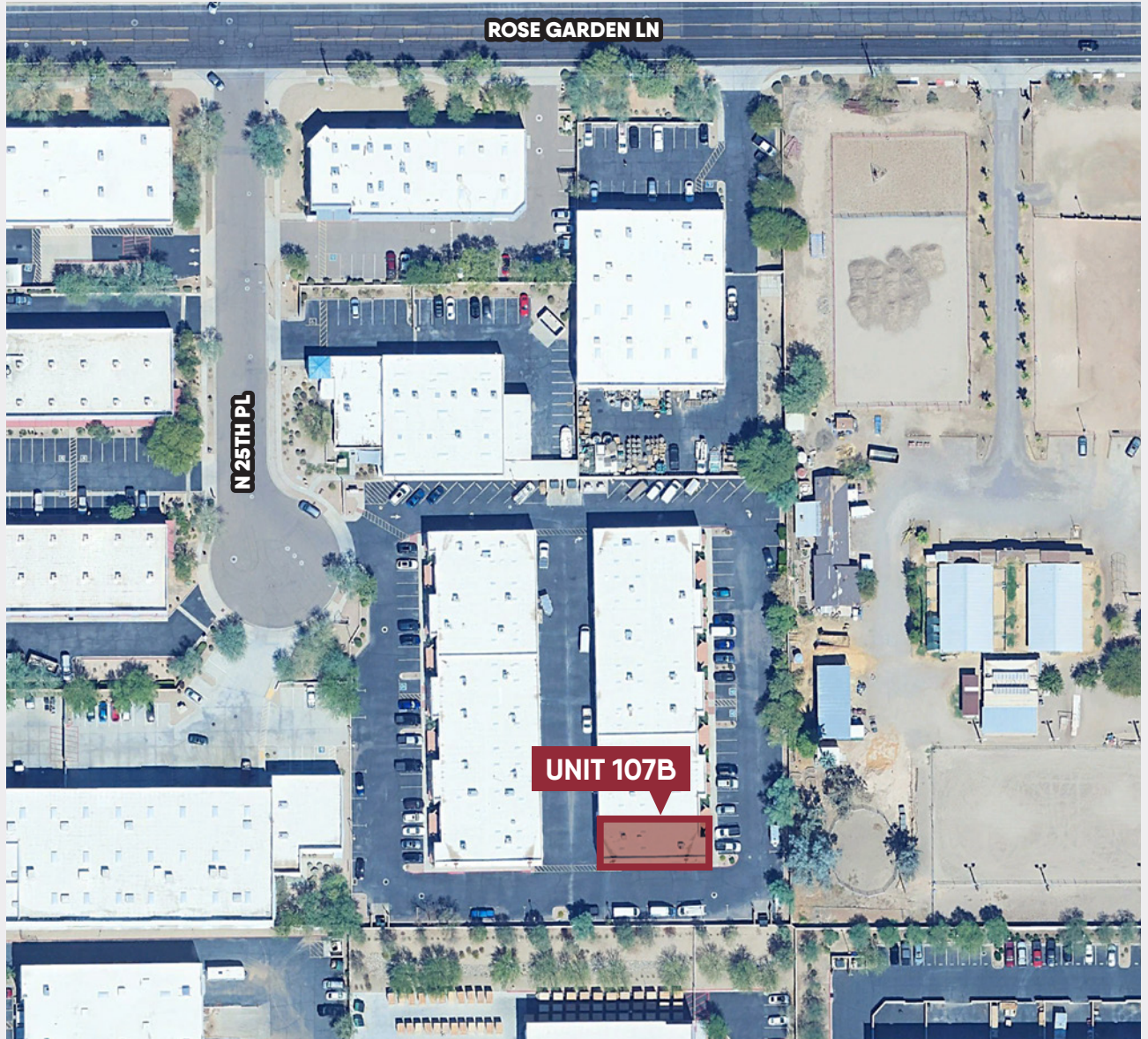
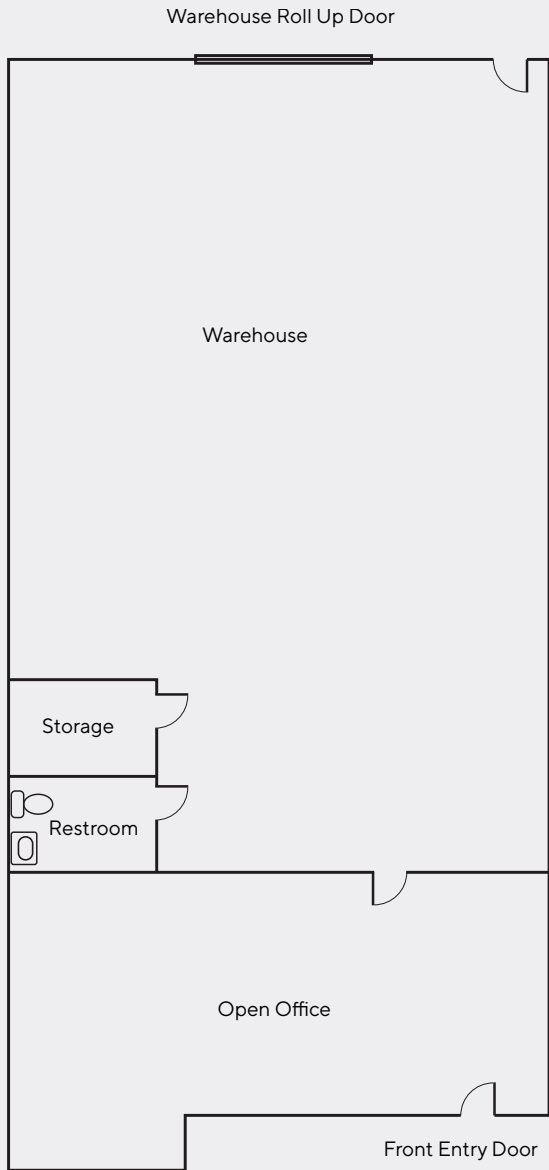

# LOCATION



## ZACH OLIVET

Vice President

602.885.5583

[zolivet@novodevelops.com](mailto:zolivet@novodevelops.com)

[novodevelops.com](http://novodevelops.com)

This information has been secured from sources believed to be reliable, but no presentations or warranties are made, expressed or implied, as to the accuracy of the information. References to the square footage are approximate. Buyer and tenant must verify the information and bears all risk for any inaccuracies. All quoted prices are subject to change without notice.